

LEGEND

[Symbol]	[Description]
[Symbol]	[Description]
[Symbol]	[Description]
[Symbol]	[Description]
[Symbol]	[Description]
[Symbol]	[Description]
[Symbol]	[Description]
[Symbol]	[Description]
[Symbol]	[Description]
[Symbol]	[Description]
[Symbol]	[Description]
[Symbol]	[Description]
[Symbol]	[Description]
[Symbol]	[Description]
[Symbol]	[Description]
[Symbol]	[Description]
[Symbol]	[Description]
[Symbol]	[Description]
[Symbol]	[Description]
[Symbol]	[Description]
[Symbol]	[Description]
[Symbol]	[Description]
[Symbol]	[Description]
[Symbol]	[Description]
[Symbol]	[Description]

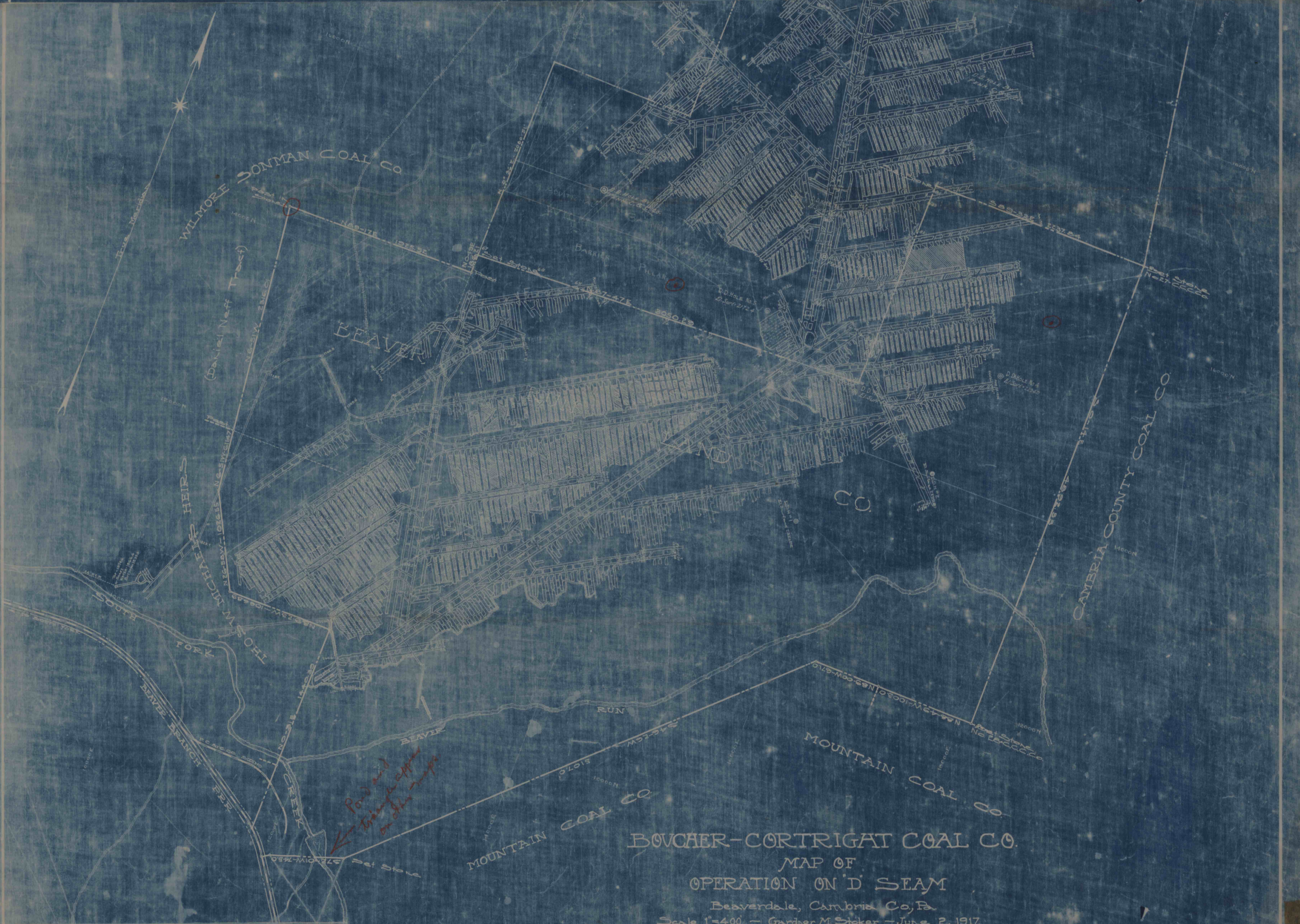

WILMORE SONMAN COAL CO

BEAVER

CO

CAMBERIA COUNTY COAL CO

MOUNTAIN COAL CO

BOUCAER-CORTRIGAT COAL CO.

MAP OF OPERATION ON 'D' SEAM

Beaverdale, Cambria Co, Pa.

Scale 1"=400 - Gardner M. Sticker - June 2, 1917.

Mining Engineer

Johnstown, Pa.

Red handwritten note:
 P. 10.5 and
 10.5 and
 10.5 and
 10.5 and
 10.5 and

LEGEND

[Symbol]	[Description]
[Symbol]	[Description]
[Symbol]	[Description]
[Symbol]	[Description]
[Symbol]	[Description]
[Symbol]	[Description]
[Symbol]	[Description]
[Symbol]	[Description]
[Symbol]	[Description]
[Symbol]	[Description]
[Symbol]	[Description]
[Symbol]	[Description]
[Symbol]	[Description]
[Symbol]	[Description]
[Symbol]	[Description]
[Symbol]	[Description]
[Symbol]	[Description]
[Symbol]	[Description]
[Symbol]	[Description]
[Symbol]	[Description]
[Symbol]	[Description]
[Symbol]	[Description]
[Symbol]	[Description]
[Symbol]	[Description]
[Symbol]	[Description]

Handwritten numbers and markings: #658, 3079, etc.

CH-174