

INDEX TO SURVEYS.

LETTER	DATE
A	Prior to Jan. 1, 1918.
B	Jan. 1, 1918.
D	Jan. 1, 1919.
G	Jan. 1, 1920.

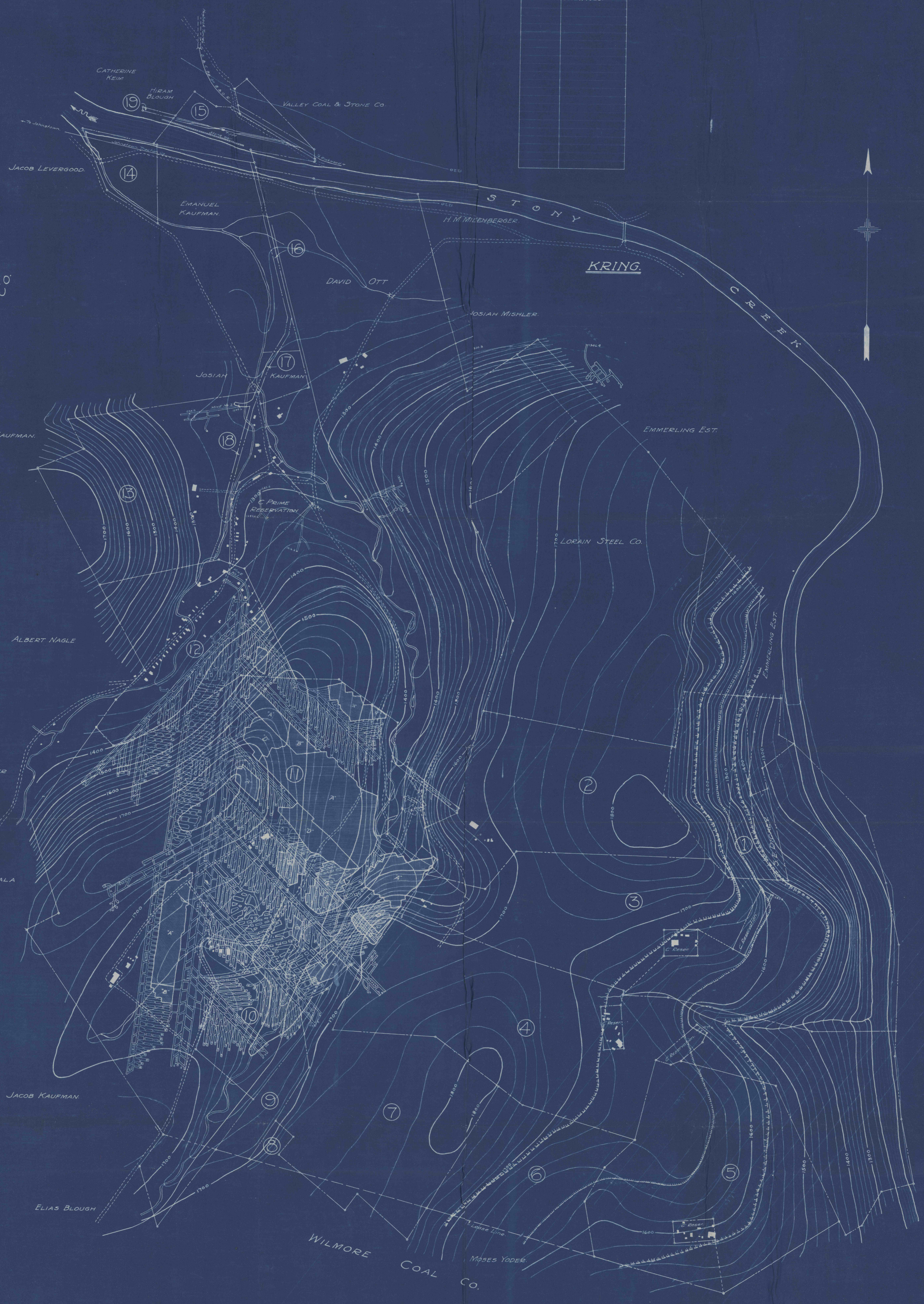

NO.	NAME OF TRACT.
1	ISAAC KAUFMAN.
2	JOSEPH RISCH.
3	LEWIS SHETTLER.
4	ABRAM SHETTLER.
5	JACOB ALWINE.
6	MOSES YODER.
7	JACOB HARSHBERGER.
8	JACOB I. KAUFMAN.
9	JOSEPH I. KAUFMAN.
10	L. J. FOUST.
11	JOSEPH T. YODER.
12	DAVID BERKEY.
13	JOHN KAUFMAN.
14	JOHN KAUFMAN.
15	EMANUEL BLOUGH.
16	EMANUEL KAUFMAN.
17	JOSIAH KAUFMAN.
18	JOHN KAUFMAN.
19	HIRAM BLOUGH.

**BIRD COAL CO.**  
**C PRIME MINING OPERATIONS**  
 SITUATE IN  
 CONEMAUGH TWP., SOMERSET COUNTY, PA.  
 AND  
 STONY CREEK TWP., CAMBRIA COUNTY, PA.  
 Scale 1" = 400'  
 S.E. Dickey & Co. July 2, 1920.  
 Civil and Mining Engrs.  
 Johnstown, Pa.