

ID NUMBER	SITE	SURFACE ELEVATION	BOTTOM OF COAL	SHEET NUMBER
B1	GREENLEE AIRSHAFT	1029'	861'	13
B2	RICHEYVILLE AIRSHAFT	1053'	860'	4
B3	THOMPSON AIRSHAFT	985'	803'	8
B4	HASTINGS AIRSHAFT	1047'	733'	7
B5	COMBS INTAKE AIRSHAFTS	1091'	555'	16
B6	COMBS RETURN AIRSHAFTS	1063'	555'	16
B7	ANDREWS INTAKE AIRSHAFTS	1140'	843'	17
B8	ANDREWS RETURN AIRSHAFTS	1165'	843'	17
B9	KENNEY AIRSHAFT	957'	832'	5
B10	DONAHOO AIRSHAFT	1087'	517'	15
C1	SUPPLY YARD DRIFT	845'	845'	6
C2	3 BUTT B DRIFT	845'	845'	6
C3	SUPPLY YARD DRIFT	845'	845'	6
C4	SUPPLY YARD DRIFT	845'	845'	6
C5	VESTABURG PORTAL #1 DRIFT	845'	845'	6
C6	VESTABURG PORTAL #2 DRIFT	845'	845'	6
C7	VESTABURG PORTAL #3 DRIFT	845'	845'	6
C8	VESTABURG PORTAL #4 DRIFT	845'	845'	6
C9	VESTABURG PORTAL #5 DRIFT	845'	845'	6
C10	RIVER BRIDGE DRIFT	836'	836'	6
C11	OLD TIPPLE ENTRY #1 DRIFT	836'	836'	6
C12	OLD TIPPLE ENTRY #2 DRIFT	836'	836'	6
C13	OLD TIPPLE ENTRY #3 DRIFT	836'	836'	6
C14	OLD TIPPLE ENTRY #4 DRIFT	836'	836'	6
C15	ROUTE 88 DRIFT	829'	829'	6
D1	THEAKSTON SLOPE	991'	552'	16
D2	PACKRALLS RETURN	895'	895'	6

NOTE: Mexico, Greenlee #2, Combs and Thompson Boreholes have been left open for monitoring purposes. All other boreholes have been sealed in accordance with the approved plans.

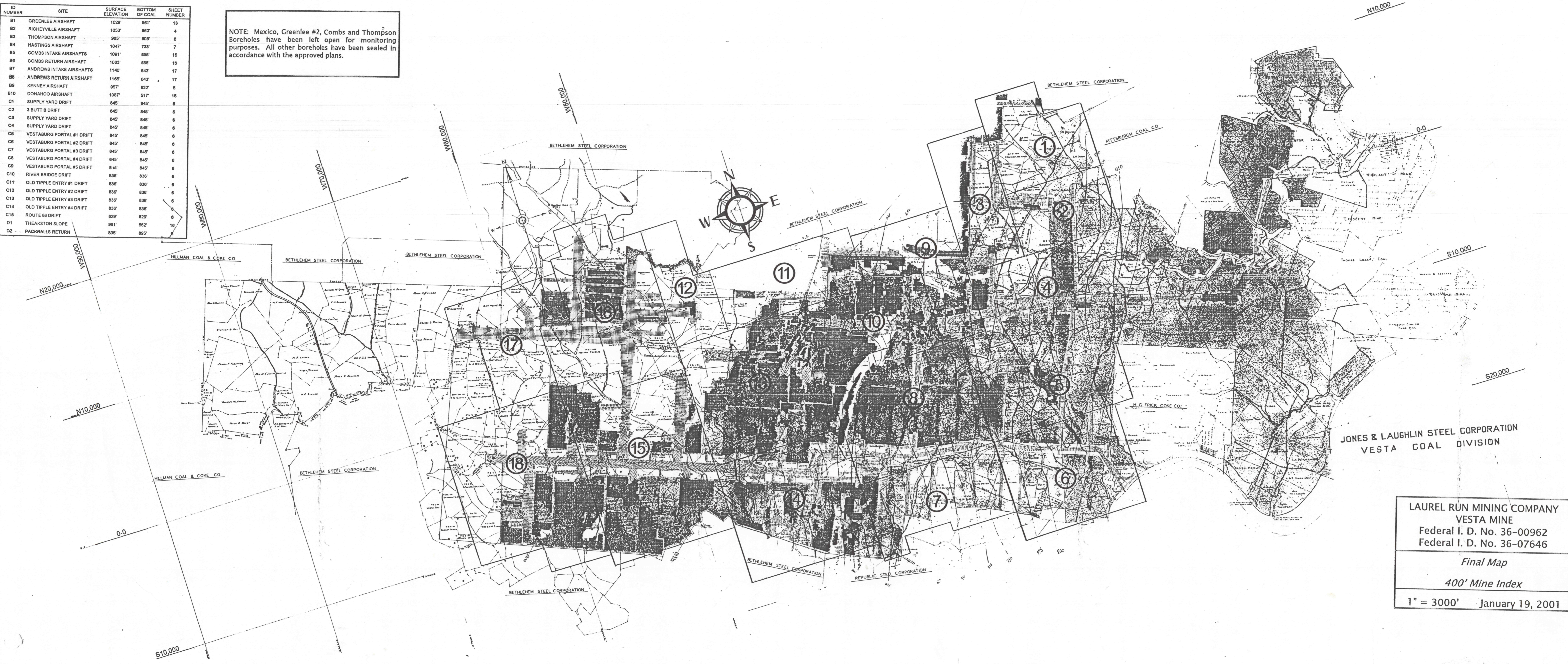

LAUREL RUN MINING COMPANY  
 VESTA MINE  
 Federal I. D. No. 36-00962  
 Federal I. D. No. 36-07646  
 Final Map  
 400' Mine Index  
 1" = 3000' January 19, 2001