

PART OF THE MINE
OF THE
BLAIRSVILLE COKE CO.

SCALE
1" = 20'

WILSON AND SMITH
C.E.s

MAY 8 1901

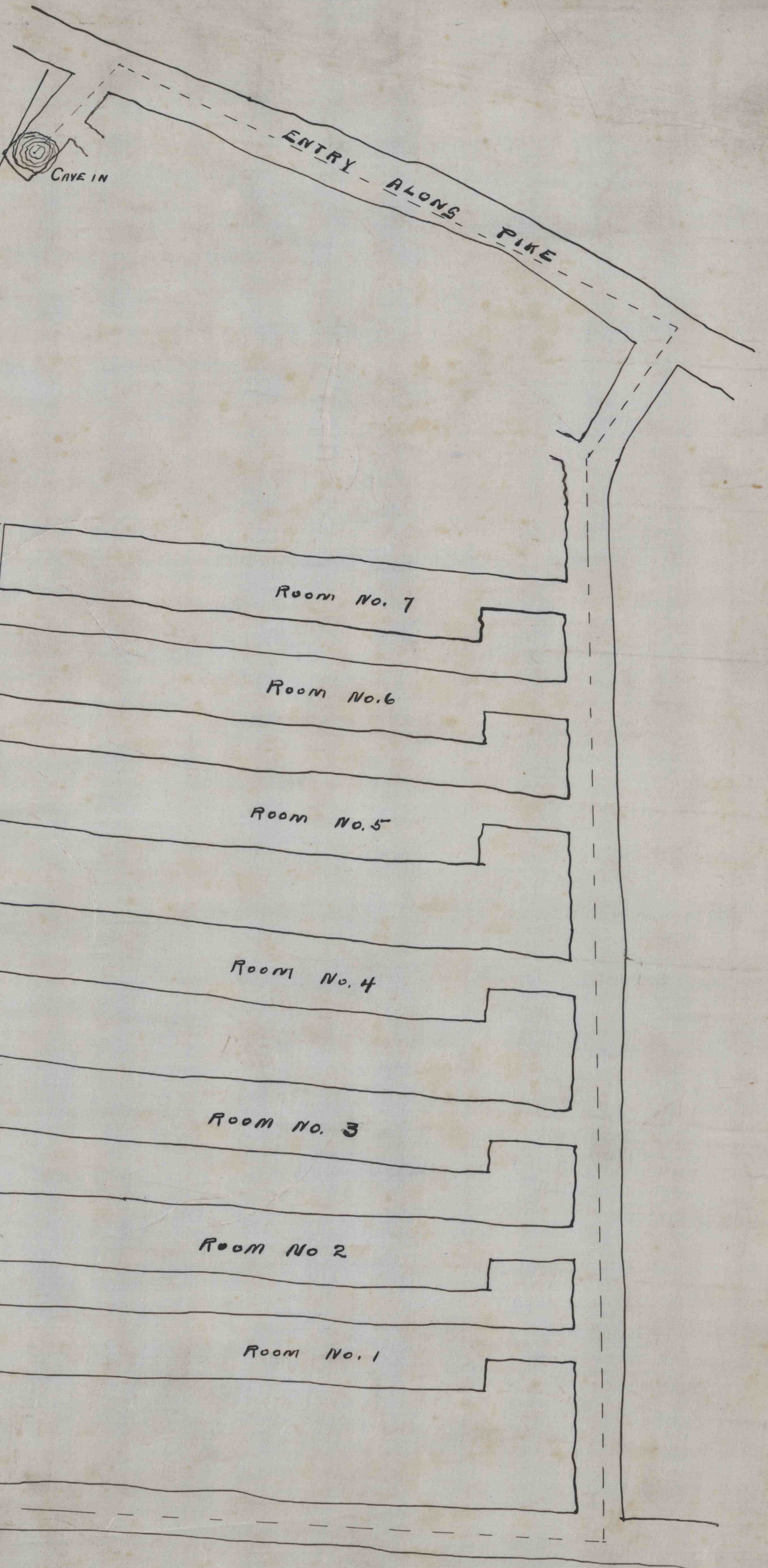

WILKINSON LINE

ENTRY ALONG PIKE

CAVE IN

LIVE

Room No. 7

Room No. 6

Room No. 5

Room No. 4

Room No. 3

Room No. 2

Room No. 1

This Room probably runs to crop before reaching Wilkinson line

CROP LINE

Opening on Allen Bank

B.C. 2 187 1/2 - 8-4
5303

4264