

NOTE-1: UNDERGROUND UTILITIES ARE PLOTTED FROM THE BEST AVAILABLE INFORMATION AND ARE NOT TIED TO MINE COORDINATE SYSTEM.  
 NOTE-2: ALL OF THE PITTSBURGH No. 8 SEAM COAL WITHIN THE PERMIT BOUNDARY IS OWNED AND/OR CONTROLLED BY MCM/UMCO, UNLESS OTHERWISE NOTED (D.N.O.)  
 NOTE-3: MAPPING FOR CRESCENT No. 2 MINE, RIDER MINE, CHARLEROI MINE, AND HILLMAN GIBSON MINE OBTAINED FROM THE PENNSYLVANIA DEPARTMENT OF ENVIRONMENTAL PROTECTION, BUREAU OF DEEP MINE SAFETY, UNIONTOWN DISTRICT MINING OFFICE. BETHLEHAM #51 MINE OBTAINED FROM CONSOL.  
 NOTE-4: PROPERTY LINES WERE TAKEN FROM WASHINGTON COUNTY TAX ASSESSMENT MAPS, AND OTHER SOURCES. ACTUAL FIELD SURVEYS ARE NOT REPRESENTED.  
 NOTE-5: MAPPING FOR THE HAZEL KIRK MINE WAS OBTAINED FROM THE PENNSYLVANIA DEPARTMENT OF ENVIRONMENTAL PROTECTION, BUREAU OF MINING AND RECLAMATION, McMURRAY DISTRICT MINING OFFICE.  
 NOTE-6: MAPPING FOR THE CATSBURG MINE WAS OBTAINED FROM THE UNITED STATES STEEL MINING Co., INC.  
 NOTE-7: ALL ACQUIRED MAPPING WAS DIGITIZED AND REFERENCED TO THE HIGH QUALITY MINE VIA KNOWN FEATURES VERIFIED IN FIELD, AND MINE COORDINATES.  
 NOTE-8: ALL BARRIER AGAINST ABANDONED MINE WORKS SHALL BE ESTABLISHED PER THE DEPARTMENT ADMINISTRATION ORDER ISSUED TO UMCO ENERGY, INC. FEBRUARY 6, 2003.

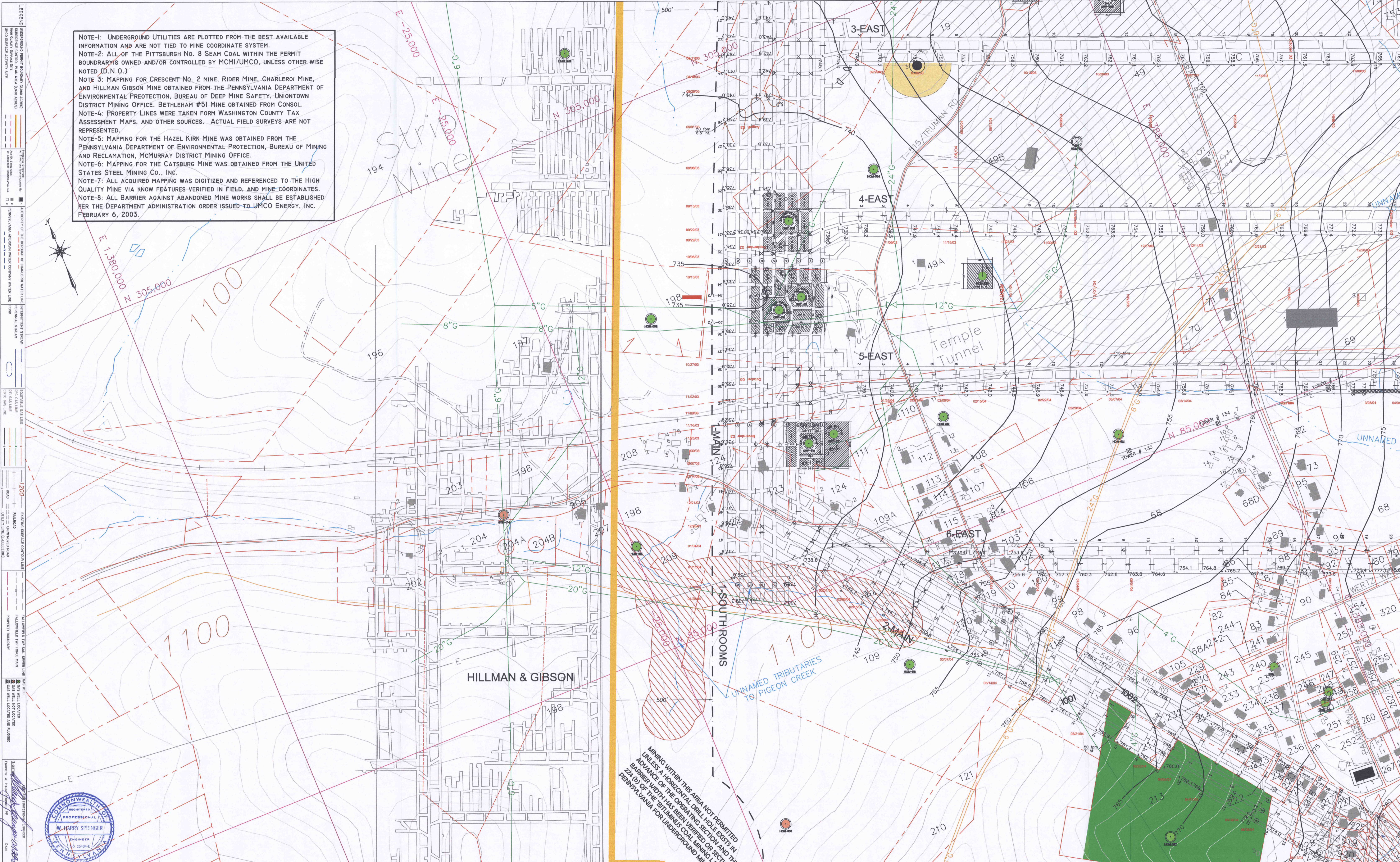

**LEGEND**

- UNDERGROUND UTILITY (24\"/>

