

MAPLE CREEK MINING, INC.  
UMCO ENERGY, INC.

HIGH QUALITY MINE  
PITTSBURGH SEAM

MSHA ID No. 36-08375  
PA-DEP CMAP - 63921301

FINAL MAP

OFFICES:  
981 ROUTE 917  
BENTLEYVILLE, PA 15314

PORTAL:  
1965 ROUTE 481  
MONONGAHELA, PA 15063

CARROLL TOWNSHIP &  
FALLOWFIELD TOWNSHIP  
WASHINGTON COUNTY  
COMMONWEALTH OF PENNSYLVANIA

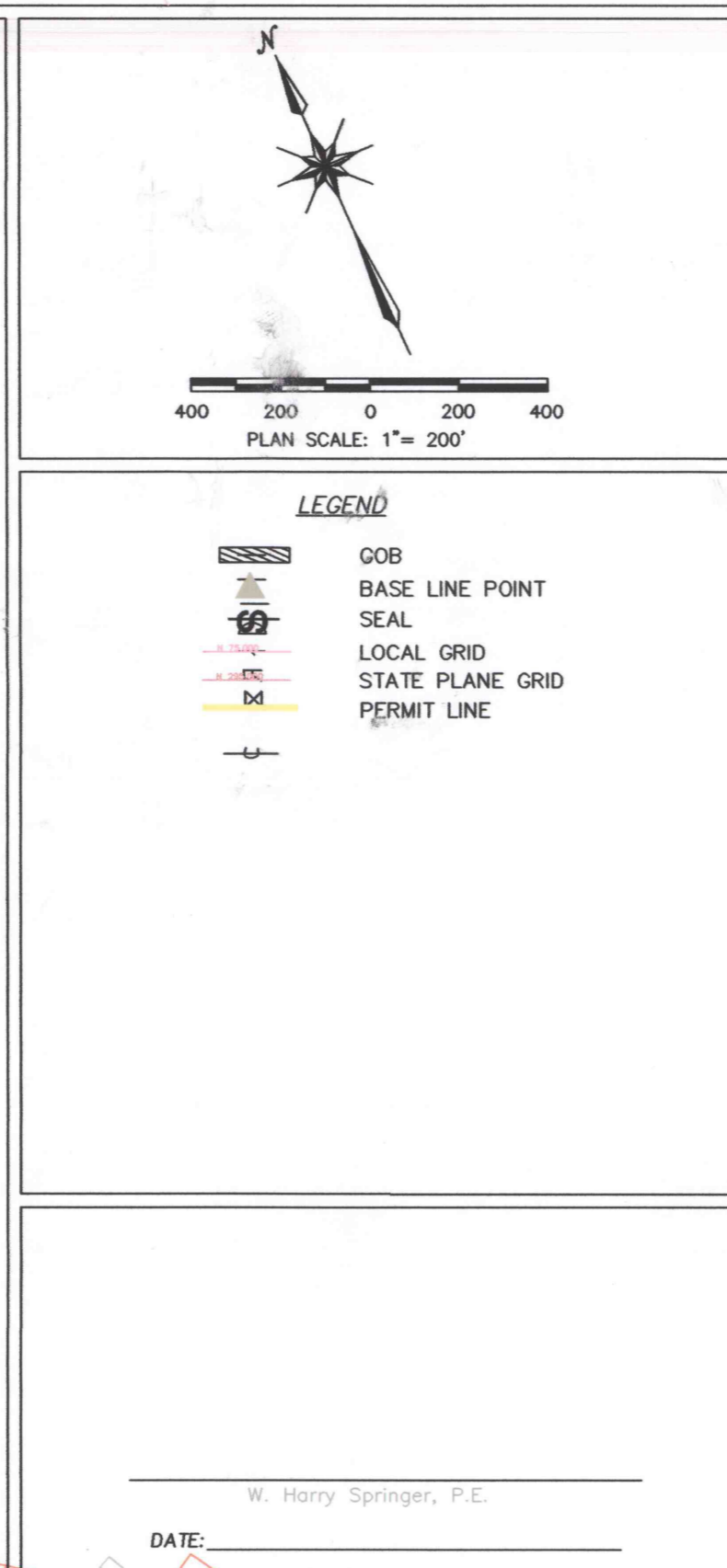

FIT TO PLAN	
A	B
C	D
E	F
G	H
I	J

LEGEND

NOTES:

Date of last mining: February 24, 2005  
No underground mining above or below High Quality Mine.  
Closed loop survey (1 in. = 5,000 feet)  
Base Monument Point No. 1  
Elev: 101,929.12 ±, 3,245,511 ±, Elev: 1,181.45 MSL  
State Plane: N 308,674.18 E 1,380,639.02 (NAD83)  
Base Monument Point No. 2  
Elev: 91,362.9 ±, 2,274,513 ±, Elev: 1,168.82 MSL  
State Plane: W 308,195.84 E 1,383,153.79 (NAD83)

CORPORATE OFFICERS SIGNATURE

This is the final map of Maple Creek Mining, Inc.'s High Quality Mine, which is used as a guide for the location of the mine. It is not intended to be used as a legal document. The mine is located in the Pittsburgh Seam of the Allegheny Group of the Western Coalfield of the Monongahela Basin of the Appalachian Coalfield of the Eastern United States. The mine is located in the area of the Pittsburgh Seam of the Allegheny Group of the Western Coalfield of the Monongahela Basin of the Appalachian Coalfield of the Eastern United States. The mine is located in the area of the Pittsburgh Seam of the Allegheny Group of the Western Coalfield of the Monongahela Basin of the Appalachian Coalfield of the Eastern United States.

Michael S. Gortner  
Geologist  
UMCO Energy, Inc.

DATE: \_\_\_\_\_

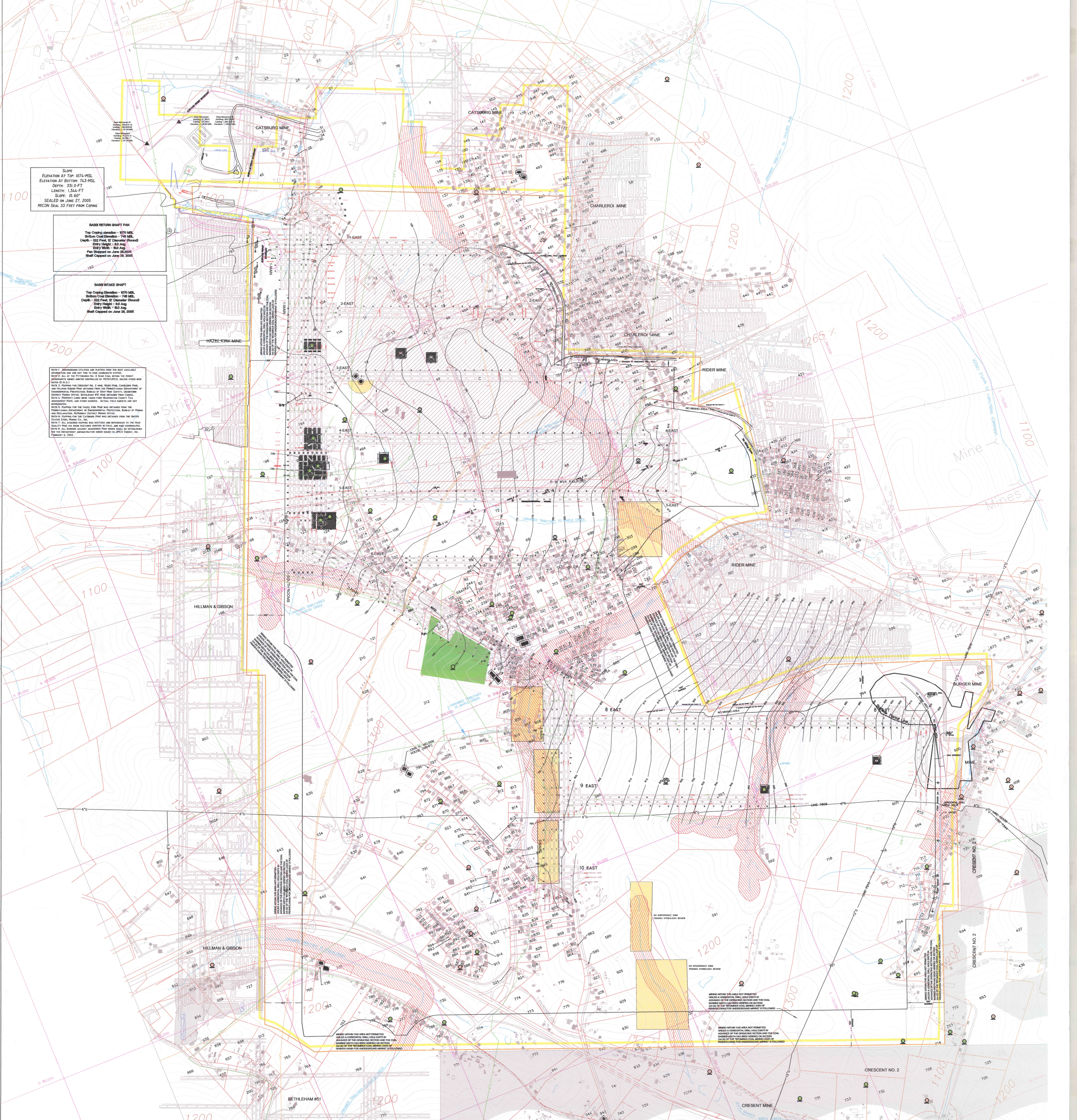

SLOPE  
ELEVATION AT TOP: 1074-MSL  
ELEVATION AT BOTTOM: 743-MSL  
SLOPE: 3.51:1 FT  
LENGTH: 1,344-FT  
SLOPE: 15:1 FT  
SEALED ON JUNE 27, 2005  
MCON SEAL 33 FEET FROM CORNER

BASS RETURN SHAFT PLAN  
Top Coping Elevation - 870 MSL  
Bottom Coping Elevation - 740 MSL  
Depth - 130 Feet 12 Diameter (Round)  
Entry Width - 8'0" Ang  
Fan Located on Mine Surface  
Shaft Capped on June 29, 2005

BASS INTAKE SHAFT  
Top Coping Elevation - 870 MSL  
Bottom Coping Elevation - 740 MSL  
Depth - 130 Feet 12 Diameter (Round)  
Entry Width - 8'0" Ang  
Fan Located on Mine Surface  
Shaft Capped on June 29, 2005

ALL INFORMATION CONTAINED HEREIN IS THE PROPERTY OF MAPLE CREEK MINING, INC. AND IS NOT TO BE REPRODUCED OR TRANSMITTED IN ANY FORM OR BY ANY MEANS, ELECTRONIC OR MECHANICAL, INCLUDING PHOTOCOPYING, RECORDING, OR BY ANY INFORMATION STORAGE AND RETRIEVAL SYSTEM. THIS INFORMATION IS THE PROPERTY OF MAPLE CREEK MINING, INC. AND IS NOT TO BE REPRODUCED OR TRANSMITTED IN ANY FORM OR BY ANY MEANS, ELECTRONIC OR MECHANICAL, INCLUDING PHOTOCOPYING, RECORDING, OR BY ANY INFORMATION STORAGE AND RETRIEVAL SYSTEM. THIS INFORMATION IS THE PROPERTY OF MAPLE CREEK MINING, INC. AND IS NOT TO BE REPRODUCED OR TRANSMITTED IN ANY FORM OR BY ANY MEANS, ELECTRONIC OR MECHANICAL, INCLUDING PHOTOCOPYING, RECORDING, OR BY ANY INFORMATION STORAGE AND RETRIEVAL SYSTEM.