

LEGEND

MINE ACTIVITY PERMITS NO. 06241318

BOUNDARY OF SUBSEQUENT REVENUE

MINED STRUCTURE

DEVELOPED ONLY AFTER THE ACT

ACCURACY - NOT SHOWN

COMPUTERIZED DATA

SURVEY AREA

POINT OF BEGINNING

CONTRACT OPERATOR

PIERPONT MINING, INC.

19.5 Six Month Projection Map

LEGEND

MINE ACTIVITY PERMITS NO. 06241318

BOUNDARY OF SUBSEQUENT REVENUE

MINED STRUCTURE

DEVELOPED ONLY AFTER THE ACT

ACCURACY - NOT SHOWN

COMPUTERIZED DATA

SURVEY AREA

POINT OF BEGINNING

CONTRACT OPERATOR

PIERPONT MINING, INC.

19.5 Six Month Projection Map

PIERPONT NO.10 MINE
 QUEBAMONING TOWNSHIP SOMERSET COUNTY
 UPPER KITTINGING - C SEAM
 CONTRACT OPERATOR
PIERPONT MINING, INC.
 P.O. BOX 286
 SOMERSET, PA. 15501

SOLAR NO.10 MINE
 QUEBAMONING TOWNSHIP SOMERSET COUNTY
 UPPER KITTINGING - C SEAM
 CONTRACT OPERATOR
SOLAR FUEL COMPANY
 BOX 488
 SOMERSET, PA. 15501

SOLAR NO.10 MINE
 QUEBAMONING TOWNSHIP SOMERSET COUNTY
 UPPER KITTINGING - C SEAM
SOLAR FUEL COMPANY
 BOX 488
 SOMERSET, PA. 15501

PIERPONT NO.10 MINE
 QUEBAMONING TOWNSHIP SOMERSET COUNTY
 UPPER KITTINGING - C SEAM
 CONTRACT OPERATOR
PIERPONT MINING, INC.
 P.O. BOX 286
 SOMERSET, PA. 15501

I, Randall L. Musser, a Professional Land Surveyor in the Commonwealth of Pennsylvania, hereby certify that the surveying and mine mapping conducted by Musser Engineering, Inc. after May 1989, was conducted in accordance with generally accepted surveying standards for the mining industry, and is true and correct to the best of my knowledge and belief. All base map preparation for the mine, and all mine surveying and mapping prior to May 1989, was conducted by and certified by the engineering staff of Solar Fuel Co. and is not the responsibility of Musser Engineering, Inc.

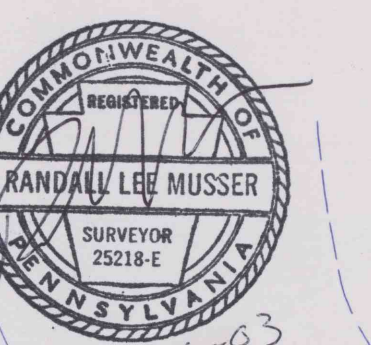

PIERPONT NO.10 MINE
 QUEBAMONING TOWNSHIP SOMERSET COUNTY
 UPPER KITTINGING - C SEAM
 CONTRACT OPERATOR
Pierpont Mining, Inc.
 P.O. Box 286
 Somerset, Pennsylvania 15501