

# CANON COAL COMPANY

## PITT GAS MINE

- PITTSBURGH SEAM -  
Jefferson Twp. Greene County  
SCALE: 1" = 200'

M.S.H.A. I.D. No. 36-06478

RECEIVED  
APR 7 1987

Dept. of Environmental Resources  
McMurry District Office

CANON COAL COMPANY  
PITT GAS MINE  
CLARKSVILLE, PENNSYLVANIA

Greene County  
Scale: 1" = 200'

Jefferson Twp.  
Survey Date: 4-1-87

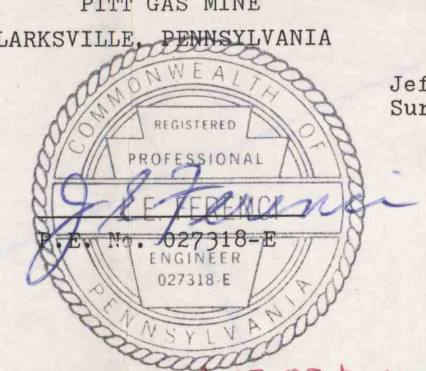

118-87 to 10-15-87

Contemplated Mining	[Red outline]
Permit Boundary	[Blue outline]
Mining Completed Area	[Yellow outline]
Support Area	[Green outline]
Support Area after Mining	[Light Green outline]
Previous 6 Month Mining Area	[Orange outline]
Surface Property Owners	[Blue hatched]
Protected Structures	[Green hatched]
Structures Not Protected in Place 4-27-86	[Light Green hatched]
Structures Built After 4-27-86	[Yellow hatched]
Structures no longer in Existence	[Red hatched]

Parcel No.	Name of Surface Owner
128	Hillman Coal Co.
130-A	Hillman Coal Co.
131	Richardson, Harry
132	Hillman Coal Co.
133-A	Koel, Paul
136	Hillman Coal Co.
148	Hillman Coal Co.
150-A	Hillman Coal Co.
151	Hillman Coal Co.
152	Hillman Coal Co.
153	Hillman Coal Co.
154	Foreach, James A.
155	Koel, Paul
155-A	Koel, Paul
156-B	Greenwood, Elizabeth
157	Hillman Coal Co.
Mineral Ownership	
	United States Steel Co.

0' 200' 500'

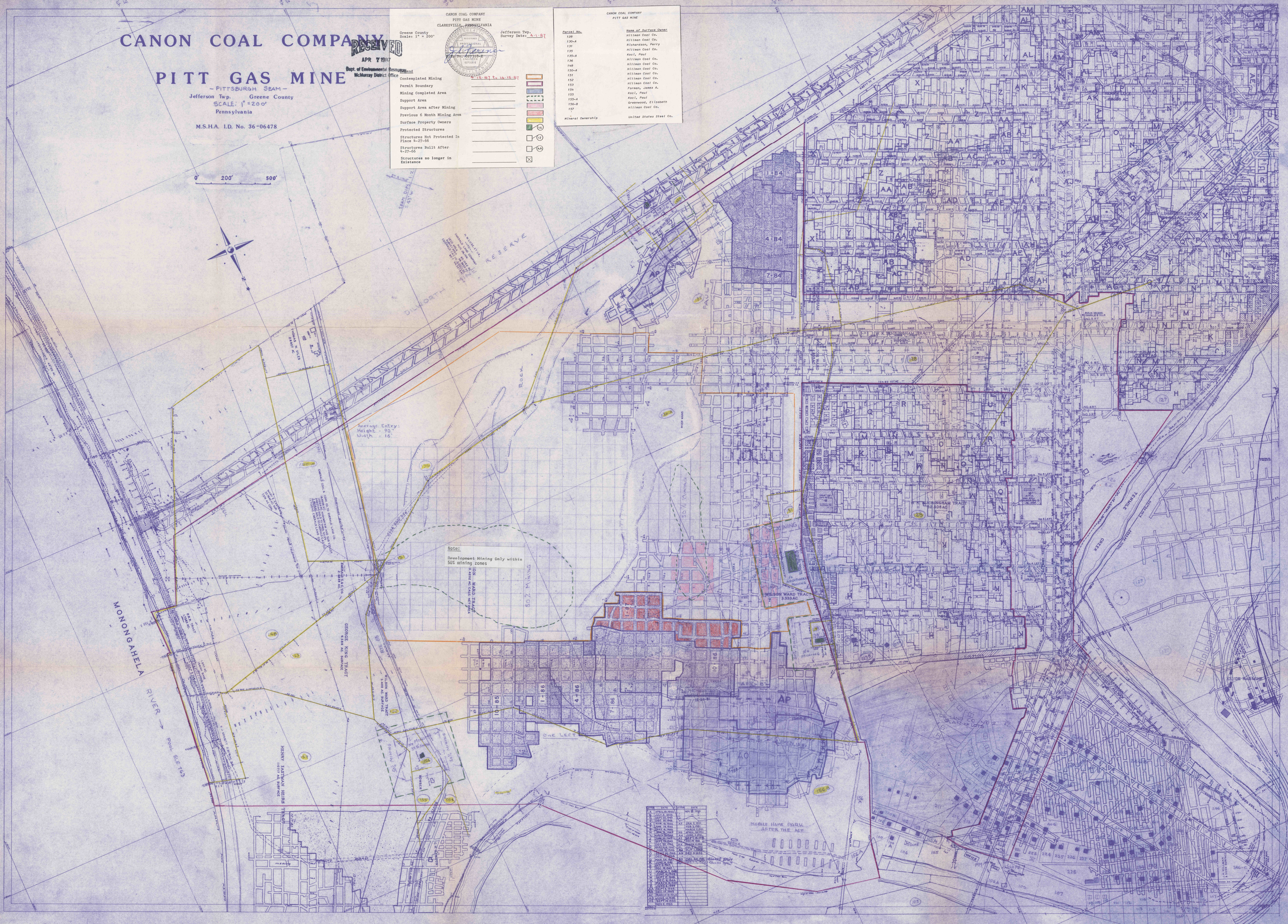
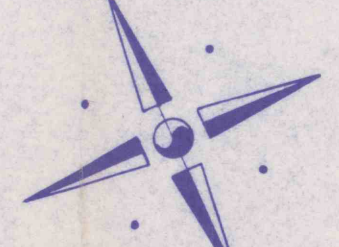

Note:  
Development Mining Only within  
50% mining zones

Parcel No.	Owner	Area (Ac.)	Notes
128	Hillman Coal Co.	1.28	
130-A	Hillman Coal Co.	1.30	
131	Richardson, Harry	1.31	
132	Hillman Coal Co.	1.32	
133-A	Koel, Paul	1.33	
136	Hillman Coal Co.	1.36	
148	Hillman Coal Co.	1.48	
150-A	Hillman Coal Co.	1.50	
151	Hillman Coal Co.	1.51	
152	Hillman Coal Co.	1.52	
153	Hillman Coal Co.	1.53	
154	Foreach, James A.	1.54	
155	Koel, Paul	1.55	
155-A	Koel, Paul	1.55	
156-B	Greenwood, Elizabeth	1.56	
157	Hillman Coal Co.	1.57	