

**LEGEND**

SURFACE PROPERTY LINES  
 STREAMS  
 PONDS or IMPOUNDMENTS  
 ROADS  
 DWELLINGS of PUBLIC BLDGS  
 BARNs, GARAGES, SHEDs, or OTHER BLDGS  
 WATER SOURCES: WELLS  
 SPRINGS  
 ELECTRIC LINES (Overhead)  
 BARRIER LINES

LOWER FREEPORT (DIP) COAL SEAM OUTCROP  
 COAL CONTOURS (Bottom of Coal Seam)  
 DRILL HOLES  
 AXIS LINE  
 FINAL "D" SEAM HIGHWALLS  
 DEEP MINE WORKINGS  
 PREVIOUSLY STRIP MINED AREAS  
 DIVERSION DITCHES  
 COLLECTION DITCHES

**Subsidence Legend**  
 M.A.P. No. 32841322

Contemplated Mining From To  
 Previous Six Month's Mining Limits of Mining Line  
 Mining Completed Subsidence Permit Line  
 Subsidence Support Area

MATCH TO SHEET 4

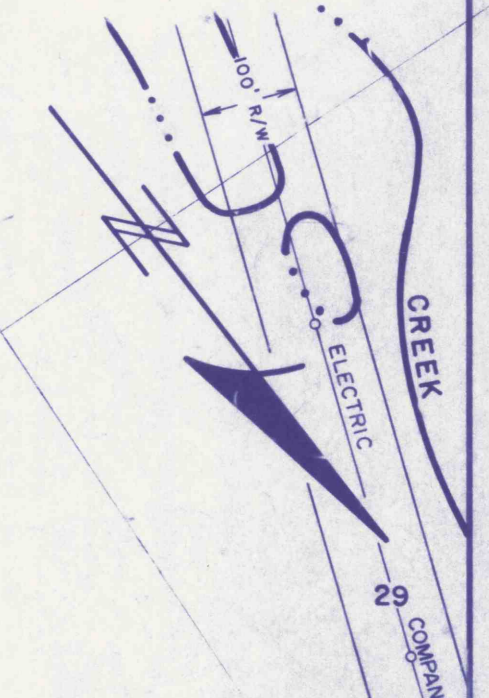

MUSSER ENGINEERING INC IS NOT RESPONSIBLE FOR MAPPING BEFORE SEPTEMBER 1994. MAPPING PRIOR TO THAT DATE WAS CONDUCTED BY THE ENGINEERING STAFF OF VALLEY COAL COMPANY. ELEVATIONS ESTABLISHED BEFORE THE ABOVE DATE MAY BE INACCURATE BUT DO REFLECT THE GENERAL STRIKE AND DIP OF THE COAL SEAM.



2-18-02  
**FINAL MAP**  
 EXHIBIT 19.5

**BELT MONITORING STATION**

B.M. 1-14'x39"
B.M. 2-11'x44"
B.M. 3-14'x43"
B.M. 4-14'x35"
B.M. 5-10'x42"
B.M.
B.M.
B.M.

**AIR MONITORING STATION**

1. CH4-0.00%, O2-20.8%
2. CH4-0.00%, O2-20.8%
3. CH4-0.00%, O2-20.8%
4. CH4-0.00%, O2-20.8%

**AIR READINGS**

1.			
2.	Methane:	0.00 %	
3.	Methane:	0.00 %	Oxygen: %
4.	Methane:	0.00 %	Oxygen: %
5.	Methane:	0.00 %	Oxygen: %
6.	Methane:	0.00 %	Oxygen: %
7.	Methane:	0.00 %	Oxygen: %
8.	Methane:	0.00 %	Oxygen: %
9.			
10.	Methane:	0.00 %	Oxygen: %
11.	Methane:	0.00 %	Oxygen: %
12.	Methane:	0.00 %	Oxygen: %
13.	Methane:	0.00 %	Oxygen: %
14.	Methane:	0.00 %	Oxygen: %
15.	c.f.m.	Methane: %	Oxygen: %
16.	c.f.m.	Methane: %	Oxygen: %
16A.	c.f.m.	Methane: %	Oxygen: %
17.	c.f.m.	Methane: 0.00 %	Oxygen: %
18.	c.f.m.	Methane: 0.00 %	Oxygen: %
19.	c.f.m.	Methane: %	Oxygen: %
20.	c.f.m.	Methane: %	Oxygen: %
21.	Methane:		Oxygen: %

NOTE: All Coal Lands To Be Mined Are Within The Lower Freeport Coal Seam And Are Owned Solely By: PENN CENTRAL PROPERTIES, INC. No mining above or below.

PREPARED FOR:  
**RAYNE ENERGY, INC.**  
 RD 2 BARNESBORO, PA 15714

**RAYNE NO. 1 MINE**  
 LOWER FREEPORT COAL SEAM  
 MINE I.D. NO: 36-00930  
 SITUATE:  
 PINE TOWNSHIP, INDIANA COUNTY,  
 PENNSYLVANIA

SCALE: 1" = 200'

RD 1 Central City, PA 15926  
 (814) 754-8477  
**Musser Engineering Inc.**

The Individual(s) Responsible For The Information On This Map Are:  
 JOHN HICKS, Mine Foreman/Superintendent  
 22. c.f.m. Methane: 0.00 % Oxygen: %  
 25. c.f.m. Methane: 0.00 % Oxygen: %

This Map Satisfies the requirements of 75.372 & 75.1200.

**Ventilation Legend**

A.M.S. - Air Monitoring Station

Caves xxx

Intake Air

Return Air

Reduced Air Flow

Belt Air Flow (Intake)

Primary Escapeway

Alternate Escapeway

Permanent Stopping

Canvas Check

Proposed Seal

Door

Regulator

Overcast Equipment Doors

Belt Haulage

Tractor Haulage (Wet and Rock Dusted)

Intake Evaluation Point

Bleeder Evaluation Point

AREA NOT SURVEYED

**FAN DATA**  
 Location: NO. 1 ENTRY - OFFSET 15 FT.  
 Mfr: JEFFREY Fan Type: AERODYNE  
 Size: 5 FT. R.P.M. 1750  
 Water Gage Reading:  
 Air Quantity: c.f.m. EXHAUSTING  
 Blade Setting: FIXED  
 Horsepower: 50 Voltage: 440 Amps: 30  
 Collection Model No. C131024

**GLORY NO. 2 MINE**  
 GLORY COAL COMPANY  
 FORMERLY OPERATED BY BEILCHICK BROTHERS  
 STATUS: TERRACED BACKFILLED AND PLANTED MINE AND COMPLETED PRIOR TO 1984