

MATCH TO SHEET 4

ARC ASSOCIATES
K & J COAL CO. INC.
SMP # 780229
FINAL HIGHWALL

MATCH TO SHEET 2

PAUL WARNER
BERTILLE STANOVICH

MATCH TO SHEET 2

MRS. DENNIS JOHNSON



LEGEND:
MINE PERMIT BOUNDARY, SYEAR MINING AREA
AND SUBSIDENCE CONTROL PLAN BOUNDARY

- PROPERTY BOUNDARY
- EXISTING DEEP MINE
- DOMESTIC WATER WELL
- GAS WELL (PLUGGED)
- DRILL HOLE LOCATION
- OUTCROP-UPPER KITANNING SEAM
- BELT CONVEYOR
- PERMANENT STOPPIINGS
- TRACK

MINE SUBSIDENCE PLAN LEGEND:
PROPOSED SIX MONTH PROJECTION 4/21/95THRU 10/21/95

- COAL BARRIER
- 50% EXTRACTION AREA
- NO MINING AREA
- PREVIOUS SURFACE MINED AREA
- SUBSIDENCE CONTROL PLAN BOUNDARY
- CMAP PERMIT BOUNDARY
- STRUCTURES EXIST. PRIOR TO APR. 27, 1966
- SURFACE SUPPORT AREA 24 ZAC

NOTE:
THERE ARE NO UNDERGROUND MINE
WORKINGS LOCATED ABOVE OR BELOW
THE SEAM BEING MINED.

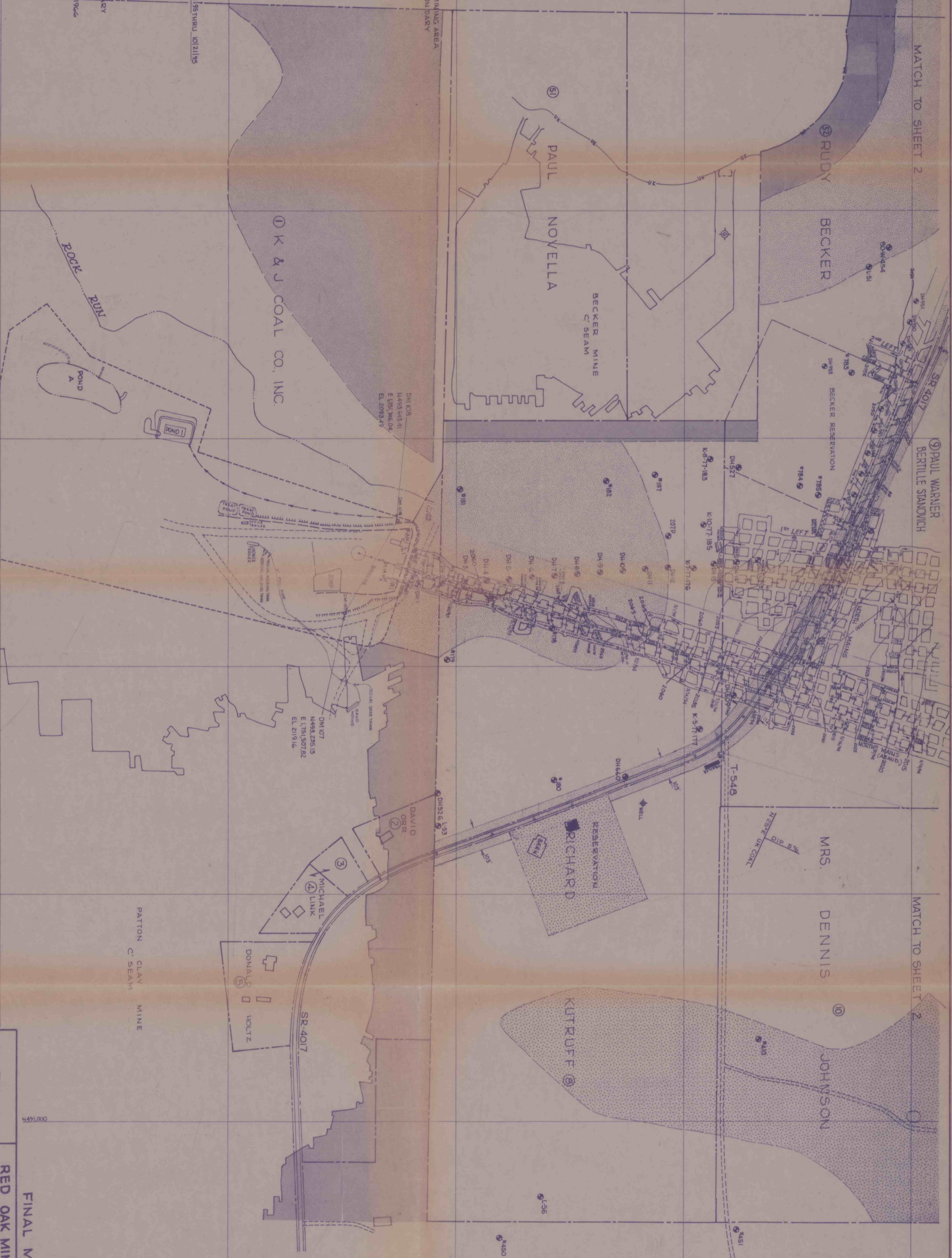

MAP SHOWING FINAL MINE
WORKINGS AS PER FINAL
SURVEY CONDUCTED 12/15/95



FINAL MINE MAP
RED OAK MINING COMPANY
"SOUTH MINE"
CMAP # 11851302
SITUATE
CHEST TWP., CAMBRIA CO., PA.
MINETECH ENGINEERS
ALTOONA, PENNSYLVANIA
DATE: MAR 24 1997