

N

Strike N30E
DIP 5%
560E

DEERFIELD COAL CO. Surf.
ELDORA LAND CO. "E" Min.

TUSCANO EST. Surf.
SAM Approx. E outcrop

DEERFIELD COAL CO. Surf. & Min.

PAUL WALKER Surf.
DEERFIELD COAL CO. "E" Min.

HARRY HORNER Surf.

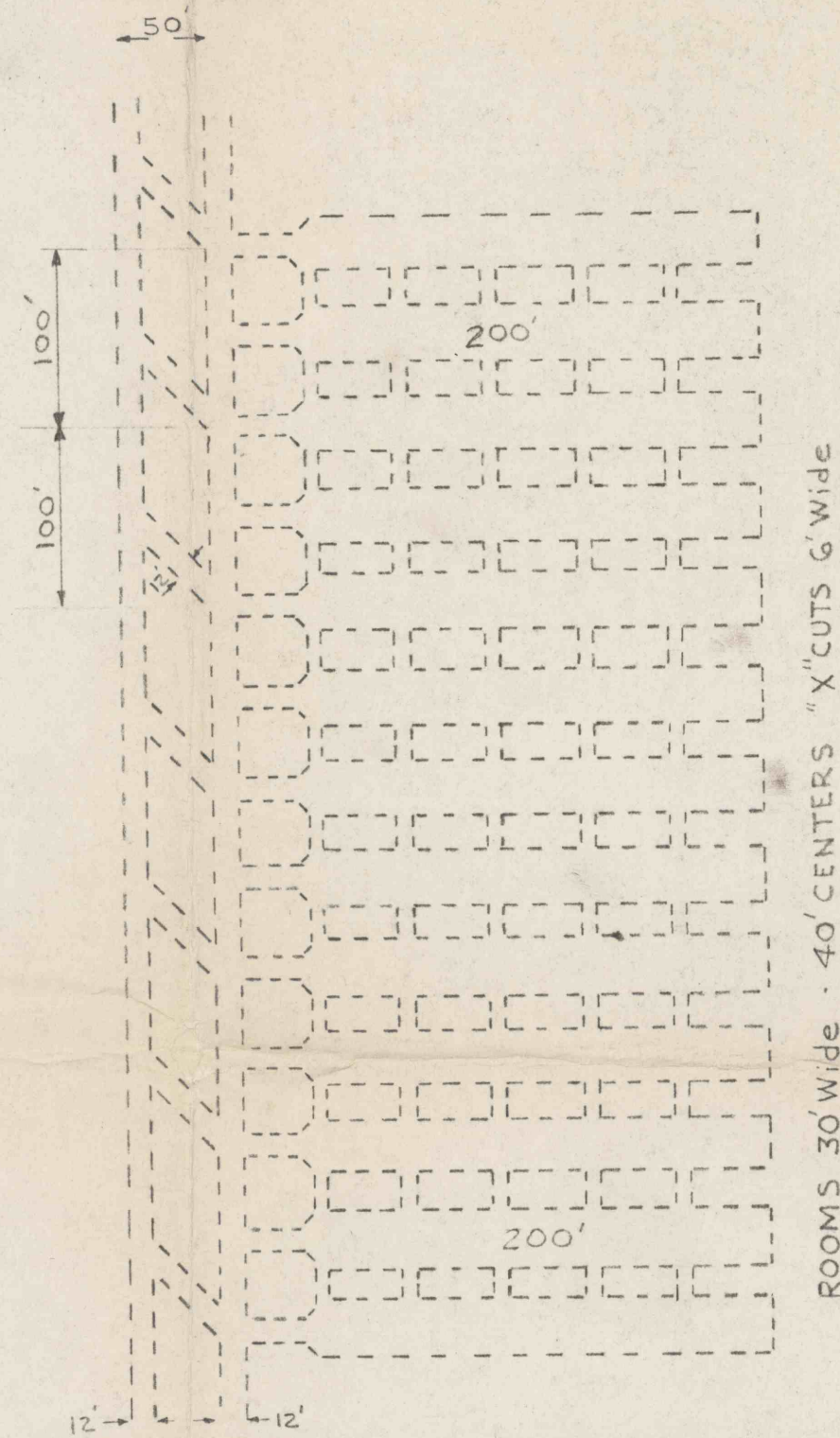

TYPICAL MINING PROPOSED Scale 1"=100'

REVISED 6-8-67

To Zimble Run

Stream

CLIFFORD STUFF Surf.
SAMUEL CRIST Min.

G. & A. NERI
3AC Surf.

NERI Slope

HARRY HORNER Surf.

FUTURE MINING AREA

MILTON MOSTELLER Surf.
GEORGE DICKEY "E" Min. (Prob.)

To Ralphton Imi. T-687

MILTON LOHR Surf.
HIRAM GARDNER

DWIGHT MILLER Surf.

Horner's Evangelical
Lutheran Church
CEMETERY
"E" Min. Reserved
DEPTH 158'

Fr. Church

ELMER SNYDER Surf.

ELDORA LAND CORP. "E" Min.

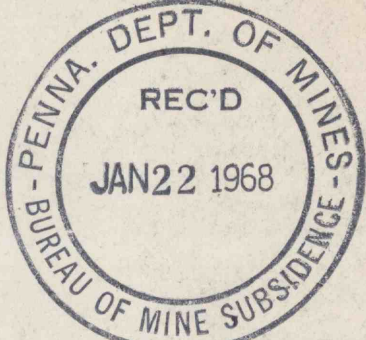

LEGEND

- Old Workings - Quemahoning Coal Co. No. 7 Mine (Map dated 1921)
- Mineral ("E") Boundary Line
- Mine Workings by G. & A. NERI to date
- Proposed 6 Month Mining Area Beg. Oct. 1, 1967 to April 1, 1968

G. & A. NERI COAL CO.
"E" (Upper Freeport) Seam
Quemahoning Twp., Somerset Co., Pa.
Oct. 13, 1966 Scale 1"=200'
By E. J. Ridilla R.S.

B.F.L.

#1913
12-21-99
CC