

CONDON COAL COMPANY
 DEAN TOWNSHIP
 CAMBRIA CO. PA
 LEASED FROM W.L. MOORE ENG. TYSON PA
 ESTATE OF A.A. STEVENS

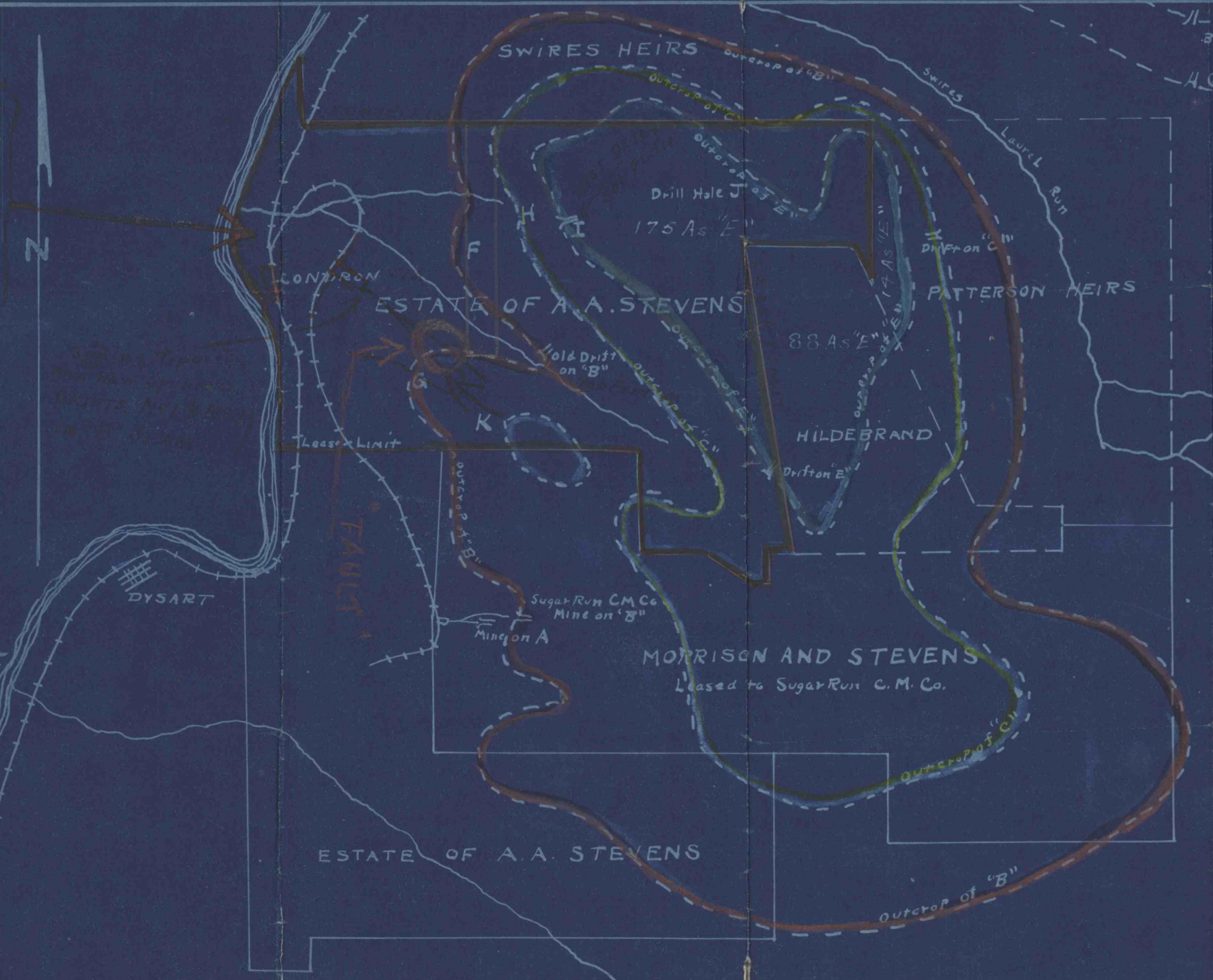

Blair Cambria Coal Co. Mine on "C"
 Garman's Mine on "B"



Green = "E" Coal
 Yellow = "C" Coal
 Red = "B" Coal
 BROWN. Lease

MAP ACCOMPANYING REPORT
 to M.M. HART regarding
 COAL LANDS OF
 ESTATE OF A.A. STEVENS
 Dean Township, Cambria Co., Penna.
 scale 1" = 100 FS
 J. S. Sillyman & Co
 Nov. 9, 1917. Engineers

A COPY MADE BY
 S.R. MOORE ENGINEER