

Scale 1" = 1200'

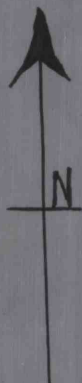

Property Map  
Boucher-Cortright Coal Co.  
Holdings & Leasings  
-at-

Beaverdale, Pa.

Summerhill Township - Cambria County

June 30th 1920

Frank W. Cortright  
Eng.

Slate

31" Coal

1/2" Slate

15" Coal

Fine Clay

Section "D" Seam Tract #1-

Tract #4-

Tract #1

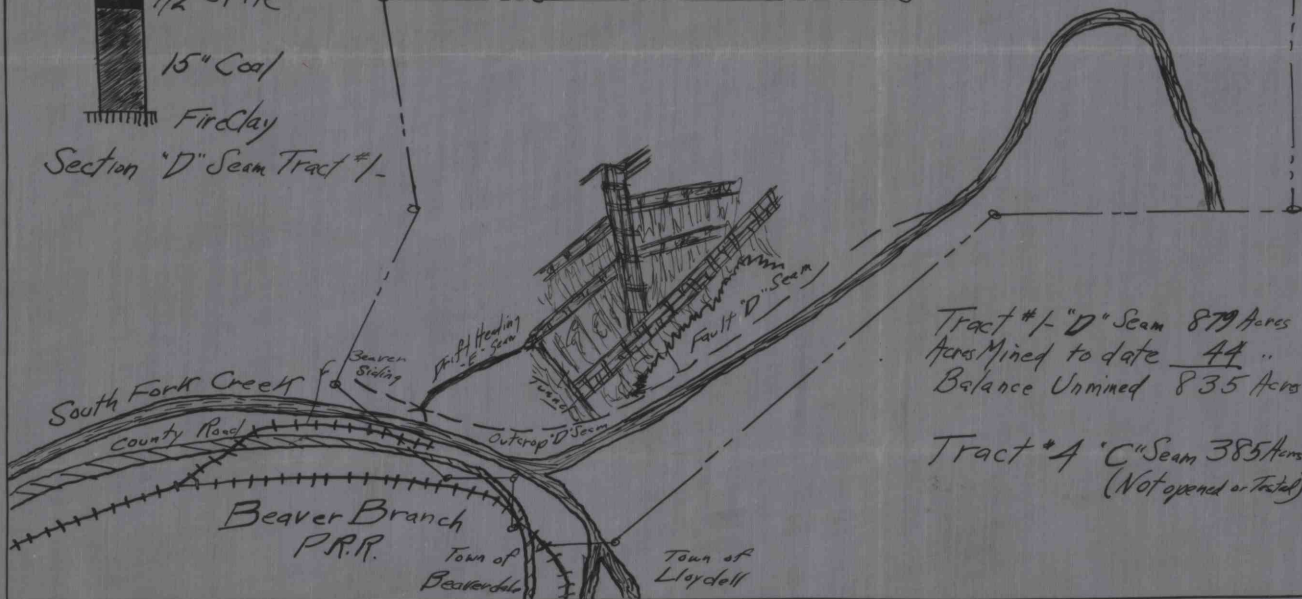

Tract #1 "D" Seam 879 Acres  
Acres Mined to date 44 "  
Balance Unmined 835 Acres

Tract #4 "C" Seam 385 Acres  
(Not opened or mined)

Beaver Branch  
P.R.

Town of  
Beaverdale

Town of  
Lloydell