



ADAM SHETTIG
37.27 A

N 441,000

EASTERN ASSOCIATED COAL CORPORATION
BETHLEHEM MINES CORPORATION

MATCH TO SHEET 5C

N 435,000

N 435,000

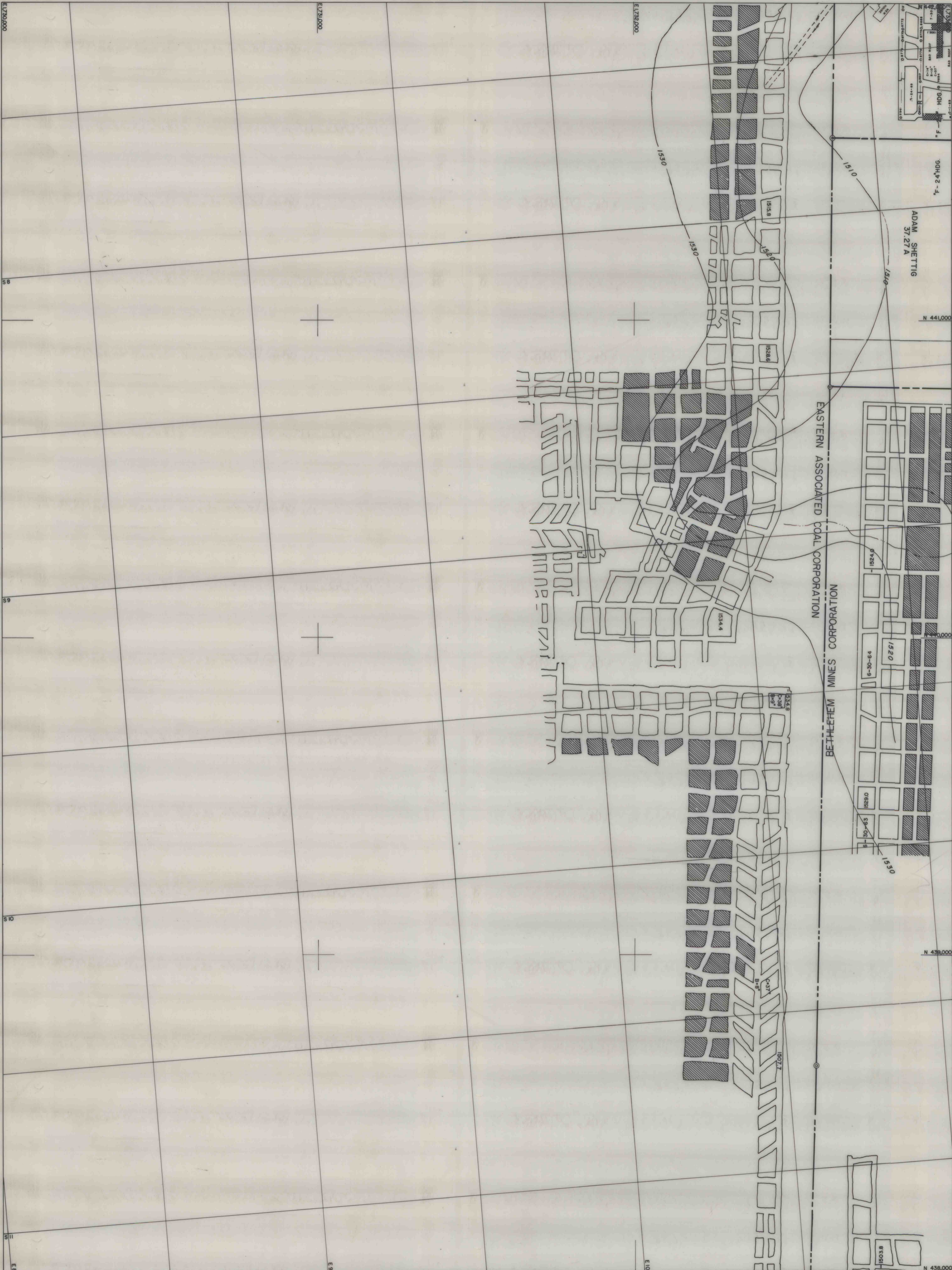

4421



BARNES & TUCKER COMPANY
LANCASTER NO. 20 MINE
EAST CARROLL TOWNSHIP, CAMBERA COUNTY, PENNSYLVANIA
SCALE: 1"=100'
DATE: JULY, 1976

