



ELI COPPE ESTATE  
D-98,880 A.  
C-98,893 A.

(27)

(28)

ELI COPPE ESTATE  
D-98,880 A.  
C-98,893 A.

(63)

L.S. EVERLY  
D-69,36 A.  
C-68,994 A.

(1942)

W.M. McCURE  
D-10,000 A.  
C-10,000 A.

FORNIA S. MILLER  
CAL.  
D-13,070 A.  
C-12,950 A.

D-10,000 A.  
C-10,000 A.

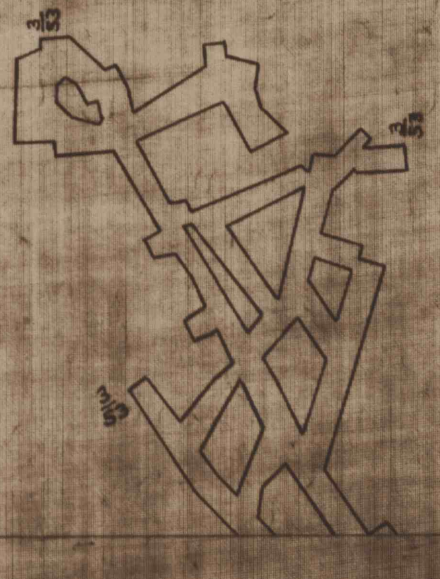

Drawn by C. C. ...