

SURVEYED BY	DATE
G.S. ALTEMUS	JAN. 20, 1931
L.H. ALTEMUS	FEB. 17, 1933
"	FEB. 9, 1935
"	JAN. 7, 1936
"	AUG. 3, 1941
"	MAR. 21, 1943
M. F. BALL	SEPT. 15, 1945
"	FEB. 4, 1945
"	DEC. 9, 1945
"	MAR. 15, 1950

NOTE:- WARSHEL MINE - QUIT MINING 5-21-56
EQUIPMENT PULLED - DRIFT SEALED.

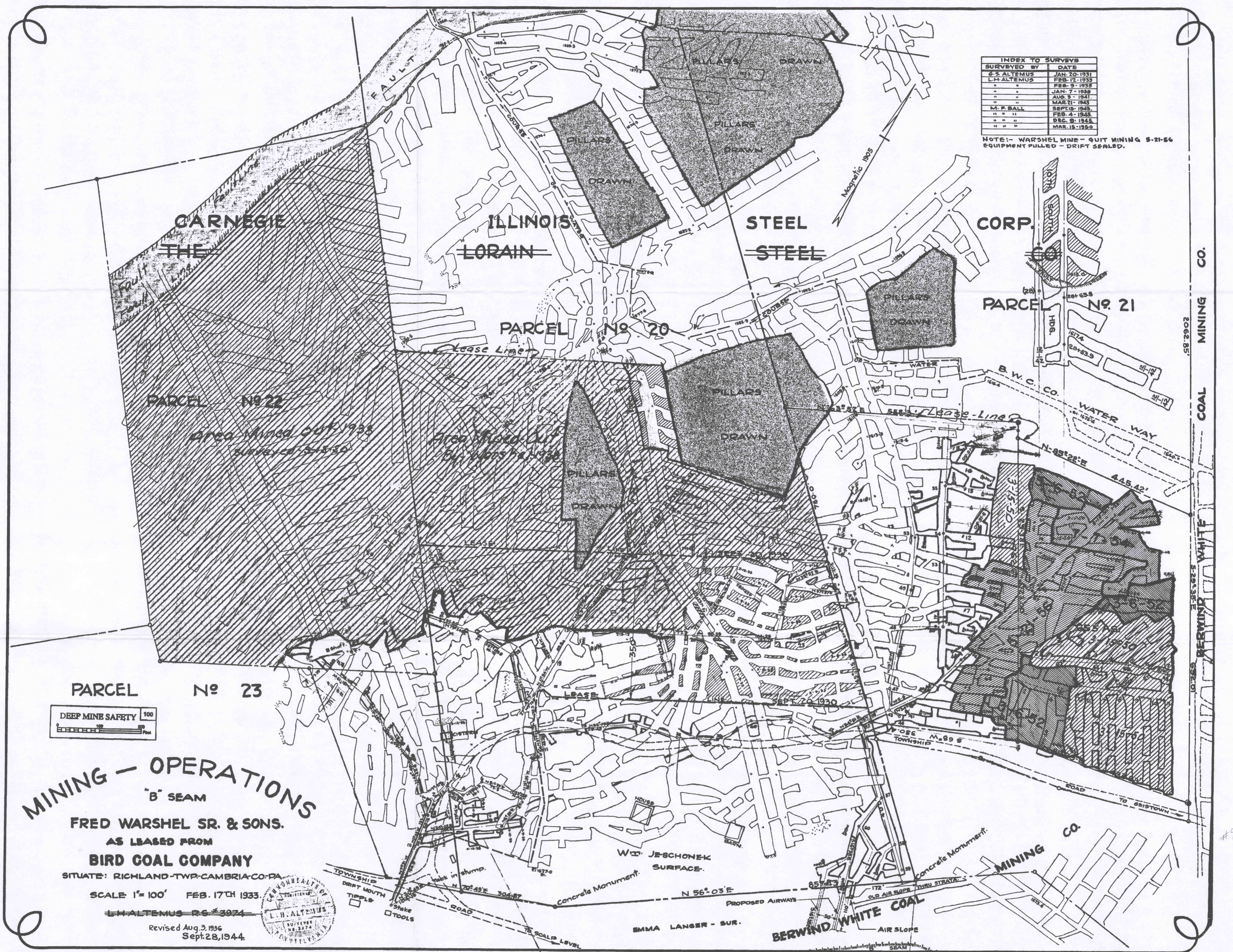

MINING - OPERATIONS
"B" SEAM

FRED WARSHEL SR. & SONS.
AS LEASED FROM
BIRD COAL COMPANY

SITUATE: RICHLAND-TWP-CAMBRIA-CO-PA
SCALE 1"=100' FEB. 17TH 1933.

L.H. ALTEMUS RG #3074
Revised Aug. 3, 1936
Sept. 28, 1944.

