

WEST BRANCH COAL CO.

John Kline (Bigler's)

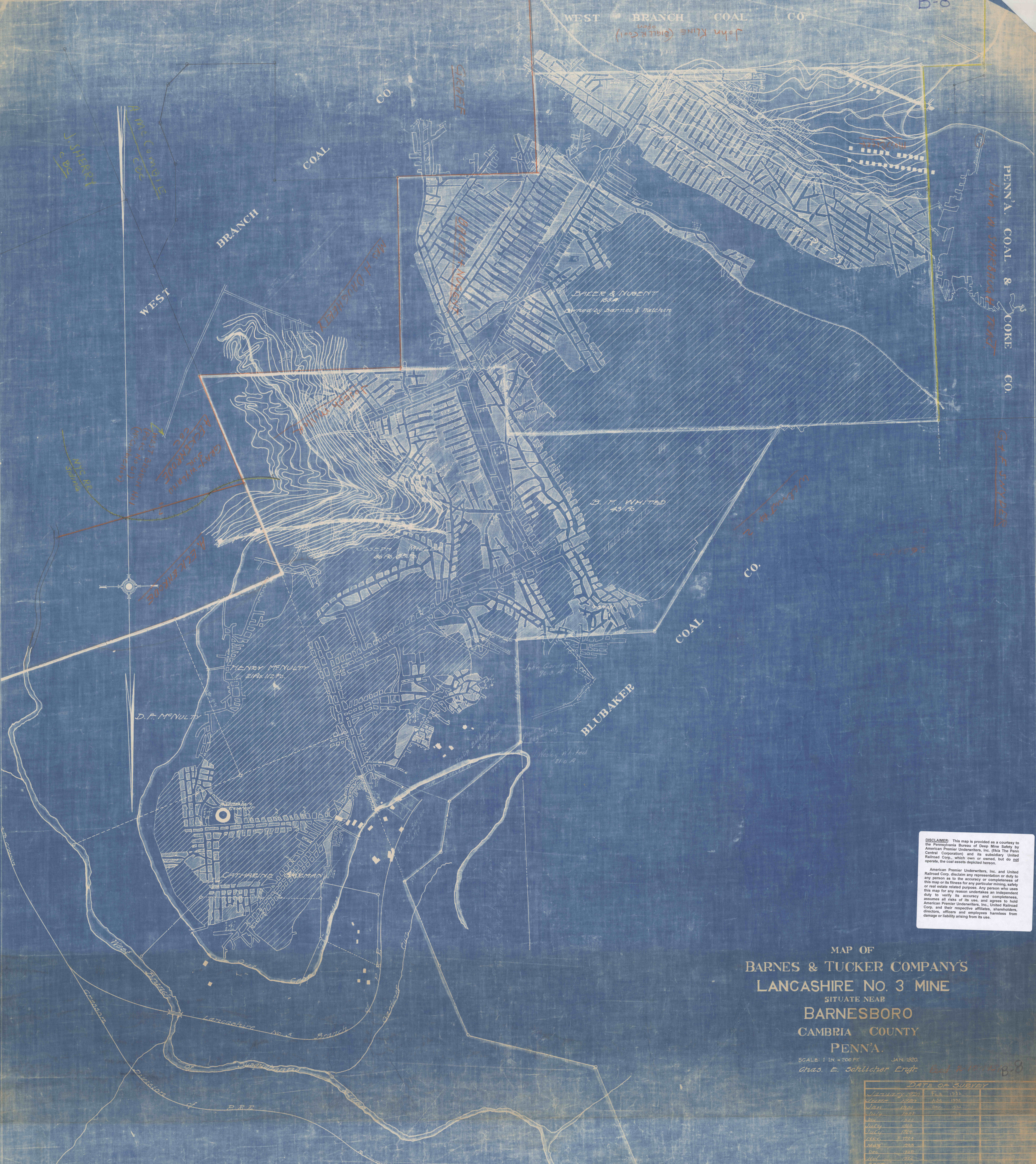

DISCLAIMER: This map is provided as a courtesy to the Pennsylvania Bureau of Deep Mine Safety by American Premier Underwriters, Inc. (PWA The Penn Central Corporation) and its subsidiary United Railroad Corp., which own or owned, but do not operate, the coal assets depicted hereon.

American Premier Underwriters, Inc. and United Railroad Corp. disclaim any representation or duty to any person as to the accuracy or completeness of this map or its fitness for any particular mining, safety or real estate related purpose. Any person who uses this map for any reason undertakes an independent duty to verify its accuracy and completeness, assumes all risks of its use, and agrees to hold Corp. and their respective affiliates, shareholders, directors, officers and employees harmless from damage or liability arising from its use.

MAP OF
BARNES & TUCKER COMPANY'S
LANCASHIRE NO. 3 MINE
 SITUATE NEAR
BARNESBORO
CAMBRIA COUNTY
PENNA.

SCALE: 1 IN. = 200 FT. JAN. 1920.
 Chas. E. Schlicher Engr. *John Kline B-8*

DATE OF SURVEY	
Jan	1920
Jan	1921
Jan	1922
Jan	1923
Jan	1924
Jan	1925
Jan	1926
Jan	1927
Jan	1928
Jan	1929
Jan	1930
Jan	1931
Jan	1932
Jan	1933
Jan	1934
Jan	1935
Jan	1936
Jan	1937
Jan	1938
Jan	1939
Jan	1940
Jan	1941
Jan	1942
Jan	1943
Jan	1944
Jan	1945
Jan	1946
Jan	1947
Jan	1948
Jan	1949
Jan	1950
Jan	1951
Jan	1952
Jan	1953
Jan	1954
Jan	1955
Jan	1956
Jan	1957
Jan	1958
Jan	1959
Jan	1960
Jan	1961
Jan	1962
Jan	1963
Jan	1964
Jan	1965
Jan	1966
Jan	1967
Jan	1968
Jan	1969
Jan	1970
Jan	1971
Jan	1972
Jan	1973
Jan	1974
Jan	1975
Jan	1976
Jan	1977
Jan	1978
Jan	1979
Jan	1980
Jan	1981
Jan	1982
Jan	1983
Jan	1984
Jan	1985
Jan	1986
Jan	1987
Jan	1988
Jan	1989
Jan	1990
Jan	1991
Jan	1992
Jan	1993
Jan	1994
Jan	1995
Jan	1996
Jan	1997
Jan	1998
Jan	1999
Jan	2000
Jan	2001
Jan	2002
Jan	2003
Jan	2004
Jan	2005
Jan	2006
Jan	2007
Jan	2008
Jan	2009
Jan	2010
Jan	2011
Jan	2012
Jan	2013
Jan	2014
Jan	2015
Jan	2016
Jan	2017
Jan	2018
Jan	2019
Jan	2020
Jan	2021
Jan	2022
Jan	2023
Jan	2024
Jan	2025
Jan	2026
Jan	2027
Jan	2028
Jan	2029
Jan	2030