

38 BUT  
A-71471  
3RD QUARTER  
1993

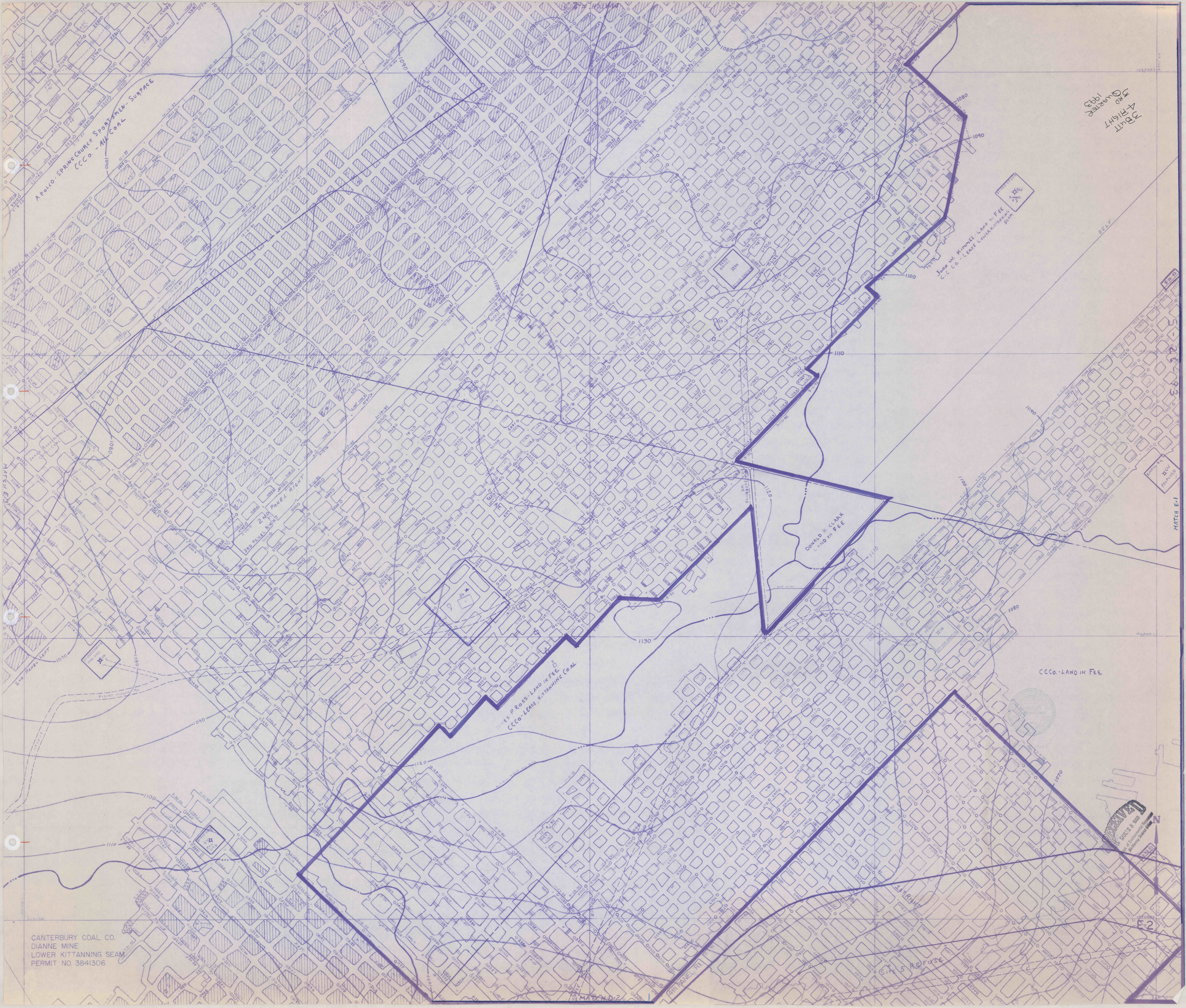

APOLLO SPRING CHURCH SPORTSMEN - SURFACE  
CCCo. - AK COAL

JOHN W. KIMMEL LAND IN FEE  
CCCo. LEASE LOWER KITTANNING SEAM

DONALD H. CLARK  
LAND IN FEE

LES PROOS - LAND IN FEE  
CCCo. LEASE KITTANNING SEAM

CCCo. - LAND IN FEE

CANTERBURY COAL CO.  
DIANNE MINE  
LOWER KITTANNING SEAM  
PERMIT NO 3841306

APPROVED  
MAY 19 1993  
Office of Environmental Planning  
Allegheny Planning Agency

SITE 5 REFUSE