

Mulvihill Sub-sta.  
1-300 KVA Rectifier  
56'x60' x 12' deep  
From Pine No. 1 Tipples

PINE No. 1 - DIE SECTION  
Buildings 38'x40' 4830'  
from Pine No. 1 Tipples

Douglass Sub-Sta.  
1-300 KVA Rectifier

McDonnell Sub-Sta.  
1-300 KVA Motor Gen.

Inside Sub-Sta.  
1-300 KVA Rectifier

1350'± 200'± from Pine No. 1 Tipples

1550'± 875'± from Pine No. 1 Tipples

SARAH A. ROBERTS  
124.35 AC.

JOSEPH GLENN  
72.42 AC.

MARY K. GLENN  
0.21 AC. Sur.

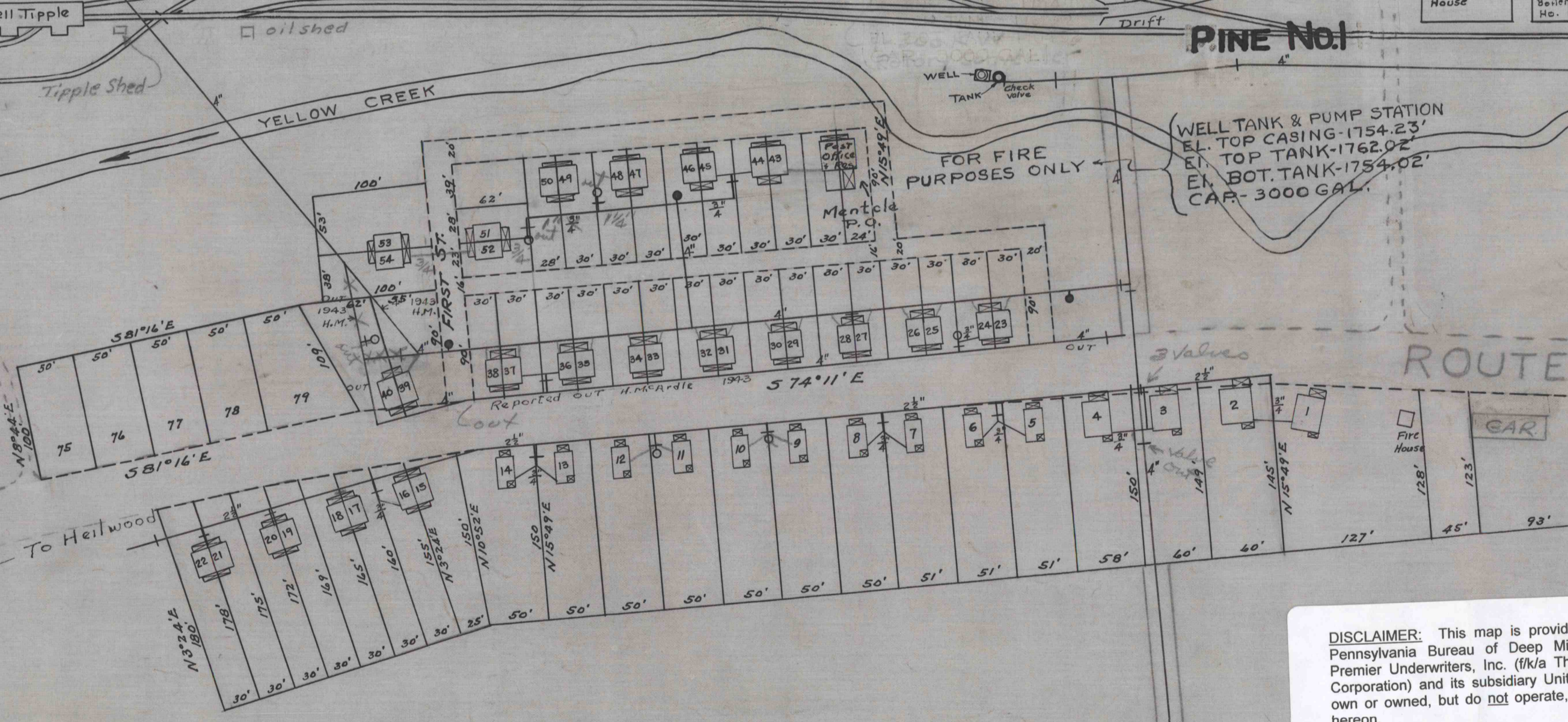

DISCLAIMER: This map is provided as a courtesy to the Pennsylvania Bureau of State Maps. It is not intended to be used for any purpose other than that for which it was prepared. Any person who uses this map for any other purpose does so at their own risk. The Pennsylvania Bureau of State Maps and the American Paper Underwriters, Inc. make no warranty, representation, or agreement of any kind, and assume no liability for any errors or omissions, or for any consequences arising from the use of this map.

FOR FIRE PURPOSES ONLY  
WATER TANK - 189102  
EL. TOP TANK - 187311  
CAR - 10,000 GAL.

S.B. GRIFFITH  
93.906 AC. Sur.

W. H. MARTIN  
183.83 AC.

ROBERT MITCHELL  
Fee 44.97 AC.

MAP SHOWING  
WATER LINES & SEWER LINES  
CLEMENT PLANT  
OF  
RED LANDS COAL CO.  
HEILWOOD DIVISION  
HEILWOOD IND. CO. PA.

SCALE 1"=100' DEC. 1929

LEGEND  
Water Lines (dashed)  
Sewer Lines (solid)  
Water Hydrant  
Fire Hydrant  
Cistern  
Deep Well

NAME OF TRACT	ACRES SOLD TENNSITE	ACRES RESERVED TENNSITE	ACRES PLANT SITE	ACRES TOTAL
S.B. GRIFFITH	6.90	2.38	17.20	26.48
ROBERT MITCHELL			10.19	10.19
MARY K. GLENN			0.21	0.21
GRAND TOTALS	6.90	2.38	27.60	36.88