



HOMER BASHFORTH
 75.14 ACRES DEED FEBRUARY 26, 1943
 FORMERLY - EMMA W. SMAL.

HOMER BASHFORTH TRACTS
 HEMPFIELD TWP., WESTMORELAND CO. PA.
 DEEP MINING AND
 PROPOSED STRIPPING
 OPERATION NO. 1.
S. & M. COAL CO.
 SCALE ~ 1"=100'
 JULY 22, 1949
 REVISED TO OCT. 7, 1950
 ENGINEER
Paul W. ...

STRIPPING DATA.
 STARTED OPERATION - JULY 11, 1949
 NET TONS COAL - 4430
 ACRES COAL EXTRACTED - 1.07
 AVERAGE OVERBURDEN - 36"
 AVE. COAL THICKNESS - 4.80
 ACRES OF LAND AFFECTED - 4.80
 READY FOR FINAL INSPECTION - OCT. 7, 1950
 COMPLETION REPORT - OCT. 14, 1950
 OPERATION FILE NO. 973; BOND NO. 889.

DISCLAIMER: This map is provided as a courtesy to the Pennsylvania Bureau of Deep Mine Safety by American Premier Underwriters, Inc. (the Pennsylvania Bureau of Deep Mine Safety is a subsidiary of American Premier Underwriters, Inc. and is not a separate legal entity). American Premier Underwriters, Inc. and United National Coal Company do not warrant, represent or guarantee the accuracy or completeness of the map or the data thereon for any purpose, and assume no liability for any damage or liability arising from its use. American Premier Underwriters, Inc. and United National Coal Company are not responsible for any damage or liability arising from its use.

HOMER BASHFORTH
 FORMERLY - GEORGE F. KEATLEY
 64.3 A. DEED - JANUARY 11, 1949

24" COVER
 D.M. NO. 2
 DATE - 12-16-47
 COAL - 1153.2 - 137R.

12" DRILLED WITH AUGERS
 DATE - 12-16-47
 COAL SHOULD BE AT 1150.0 OR 5' BELOW SURFACE

6" SURFACE
 1-2 SANDSTONE
 1-4 YELLOW CLAY
 0-8 BROWN SANDY SHALE
 3-4 COAT YELLOW CLAY
 3-0 COAL
 BLOCKED CORE BARREL
 PREPARED DRILLING.

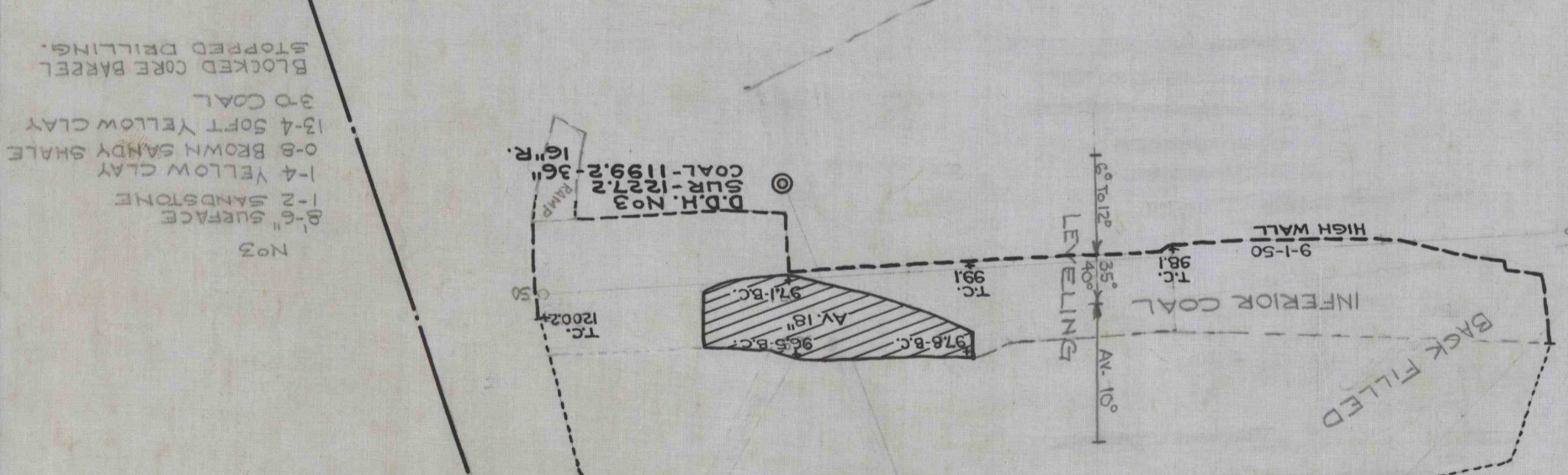

LEGEND:

- BLACK FILLED - ROCK
- INFERRIORE COAL - COAL
- D.M. NO. 1 - DRILL HOLE
- D.M. NO. 2 - DRILL HOLE
- 1-2 SANDSTONE - SANDSTONE
- 1-4 YELLOW CLAY - YELLOW CLAY
- 0-8 BROWN SANDY SHALE - SANDY SHALE
- 3-4 COAT YELLOW CLAY - COAT YELLOW CLAY
- 3-0 COAL - COAL