

AA-5

DARMAC NO. 3 MINE  
PLUMBREEK & ARMSTRONG TWP'S  
ARMSTRONG & INDIANA COS.  
SCALE: 1" = 80'

TJS MINING INC.'S CORPORATION  
PROJECTION: NAD 83  
MINING PERIOD: 3/1/99 TO 11/1/99  
SHEEVY DATE: 4/3/99

UPPER FREEPORT SEAM

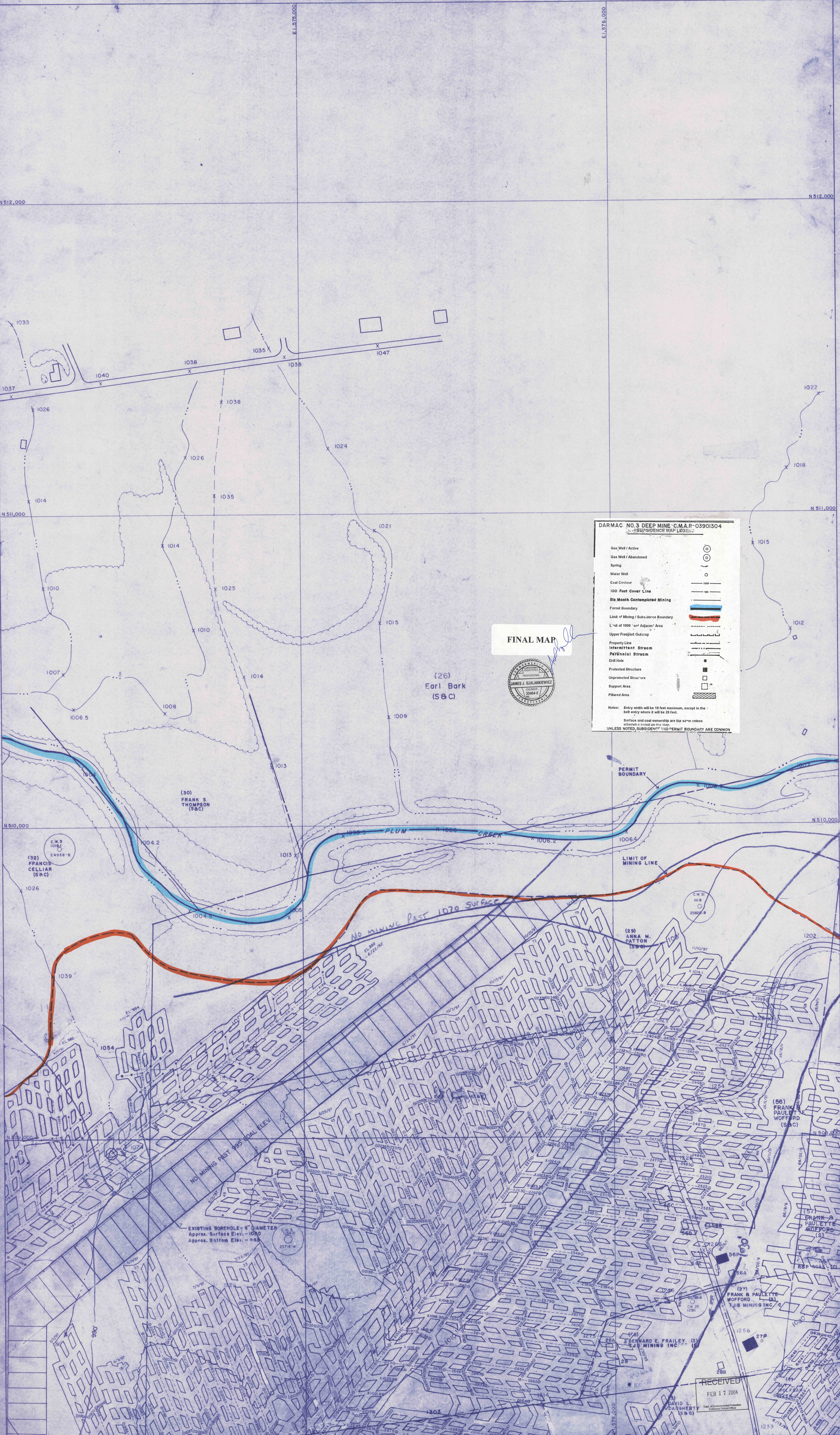

FINAL MAP  
JAMES J. SZALANKIEWICZ  
PROFESSIONAL  
SURVEYOR  
INDIANA

**DARMAC NO. 3 DEEP MINE C.M.A.P. 0390304**  
SUBSIDENCE MAP LEGEND

- Gas Well / Active
- Gas Well / Abandoned
- Spring
- Water Well
- Coal Contour
- 100 Feet Cover Line
- Six Month Contemplated Mining
- Permit Boundary
- Limit of Mining / Subsurface Boundary
- Limit of 1000' "out Adjacent" Area
- Upper Freeport Outcrop
- Property Line
- Intermittent Stream
- Perennial Stream
- Dirt Hole
- Protected Structure
- Unprotected Structure
- Support Area
- Piled Area

Notes: Entry width will be 19 feet maximum, except in the belt entry where it will be 20 feet.  
Surface and coal ownership are the same unless otherwise noted on this map.  
UNLESS NOTED, SUBSIDENCE AND PERMIT BOUNDARY ARE COMMON

RECEIVED  
FEB 17 2004  
DAVID L. DAUGHERTY  
Chief of Environmental Protection  
Indiana Department of Environment

AA-5