

35

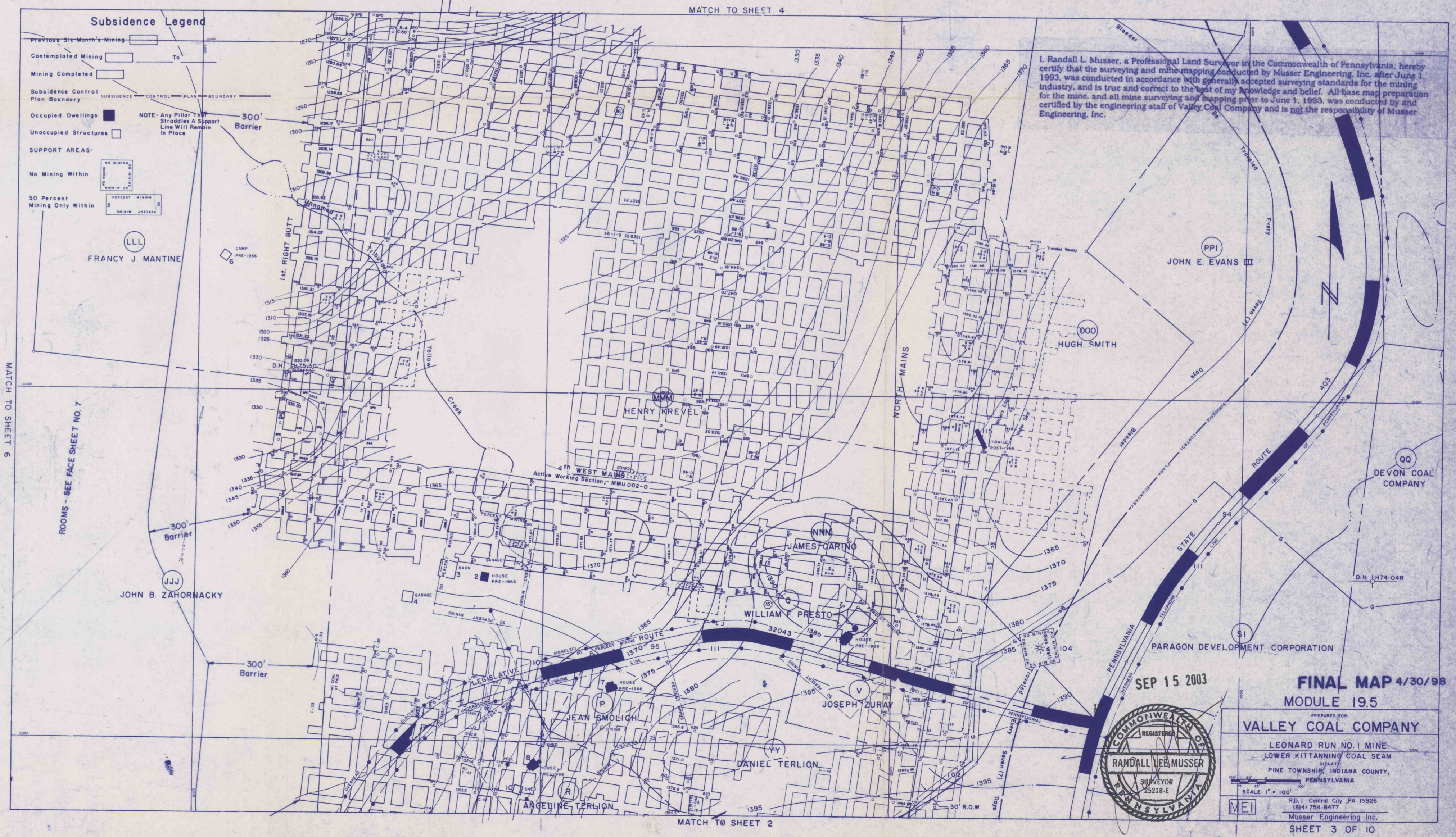

I, Randall L. Mussey, a Professional Land Surveyor in the Commonwealth of Pennsylvania, hereby certify that the surveying and mine mapping conducted by Mussey Engineering, Inc. after June 1, 1993, was conducted in accordance with generally accepted surveying standards for the mining industry, and is true and correct to the best of my knowledge and belief. All base map preparation for the mine, and all mine surveying and mapping prior to June 1, 1993, was conducted by and certified by the engineering staff of Valley Coal Company and is not the responsibility of Mussey Engineering, Inc.