

MUNONGAHELI COUNTY - WEST VIRGINIA
GREENE COUNTY - PENNSYLVANIA

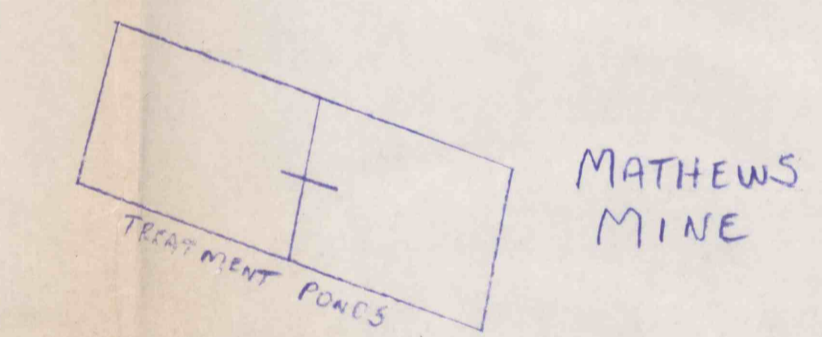

CROOKED RUN



MATHEWS MINE

SURFACE: HERSCHEL MATHEWS
SEW COAL: COFFERDE CORP

NOTE: AREAS WITHIN 50' MINING ZONES
1) ENTRIES, CROSSCUTS OR PILLAR SPLITS WILL BE 17 1/2 FEET WIDE MAXIMUM.
2) WHEN SPLITTING PILLAR BLOCKS, UNIFORM SUPPORT BLOCKS WILL BE LEFT.
3) IF THE 50' LINE TOUCHES A COAL BLOCK THE ENTIRE BLOCK WILL BE LEFT FOR SUPPORT UPON RETREAT MINING.

NOTE WITHIN 100 FOOT COVER LINE
1. BELT-TAKE ENTRY CAN BE 21 FEET WIDE BUT ALL OTHER ENTRIES AND CROSSCUTS MUST BE 18 FEET OR LESS.
2. ONLY 1ST MINING IS ALLOWED! NO PILLAR BLOCK SPLITTING OR FULL BILLING IS ALLOWED.
3. ADDITIONAL ROOF SUPPORT WILL BE ADDED UNDER THE STREAM BEDS, ROAD AND ALL INTERSECTIONS.
4. THE ONLY MINING DONE WILL BE ACCORDING TO THE MINING PRACTICES SHOWN ON THIS MAP.

MARTHA B MINE
(ABANDONED)

SURFACE: BURKEY LILLEY
SEW COAL: LEE LAND MINERALS

- Outline of mining property
- Outline of mining completed areas
- 1 Protected surface structure (75'-166' house or other structure)
- 2 Dwelling completed after 166 or commercial structure
- 3 Shed, barn or abandoned house
- Protected surface structure 500' or less mining zone
- Outline of mining area for period 6-1-94 to 12-1-94
- Permanent air stoppings
- Mine air regulator
- Mine air overcast
- Engineer surveying stations
- Engineer elevation locations
- Contours of bottom of coal seam
- Mining height of entry
- Air door or air lock
- Oil or gas well
- Proposed final mine seals
- Outline of No Mining area
- Outline of 5 Year Mining Plan

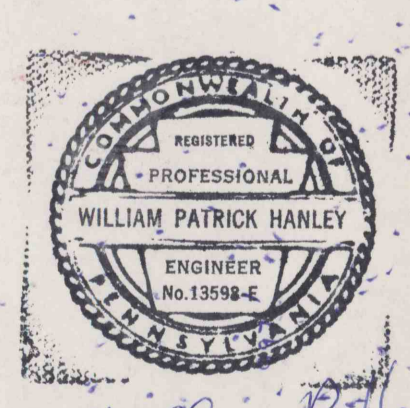

William Patrick Hanley

SHEET NO. 2A

DUNKARD MINING CO
DUNKARD MINE NO. 2-36 01301
DUNKARD TWP - GREENE CO - PA
SCALE: 1" = 100' SEWICKLEY SEAM
SUBTRACT 50 FEET FROM THE SEWICKLEY COAL ELEVATIONS SHOWN IN DUNKARD AND FRANCIS MINES TO GET SEWICKLEY COAL ELEVATIONS ABOVE SEA LEVEL.

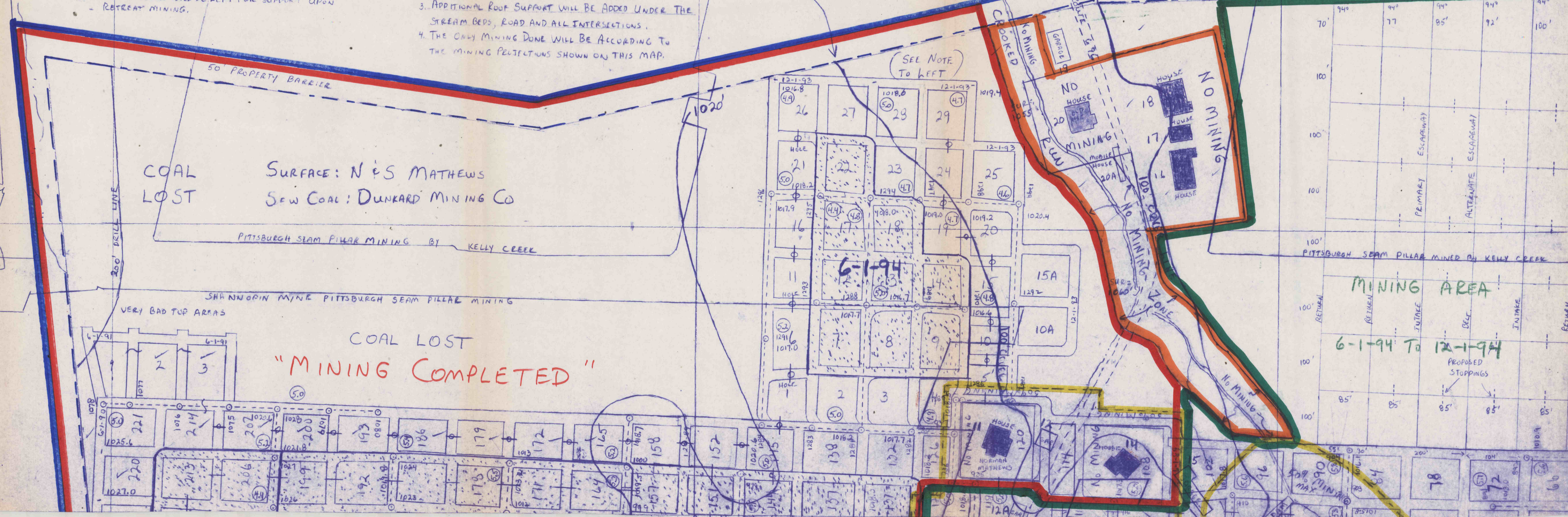

COAL LOST SURFACE: N & S MATHEWS
SEW COAL: DUNKARD MINING CO

COAL LOST
"MINING COMPLETED"

MINING AREA
6-1-94 TO 12-1-94
PROPOSED STOPPINGS