

- MINE MAP LEGEND:**
- Mine Property Outline
 - Conveyor Belt
 - Mine Track
 - Feeder Cable or Trolley Line
 - Intake Air Escapeway
 - Alternate Escapeway
 - Intake Air
 - Return Air
 - Permanent Air Stoppings
 - Permanent Air Stoppings With Door
 - Mine Air Regulator
 - Mine Air Overcast
 - Temporary Air Check
 - Fire Retardant Line Curtain
 - Engineer Surveying Stations
 - Bottom Sewickley Coal Elevation Contours
 - Mining Height
 - Door
 - Bleeder Evaluation Point
 - Belt Transfer Point
 - CO Monitoring Point
1. There are two production sections in the mine.
 2. All permanent air stoppings, overcasts and man-doors made of non-combustible material.
 3. All temporary air checks and line curtains are made of fire retardant materials.
 4. The Pittsburgh Seam 120 feet below has been partially mined by the Shannopin Mine.

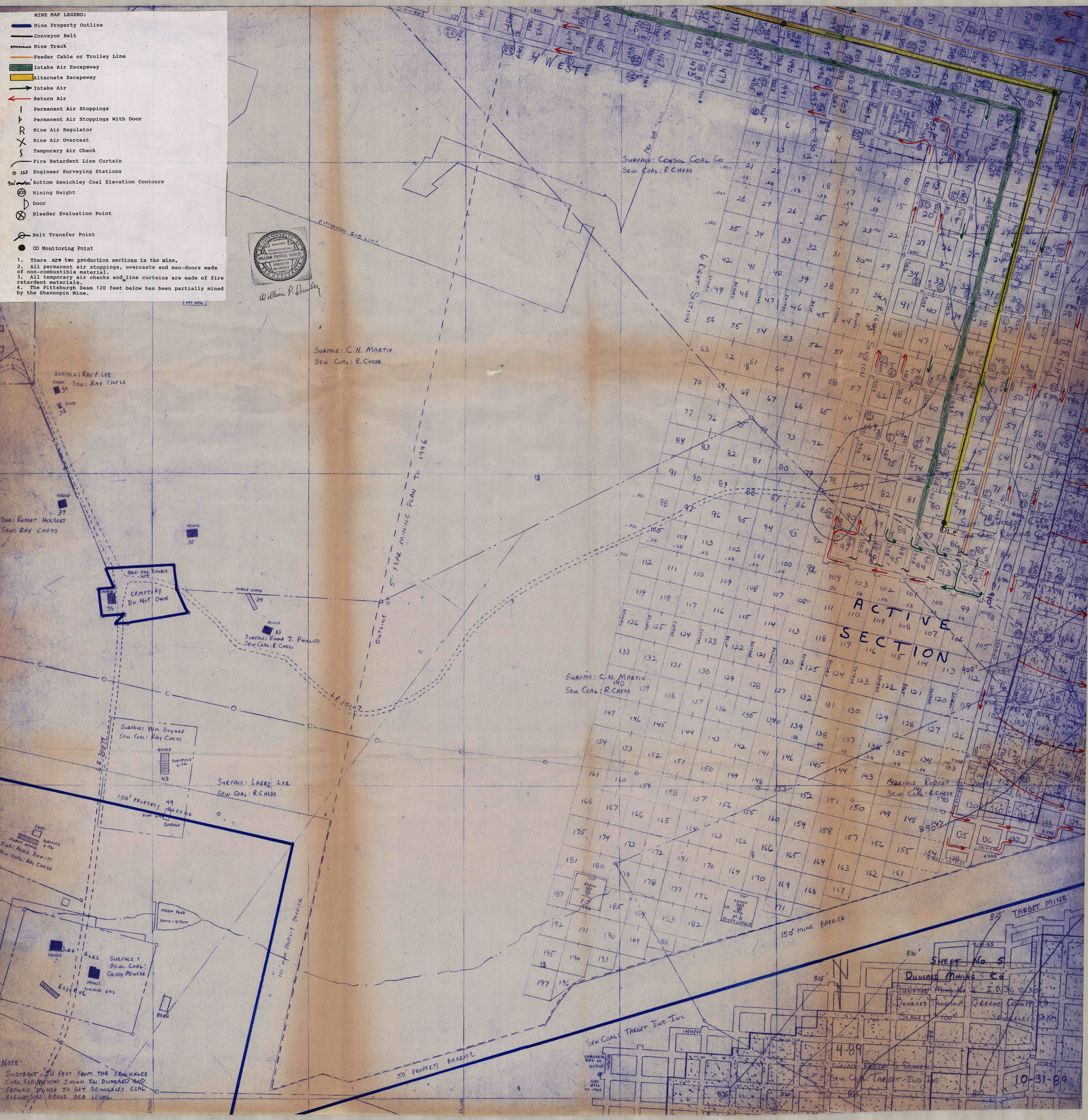

William P. Harey



NOTE:
 SUBTRACT 50 FEET FROM THE SEWICKLEY COAL ELEVATIONS SHOWN IN DUNBAR AND FRANCIS TOWNSHIP TO GET SEWICKLEY COAL ELEVATIONS ABOVE SEA LEVEL.

SHEET No 5
DUNBAR MINING Co
 DUNBAR MINE No 2 - I.D. 36, 0, 30
 DUNBAR TOWNSHIP GREENE COUNTY
 SEWICKLEY SEAM
 10-31-89