

FLOODED

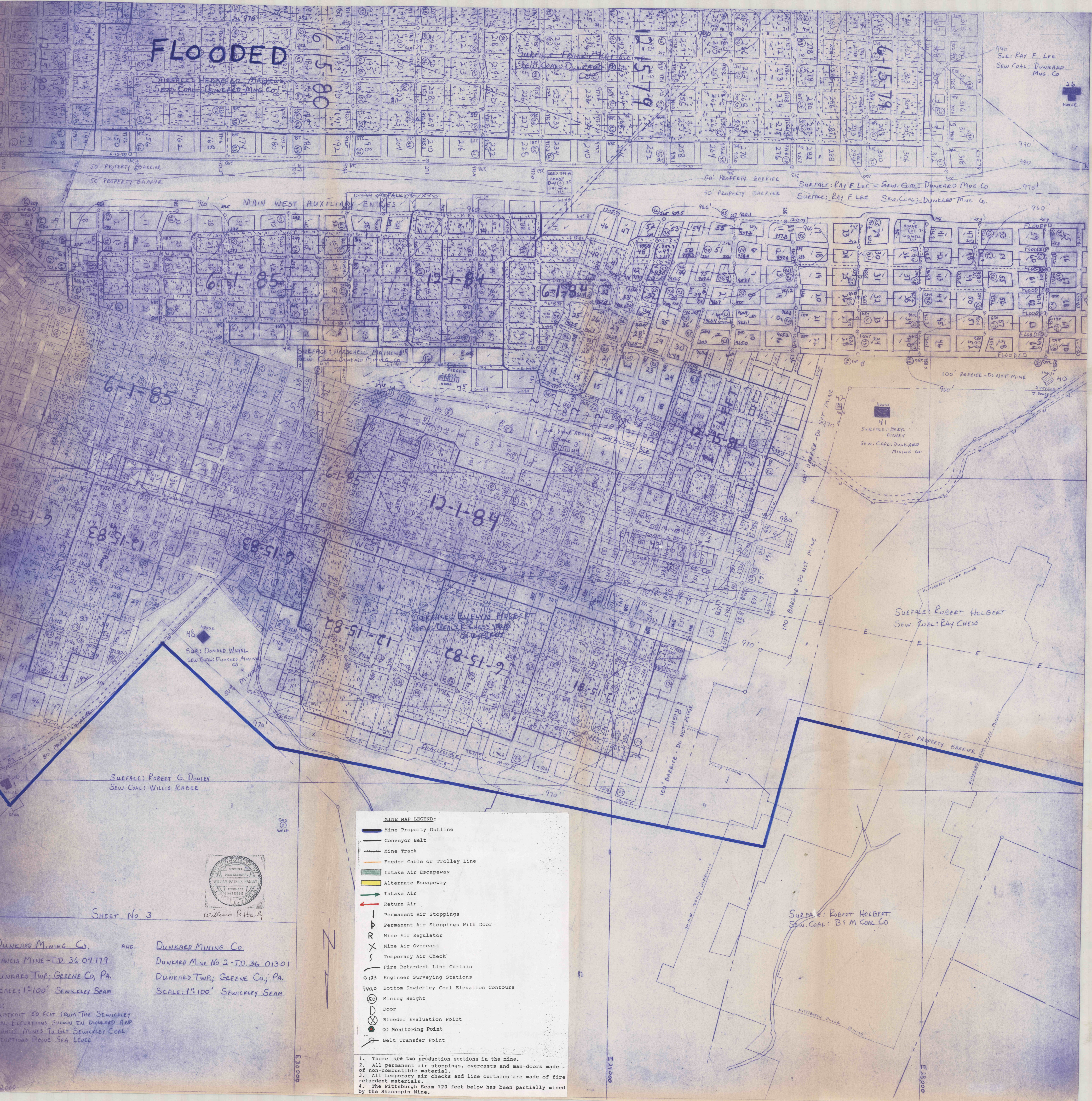

SURF: RAY F. LEE  
SEW. COAL: DUNKARD MNG CO



990  
980

50' PROPERTY BARRIER  
SURFACE: RAY F. LEE - SEW. COAL: DUNKARD MNG CO  
SURFACE: RAY F. LEE - SEW. COAL: DUNKARD MNG CO

MAIN WEST AUXILIARY ENTRIES

100' BARRIER - DO NOT MINE

SURFACE: ROBERT HOLBRET  
SEW. COAL: RAY CHES

HOUSE  
SURF: DONALD WHYTEL  
SEW. COAL: DUNKARD MINING CO

SURFACE: ROBERT G. DONLEY  
SEW. COAL: WILLIS RADER

SURFACE: ROBERT HOLBRET  
SEW. COAL: B. M. COAL CO

MINE MAP LEGEND:

- Mine Property Outline
- Conveyor Belt
- Mine Track
- Feeder Cable or Trolley Line
- Intake Air Escapeway
- Alternate Escapeway
- Intake Air
- Return Air
- Permanent Air Stoppings
- Permanent Air Stoppings With Door
- Mine Air Regulator
- Mine Air Overcast
- Temporary Air Check
- Fire Retardent Line Curtain
- Engineer Surveying Stations
- Bottom Sewickley Coal Elevation Contours
- Mining Height
- Door
- Bleeder Evaluation Point
- CO Monitoring Point
- Belt Transfer Point

1. There are two production sections in the mine.
2. All permanent air stoppings, overcasts and man-doors made of non-combustible material.
3. All temporary air checks and line curtains are made of fire retardent materials.
4. The Pittsburgh Seam 120 feet below has been partially mined by the Shannopin Mine.

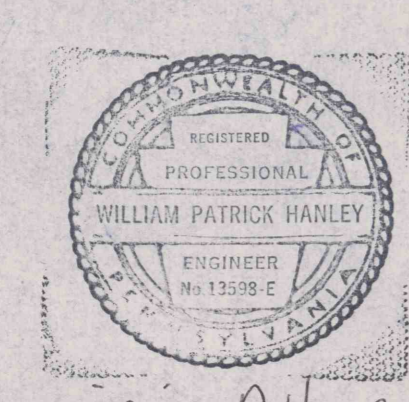

William P. Hanley

SHEET No 3

DUNKARD MINING Co. AND DUNKARD MINING Co.  
 FRANCIS MINE - I.D. 36 04779 DUNKARD MINE No 2 - I.D. 36 01301  
 DUNKARD TWP.; GREENE Co., PA. DUNKARD TWP.; GREENE Co., PA.  
 SCALE: 1"=100' SEWICKLEY SEAM SCALE: 1"=100' SEWICKLEY SEAM

TRACT 50 FEET FROM THE SEWICKLEY  
AL ELEVATIONS SHOWN IN DUNKARD AND  
MINES TO GET SEWICKLEY COAL  
ELEVATIONS ABOVE SEA LEVEL

E 30,000

E 20,000

E 10,000