

PHILLIP & S. J. McCAFFREY (#1510)  
287.725A

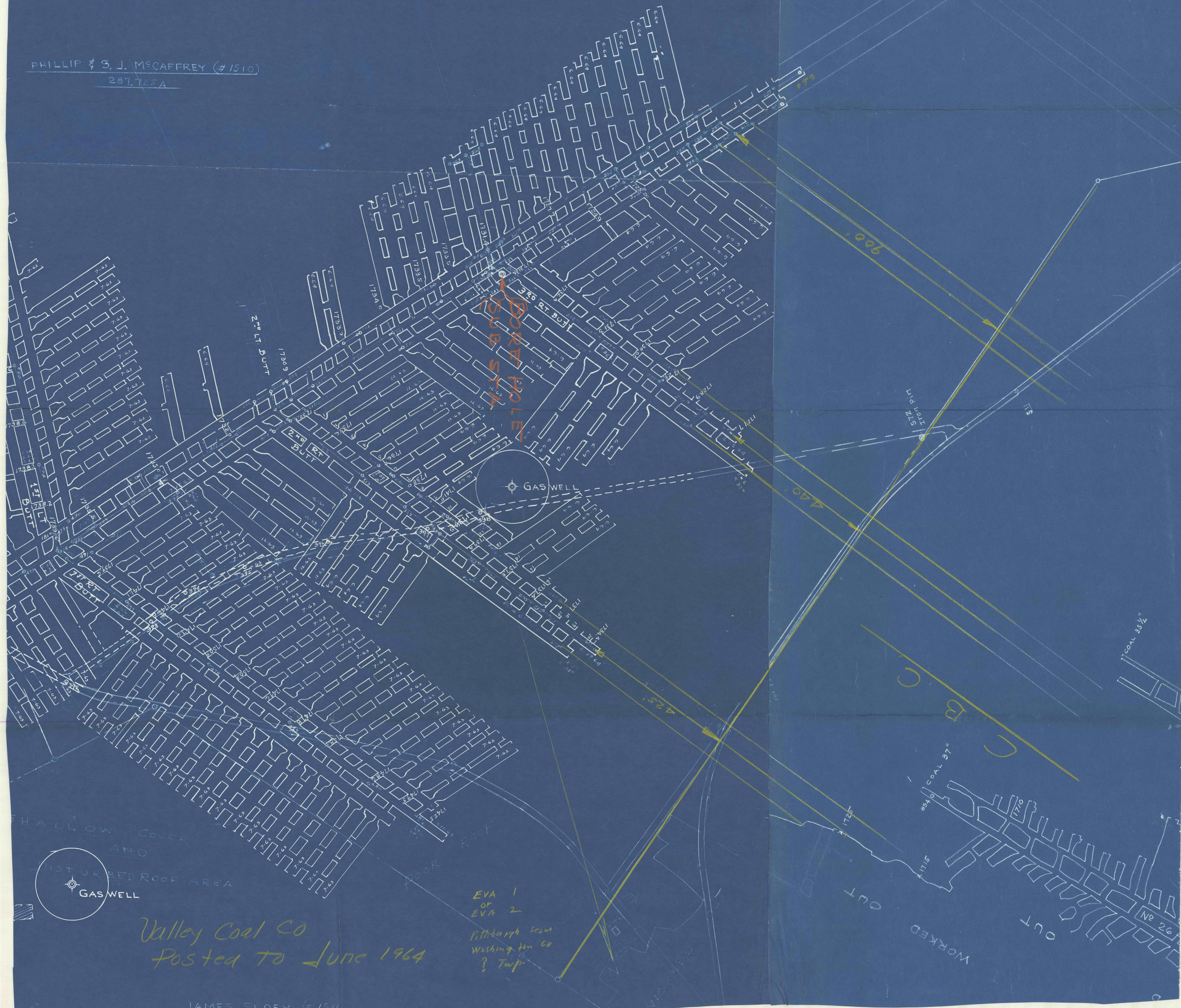

HALLOW COVER AND  
DISTURBED ROOF AREA  
GAS WELL

Valley Coal Co  
Posted to June 1964

EVA 1  
OR  
EVA 2  
Pittsburgh Sewer  
Washing ton Co  
? Turp

JAMES SLOEY (#1511)

WORKED  
OUT  
OUT  
No 26  
COAL 37"  
1710  
854