



McGuire Coal Co.
McGuire No. 1
1958 Annual
District 18

MAP of F. B. ROBBINS MINE "E" (UPPER FREEPORT) SEAM ON LANDS OF F. B. ROBBINS GALLITZIN TWP. CAMBRIA COUNTY

WORKINGS REVISED to Nov. 1, 1959

Traced from the

ORIGINAL BY

ROBERT L. ROWLAND #15535

REGISTER PROF. ENGINEER

PATTON PENNA.

SCALE 1" = 100'

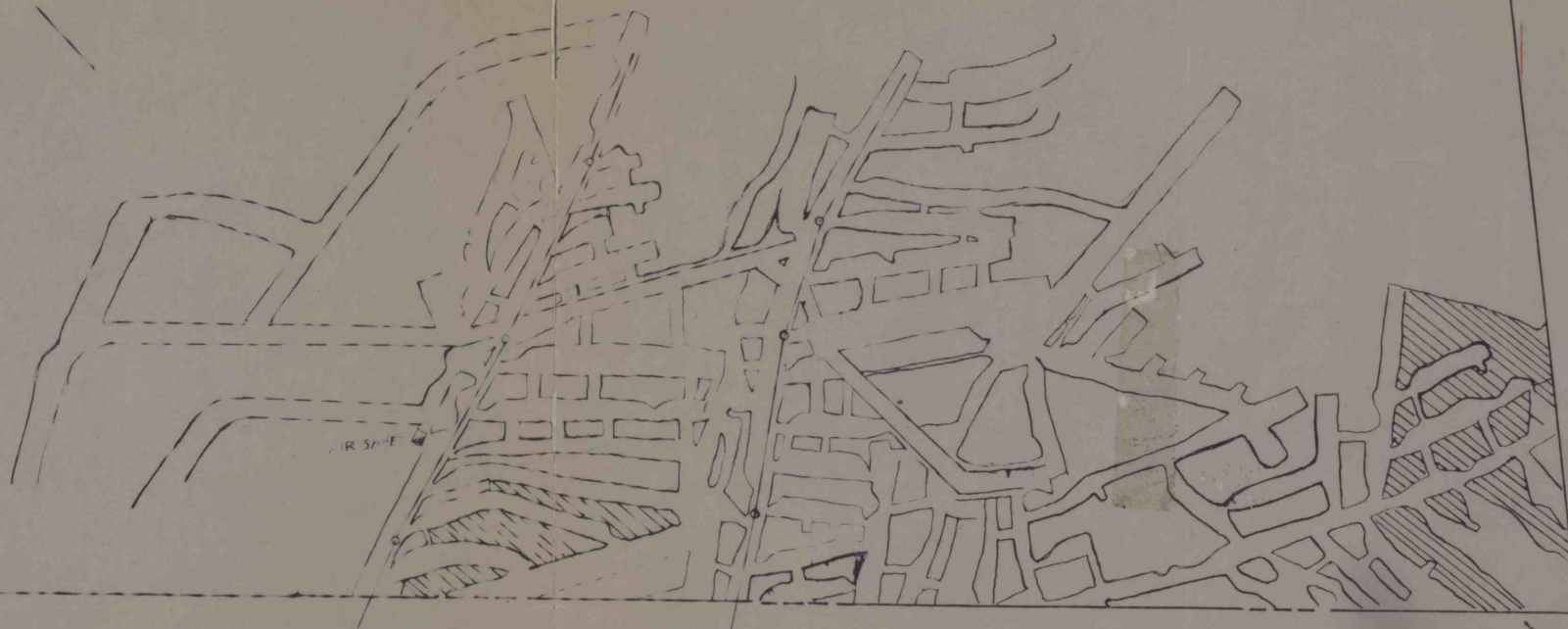

John A. McGuire Tract

Altoona Coal & Coke Co.