

MINE MAP
KENNEDY COAL COMPANY
MINE NO. 4 PORTAL NO. 2
NORTHWEST OF HAMILTON
PORTER TWP & PERRY TWP
JEFFERSON CO. PENNSYLVANIA
SCALE 1"=100' MARCH 1, 1974
FINAL CLOSURE MAP

SURVEY DATE 10/29/94

REGISTERED ENGINEER No. **VAN G. PLOCUS**
 ENGINEER
 25465
 7/1/74

LEGEND

- LOWER FREPORT COAL SEAM
- CONTEMPLATED MINING TO
- SUPPORT AREA
- PROTECTED STRUCTURES
- AREA MINED FROM To 10/29/94
- 50% MINING AREA
- MINING AREA COMPLETED
- PERMIT BOUNDARY LINE
- FINAL CLOSURE MAP

REVISED

JUNE 8, 1974	JAN. 12, 1984	JAN. 25, 1989
DEC. 31, 1974	JULY 12, 1984	JUN. 15, 1989
JULY 14, 1975	JAN. 6, 1985	MAY 17, 1993
JAN. 10, 1976	JAN. 8, 1985	OCT. 19, 1993
MAY 18, 1976	DEC. 31, 1985	MAY 12, 1994
JAN. 8, 1977	JULY 9, 1986	OCT. 31, 1994
JULY 2, 1977	JAN. 10, 1987	
DEC. 24, 1977	JULY 17, 1987	
JULY 1, 1978	OCT. 31, 1988	

REVISED PERMIT LINE
 PERIMETER LINE FOR SUBSIDIANCE
 COAL BARRIER LINE
 OUTCROP LINE "D" SEAM

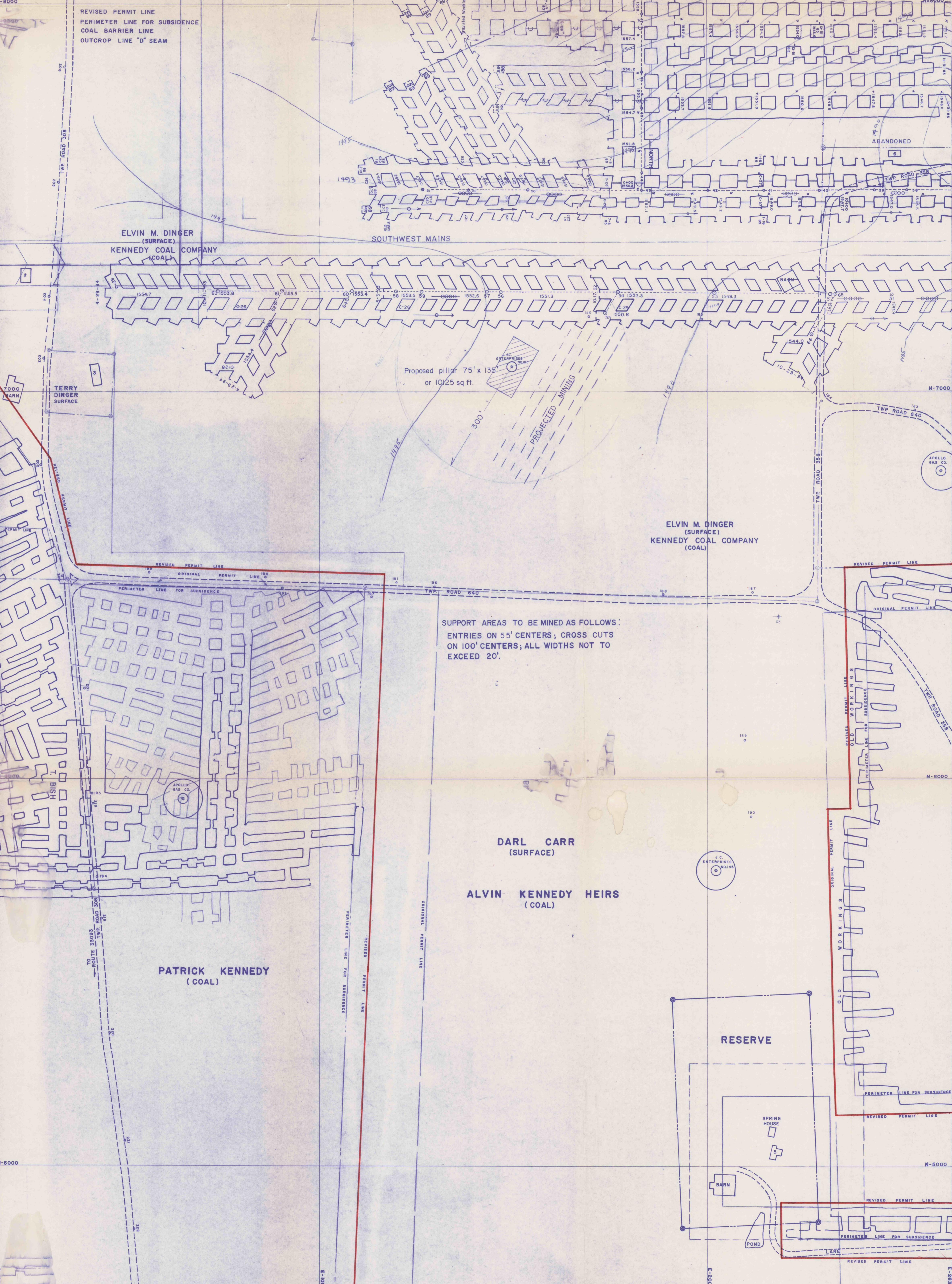

SUPPORT AREAS TO BE MINED AS FOLLOWS:
 ENTRIES ON 55' CENTERS; CROSS CUTS
 ON 100' CENTERS; ALL WIDTHS NOT TO
 EXCEED 20'.

DARL CARR (SURFACE)
 ALVIN KENNEDY HEIRS (COAL)

PATRICK KENNEDY (COAL)

RESERVE