

MINE MAP
KENNEDY COAL COMPANY
MINE NO. 4 PORTAL NO. 2
NORTHWEST OF HAMILTON
PORTER TWP & PERRY TWP
JEFFERSON CO. PENNSYLVANIA
SCALE 1"=100' MARCH 1, 1974

SURVEY DATE 4.30.92

REGISTERED ENGINEER No. Van G. Plocus

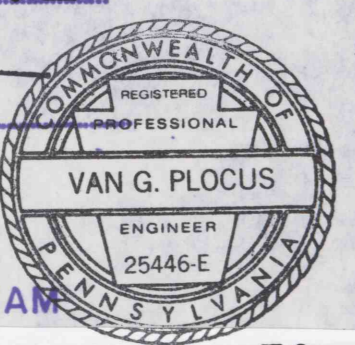

RECEIVED
MAY 6 1992
Dept. of Environmental Resources
McKurry District Office

LEGEND

- LOWER FREEPORT COAL SEAM
- CONTEMPLATED MINING MAY 7, 1992 TO NOV. 7, 1992
- SUPPORT AREA
- PROTECTED STRUCTURES
- AREA MINED FROM To April 30, 1992
- 50% MINING AREA
- MINING AREA COMPLETED
- PERMIT BOUNDARY LINE

REVISED		
JUNE 8, 1972	JAN. 12, 1984	JAN. 25, 1989
SEP. 21, 1976	JULY 12, 1984	JUN. 15, 1989
JULY 14, 1978	MAY 30, 1985	
JAN. 10, 1976	JUN. 8, 1985	
JULY 18, 1976	DEC. 31, 1985	
JAN. 8, 1977	JULY 9, 1986	
JULY 3, 1977	JAN. 10, 1987	
DEC. 24, 1977	JULY 17, 1987	
JULY 7, 1978	OCT. 31, 1988	

REVISED PERMIT LINE
 PERIMETER LINE FOR SUBSIDENCE
 COAL BARRIER LINE
 OUTCROP LINE "D" SEAM

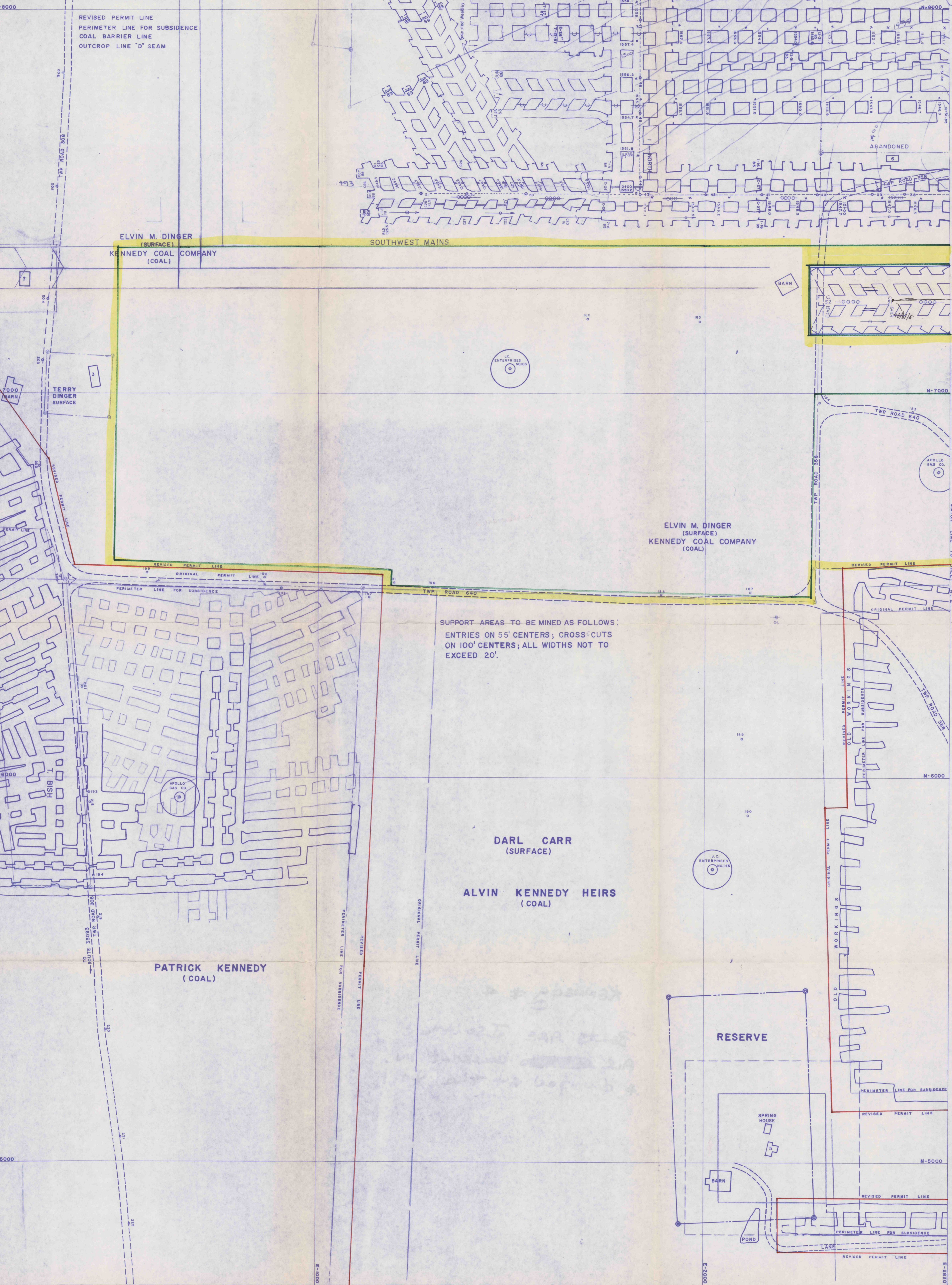

SUPPORT AREAS TO BE MINED AS FOLLOWS:
 ENTRIES ON 55' CENTERS; CROSS CUTS
 ON 100' CENTERS; ALL WIDTHS NOT TO
 EXCEED 20'.

DARL CARR
(SURFACE)

ALVIN KENNEDY HEIRS
(COAL)

PATRICK KENNEDY
(COAL)

RESERVE

SPRING HOUSE

BARN

POND