

**MINE MAP**  
**KENNEDY COAL COMPANY**  
**MINE No 4 PORTAL No 2**  
**NORTHWEST OF HAMILTON**  
**PORTER TWP & PERRY TWP**  
**JEFFERSON CO. PENNSYLVANIA**  
**SCALE 1"=100' MARCH 1, 1974**

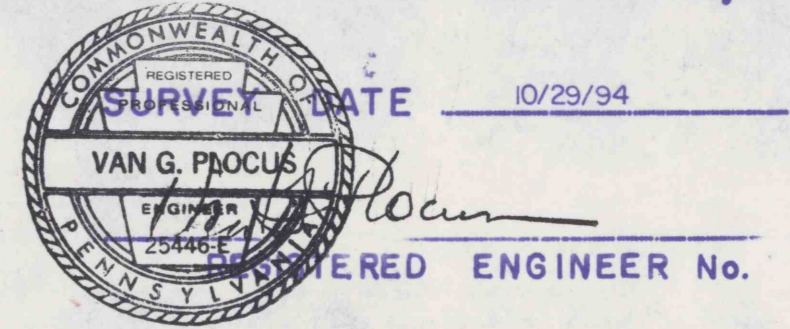

**FINAL CLOSURE MAP**

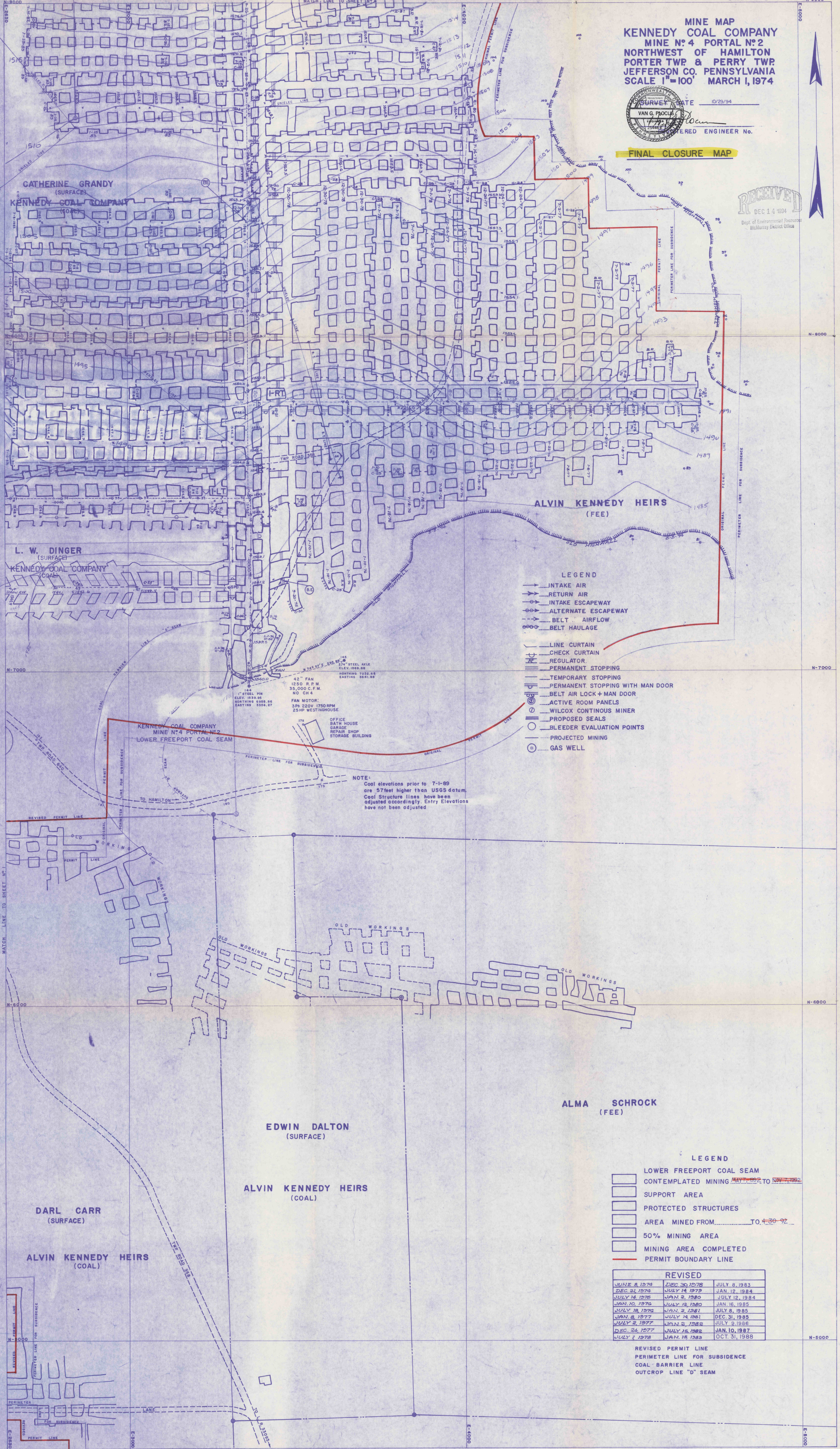
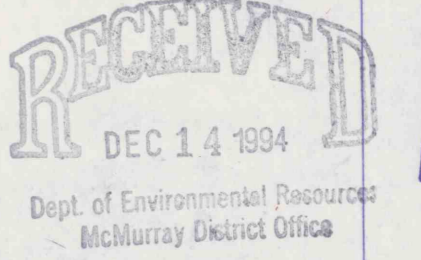

- LEGEND**
- INTAKE AIR
  - RETURN AIR
  - INTAKE ESCAPEWAY
  - ALTERNATE ESCAPEWAY
  - BELT AIRFLOW
  - BELT HAULAGE
  - LINE CURTAIN
  - CHECK CURTAIN
  - REGULATOR
  - PERMANENT STOPPING
  - TEMPORARY STOPPING
  - PERMANENT STOPPING WITH MAN DOOR
  - BELT AIR LOCK + MAN DOOR
  - ACTIVE ROOM PANELS
  - WILCOX CONTINUOUS MINER
  - PROPOSED SEALS
  - BLEEDER EVALUATION POINTS
  - PROJECTED MINING
  - GAS WELL

**NOTE:**  
 Coal elevations prior to 7-1-89 are 57 feet higher than USGS datum. Coal Structure lines have been adjusted accordingly. Entry Elevations have not been adjusted.

**ALMA SCHROCK (FEE)**

- LEGEND**
- LOWER FREEPORT COAL SEAM
  - CONTEMPLATED MINING ~~MAY 1, 1982 TO NOV 7, 1982~~
  - SUPPORT AREA
  - PROTECTED STRUCTURES
  - AREA MINED FROM ~~TO 4-30-92~~
  - 50% MINING AREA
  - MINING AREA COMPLETED
  - PERMIT BOUNDARY LINE

REVISED		
JUNE 8, 1974	DEC 30, 1978	JULY 8, 1983
DEC 21, 1974	JULY 14, 1979	JAN 12, 1984
JULY 14, 1975	JAN 2, 1980	JULY 12, 1984
JAN 10, 1976	JULY 12, 1980	JAN 16, 1985
JULY 18, 1976	JAN 2, 1981	JULY 8, 1985
JAN 8, 1977	JULY 14, 1981	DEC 31, 1985
JULY 2, 1977	JAN 2, 1982	JULY 9, 1986
DEC 24, 1977	JULY 16, 1982	JAN 10, 1987
JULY 1, 1978	JAN 15, 1983	OCT 31, 1988

- REVISED PERMIT LINE
- PERIMETER LINE FOR SUBSIDENCE
- COAL BARRIER LINE
- OUTCROP LINE "D" SEAM