

N 89° 28' 29" E

SURFACE OWNED BY KENNA METAL Co. LATROBE, PA.

COAL OWNED BY MRS. C.Y. WATSON - LATROBE, PA.

ALL SECOND MINING - NO SOLID COAL

NO SURFACE BUILDINGS

OPERATION FORMERLY - FRANCIS MINE - RIDGE COAL Co.

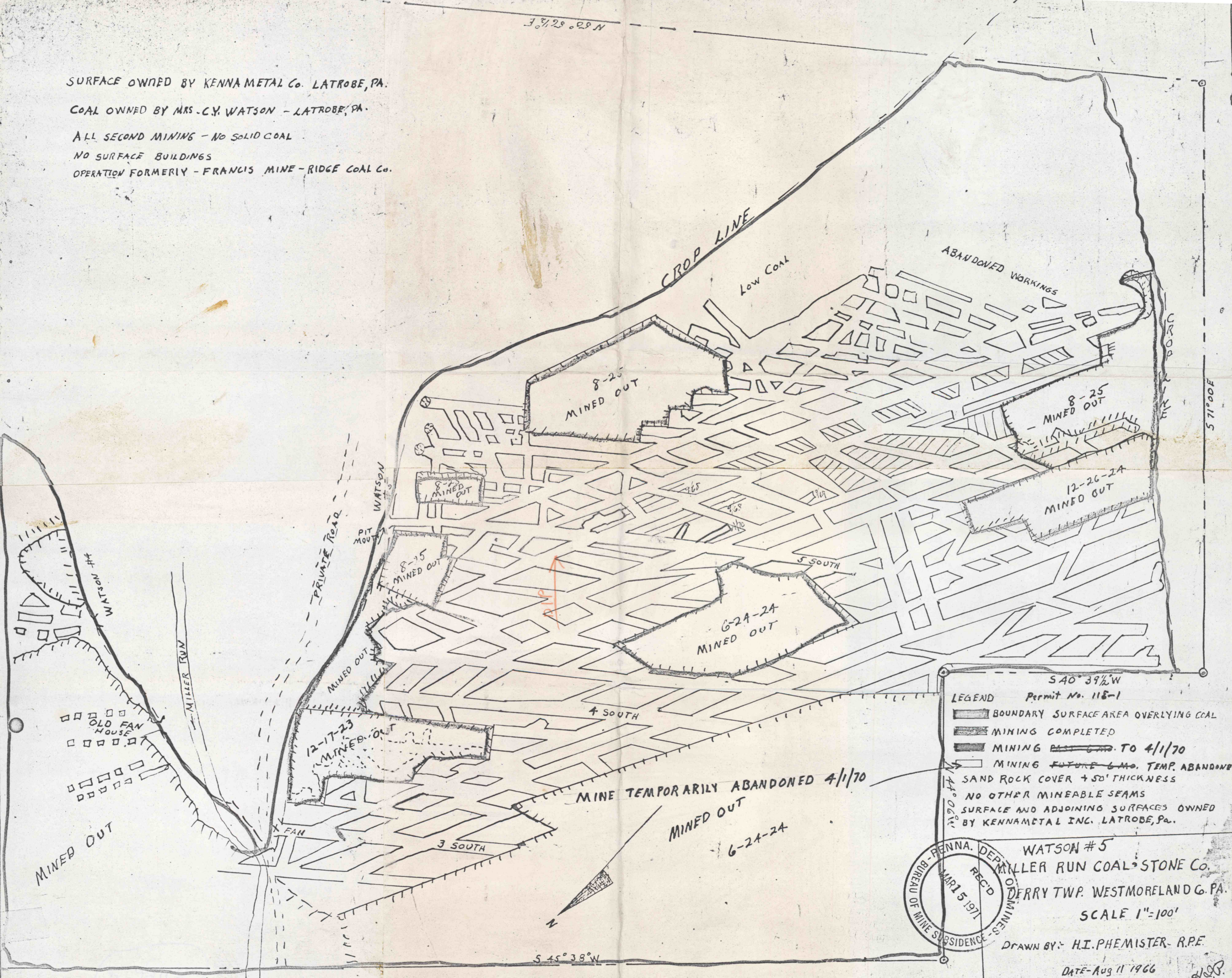

S 40° 39' 1/2" W
 Permit No. 118-1
LEGEND
 [Symbol] BOUNDARY SURFACE AREA OVERLYING COAL
 [Symbol] MINING COMPLETED
 [Symbol] MINING ~~PLANNED~~ TO 4/1/70
 [Symbol] MINING ~~PLANNED~~ 6 Mo. TEMP. ABANDONED
 SAND ROCK COVER 450' THICKNESS
 NO OTHER MINEABLE SEAMS
 SURFACE AND ADJOINING SURFACES OWNED
 BY KENNA METAL INC. LATROBE, PA.

WATSON #5
 MILLER RUN COAL & STONE Co.
 DERRY TWP. WESTMORELAND Co. PA.
 SCALE 1" = 100'
 DRAWN BY: H.I. PHEMISTER - R.P.E.
 DATE - Aug 11 1966

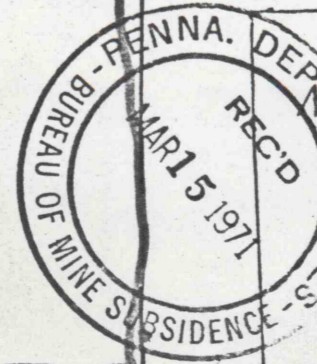

S 45° 38' W

S 71° 00' E