

B.M. - ON CONC AT RT SIDE OF DOOR
AT ENTRANCE TO FAN HOUSE.
ELEV - 1000.0 ASSUMED.

FORMERLY CAMBRIA IRON CO.

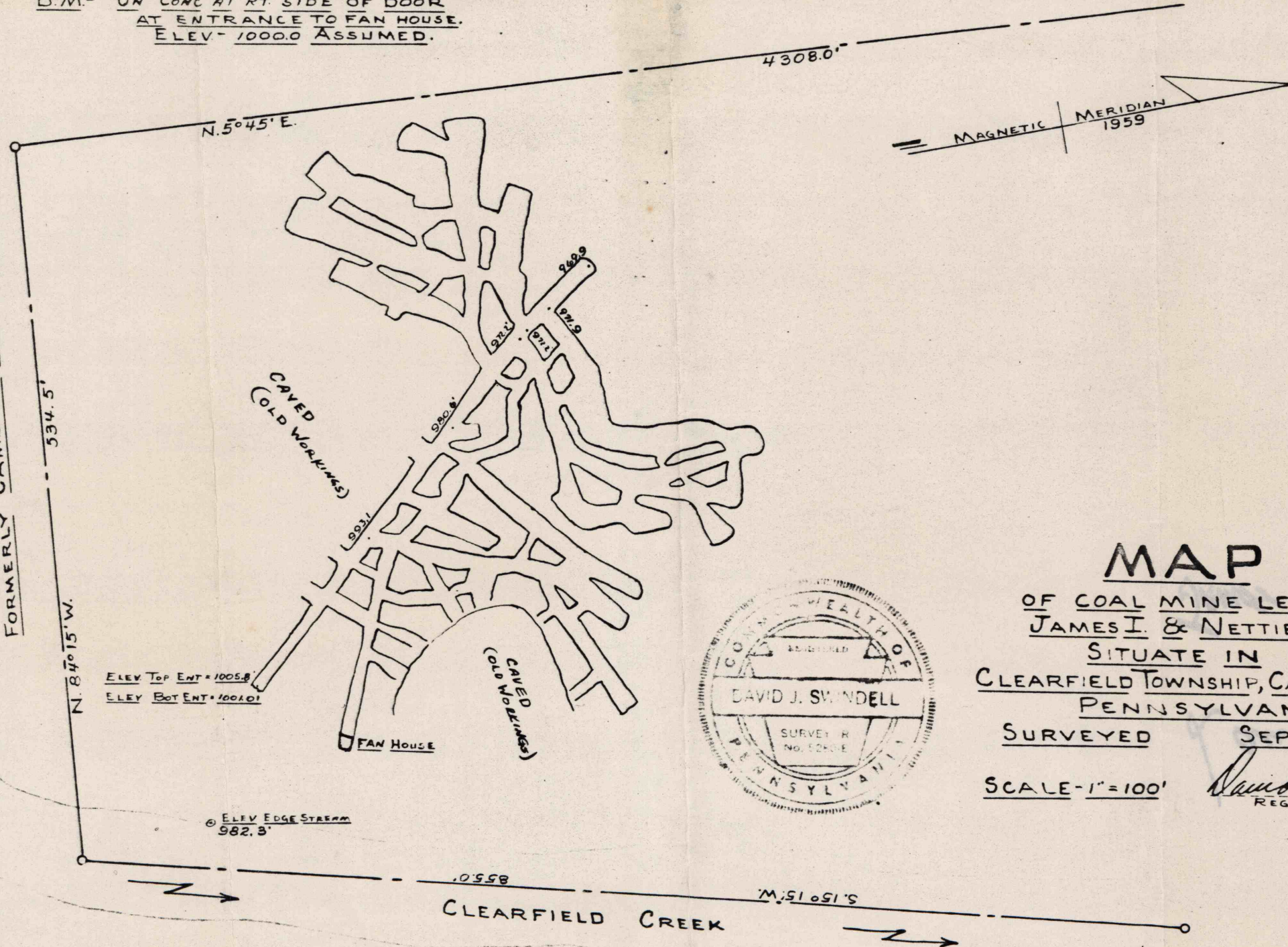

ELEV TOP ENT = 1005.8
ELEV BOT ENT = 1001.0

© ELEV EDGE STREAM
982.3'

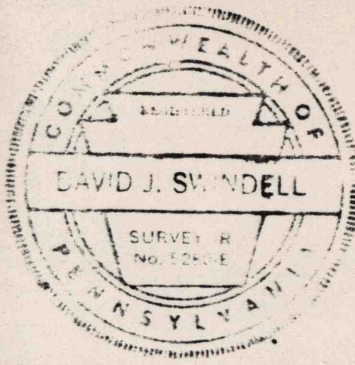

MAP
OF COAL MINE LEASED BY
JAMES I. & NETTIE V. SMITH
SITUATE IN
CLEARFIELD TOWNSHIP, CAMBRIA COUNTY
PENNSYLVANIA
SURVEYED SEPTEMBER 5, 1959
SCALE - 1" = 100'
David J. Swindell
REG. SURVEYOR