

— MAP OF "C" SEAM CANNEL COAL MINE —
 — OPERATED BY W. B. MARTELL —
 — GIRARD TOWNSHIP CLEARFIELD COUNTY PENNA. —
 — SCALE 1/2" = 100' — FEB. 21, 1955 —
 — BERNARD LUCAS ENGINEER —

HOME ESTATE

EDWARD MEROT ESTATE

A. A. MURRAY TRACT

HOME ESTATE
LUTZ COAL

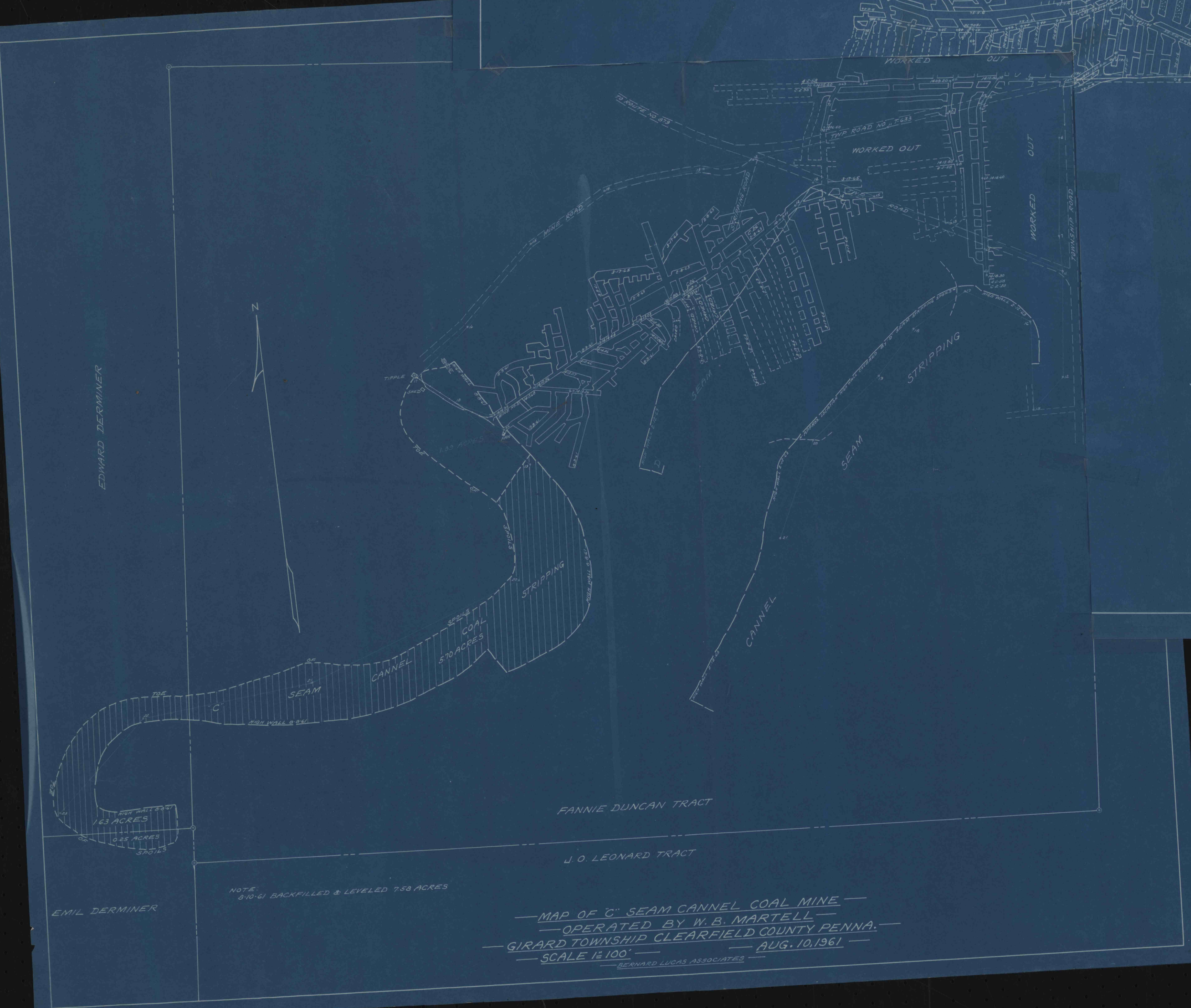

EDWARD DERMINER



FANNIE DUNCAN TRACT

J. O. LEONARD TRACT

EMIL DERMINER

NOTE:
8-10-61 BACKFILLED & LEVELED 7.58 ACRES

— MAP OF "C" SEAM CANNEL COAL MINE —
 — OPERATED BY W. B. MARTELL —
 — GIRARD TOWNSHIP CLEARFIELD COUNTY PENNA. —
 — SCALE 1/2" = 100' — AUG. 10, 1961 —
 — BERNARD LUCAS ASSOCIATES —