

Coal Rem Jan 1 1923
H 50

I, the undersigned, hereby certify that this tracing
is a true and correct copy of the original map of
RUTH MINE, and that the original map is true,
complete, and correct map and a survey of all the
excavations made in said abandoned mine.

Ray Van Bueckert
Engineer

Acknowledged before me a Notary Public
this 13th day of October, 1923.

Mildred J. Callahan

NOTARY PUBLIC
MY COMMISSION EXPIRES
MARCH 26, 1927

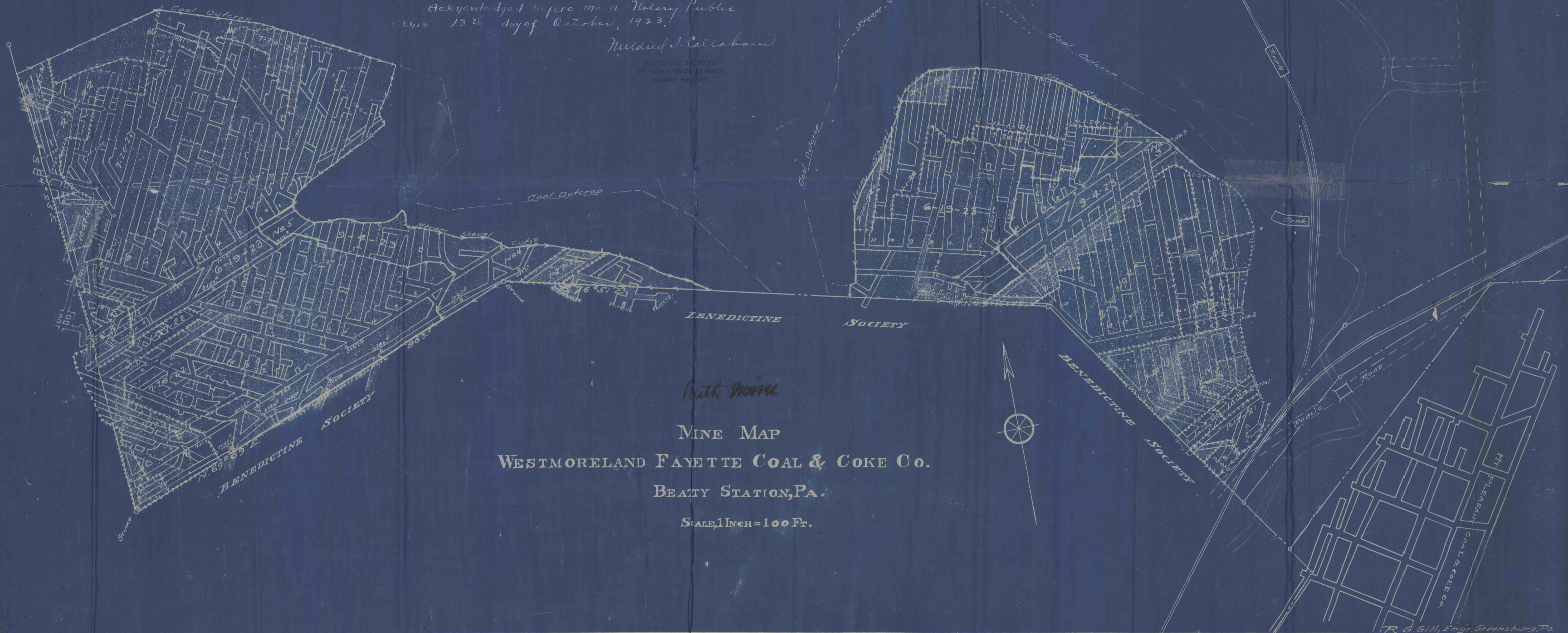

Ruth Mine

MINE MAP

WESTMORELAND FAYETTE COAL & COKE CO.

BEATY STATION, PA.

SCALE, 1 INCH = 100 FT.

R. G. Gill, Engr. Greensburg, Pa.