

**CLOYD S. ROUDABUSH ET AL.**

SHOWING PROPERTY & MINING OPERATIONS

IN THE

**B SEAM OF COAL**

SITUATE IN

CONEMAUGH TOWNSHIP, CAMBRIA COUNTY, PENNSYLVANIA

Scale 1" = 100'

J. E. Dickey & Co.  
Civil and Mining Engrs.  
Johnstown, Pa.

July 31, 1928.

J. C. STINEMAN EST.

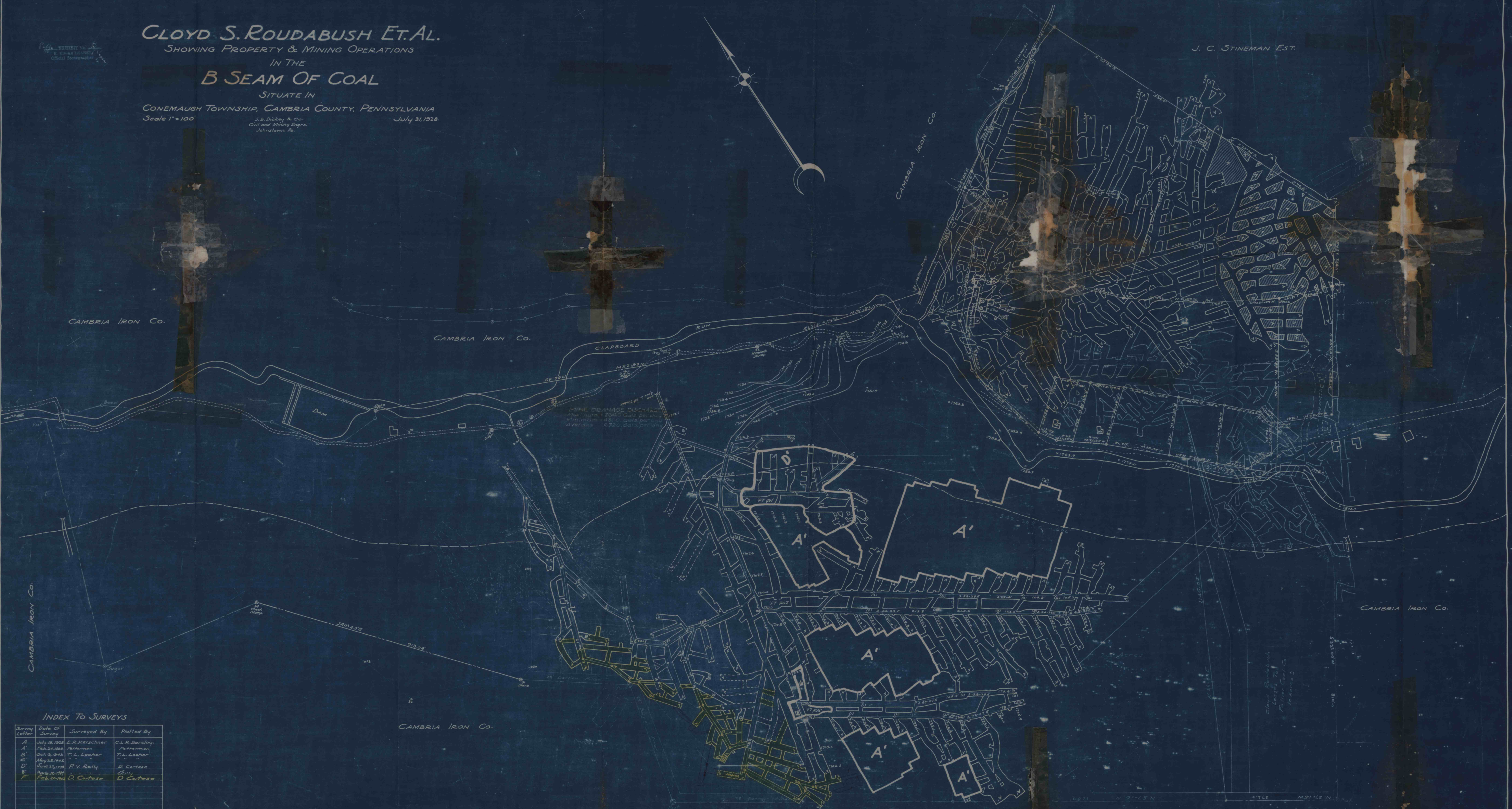

INDEX TO SURVEYS

Survey Letter	Date of Survey	Surveyed By	Plotted By
A	July 19, 1928	E. R. Kirschner	C. L. Roudabush
A'	Feb. 22, 1929	Stineman	Stineman
B	Oct. 6, 1923	T. L. Locher	T. L. Locher
B'	May 22, 1925	"	"
D	June 23, 1928	P. V. Reilly	D. Cortese
E	Aug. 21, 1929	"	Gilly
F	Feb. 20, 1928	D. Cortese	D. Cortese