

MAP SHOWING RIVER HILL NO. 1 B. SEAM MINE  
OPERATED BY RIVER HILL COAL COMPANY INC.  
GOVINGTON TWP. CLEARFIELD COUNTY, PENNA.  
SCALE 1/4" = 100'  
SEPT. 3, 1965  
BERNARD LUCAS ASSOCIATES

FIELD COPY

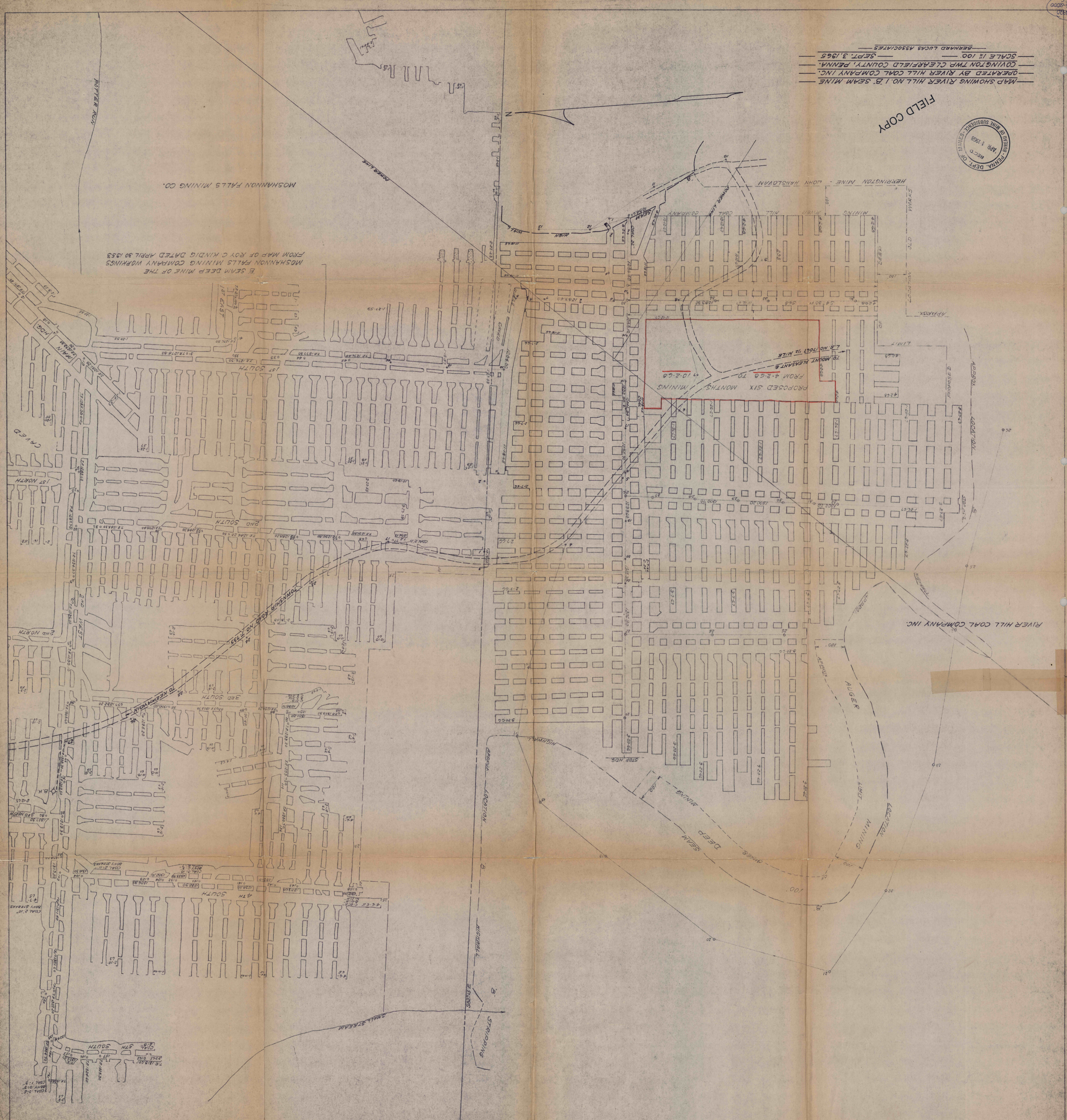

B SEAM DEEP MINE OF THE  
MOSHANNON FALLS MINING COMPANY WORKINGS  
FROM MAP OF ROY C KINDIG DATED APRIL 30 1953  
MOSHANNON FALLS MINING CO.

PROPOSED SIX MONTHS  
MINING  
FROM 4-2-68 TO  
10-2-68  
TO MOUNT PLEASANT  
1/4 SECTION 10A MILE

RIVER HILL COAL COMPANY INC.

AUGER

DEEP SEAM MINING

STRAIGHTING

