

J. HAROLD & MARIE MCFADDEN

J. HAROLD & MARIE MCFADDEN

CLAIR N. WRIGGLESWORTH

EDWIN W. & MARTHA M. PENTZ  
FEE DEED  
38 Acres

J. HAROLD & MARIE MCFADDEN

X - SECTION OF HIGHWALL AT MINE ENTRY

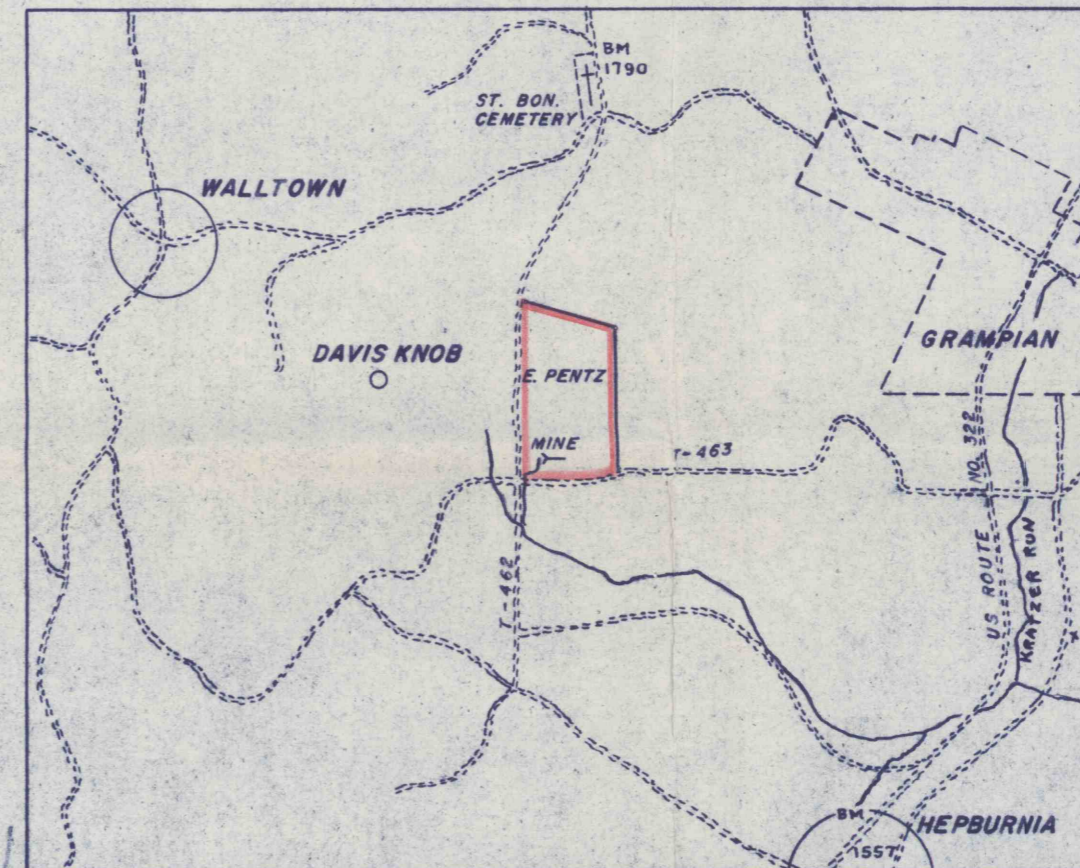
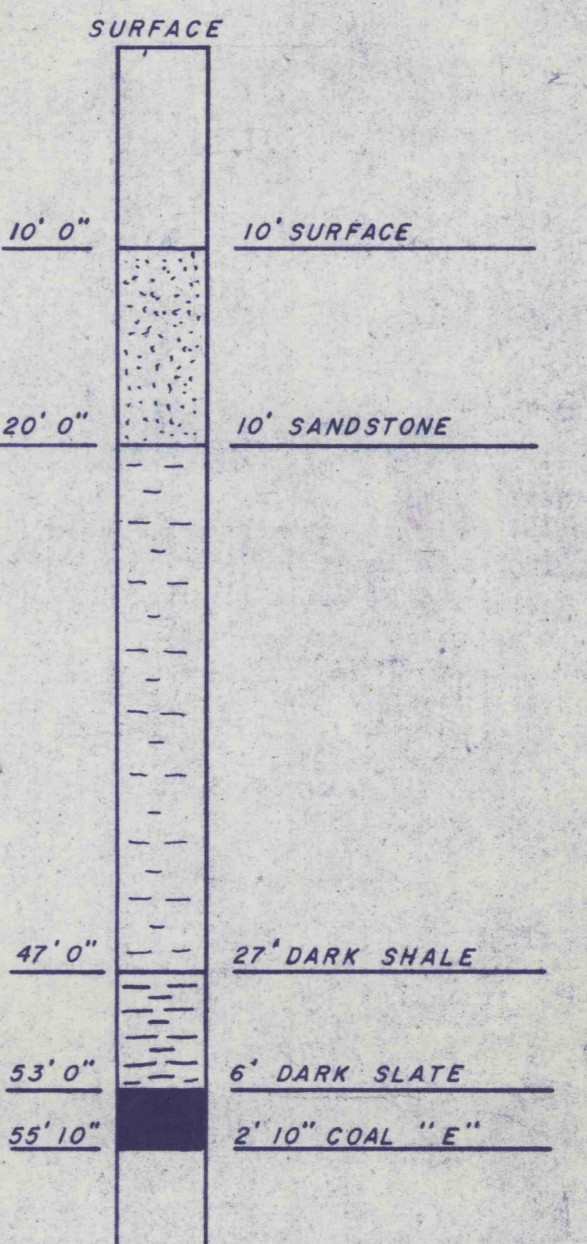

LOCATION MAP  
1" = 2400'

I THE UNDERSIGNED HEREBY CERTIFY THAT THIS MAP IS CORRECT  
SHOWS TO THE BEST OF MY KNOWLEDGE AND BELIEF ALL THE  
INFORMATION REQUIRED BY THE PENNA. DEPARTMENT OF MINES

*William Charles Herring*  
REG. SUR. NO. 5902-E

ACKNOWLEDGED BEFORE ME A \_\_\_\_\_  
THIS \_\_\_\_ DAY OF \_\_\_\_\_

"LEGEND"

- LAND BOUNDARIES OVERLYING MINE
- PERMIT BOUNDARY
- SIX MONTH MINING PROJECTION
- ABANDONED AREA

MAP SHOWING

**EDWIN PENTZ COAL MINE**  
PENN TOWNSHIP CLEARFIELD CO., PA.  
SCALE 1" = 100' JUNE 1966  
REG. SUR. NO. 5902-E W. C. HERRING  
(MNG. ENG.)

#2114  
12-30-99  
C.C.