

200 Feet of Scale
3000 ft. by 4000 ft.
1910

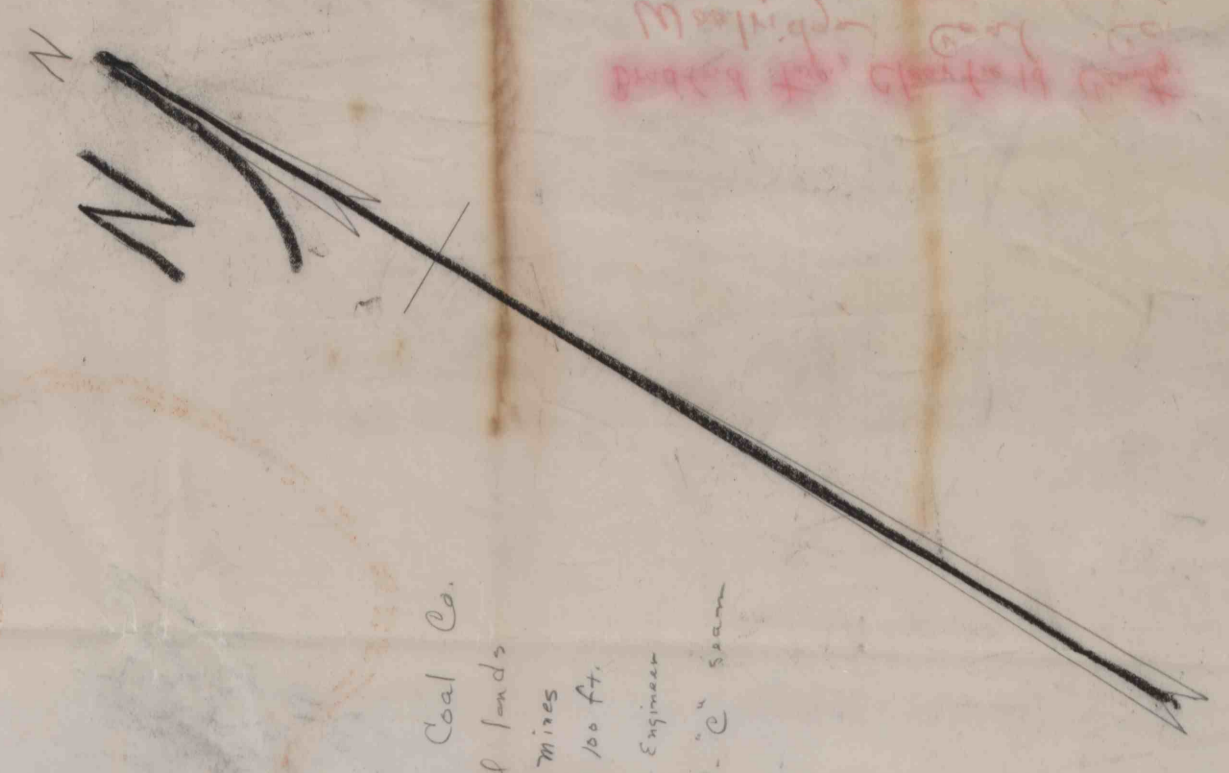

Washington Coal Co.
Map of coal lands
Orchard mines
Scale 1/2" = 100 ft.
R.C. Kinky, Engineer
36" and "C" seams

G.B. Shively heirs
A.E. Washington heirs



10"
100'

Orchard #6 mine

August Smith (Surface)

Grover Thompson (Surface)
Washington Coal Co. Orchard
Surface in 1925

A.E. Washington (Surface)

Scale: 1" = 100'

Fault

36"

1851