

GENERAL REFRACTORIES COMPANY  
 — MAP OF —  
**M<sup>c</sup>CLARREN COLLIERY N<sup>o</sup>1**  
 — SITUATED IN —  
 DECATUR TWP., CLEARFIELD CO., PA.  
 — SCALE: 1"=100' —

West Decatur, Pa.  
 January 8, 1921.

Drawn by R.J.H.  
 Traced by L.S.

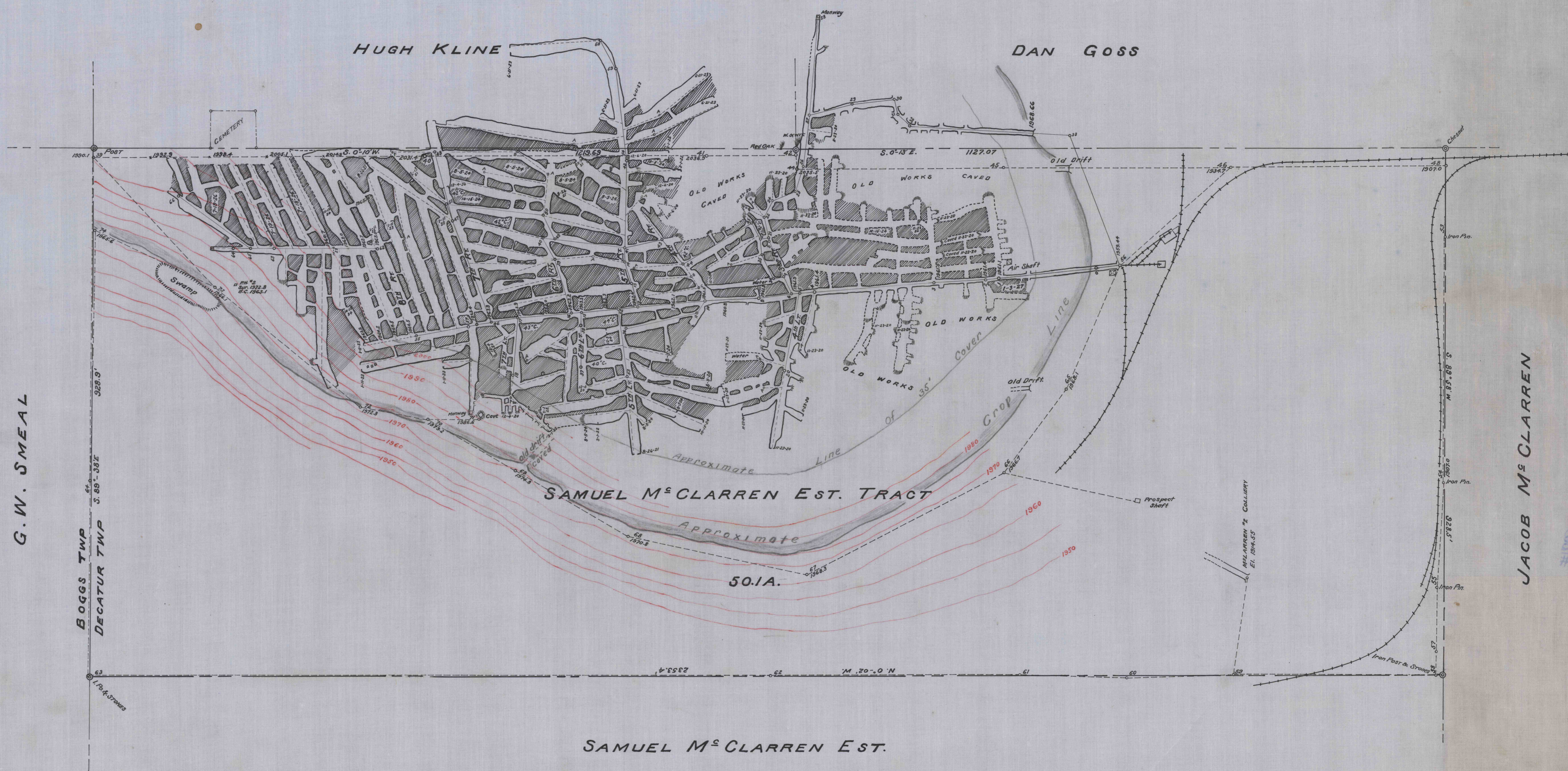

NOTE: Elevations are based on u.s.g.s. datum

SAMUEL M<sup>c</sup>CLARREN EST.