

Contours  
3-1-36

QHP  
of  
NO 3 MINE  
LOYAL HANNA C. & C. CO.  
Situated at  
Omaha, Cambria County Penna.  
1906. J. B. DILLMAN, R.O.

*Summit Hill*  
*Full P...*

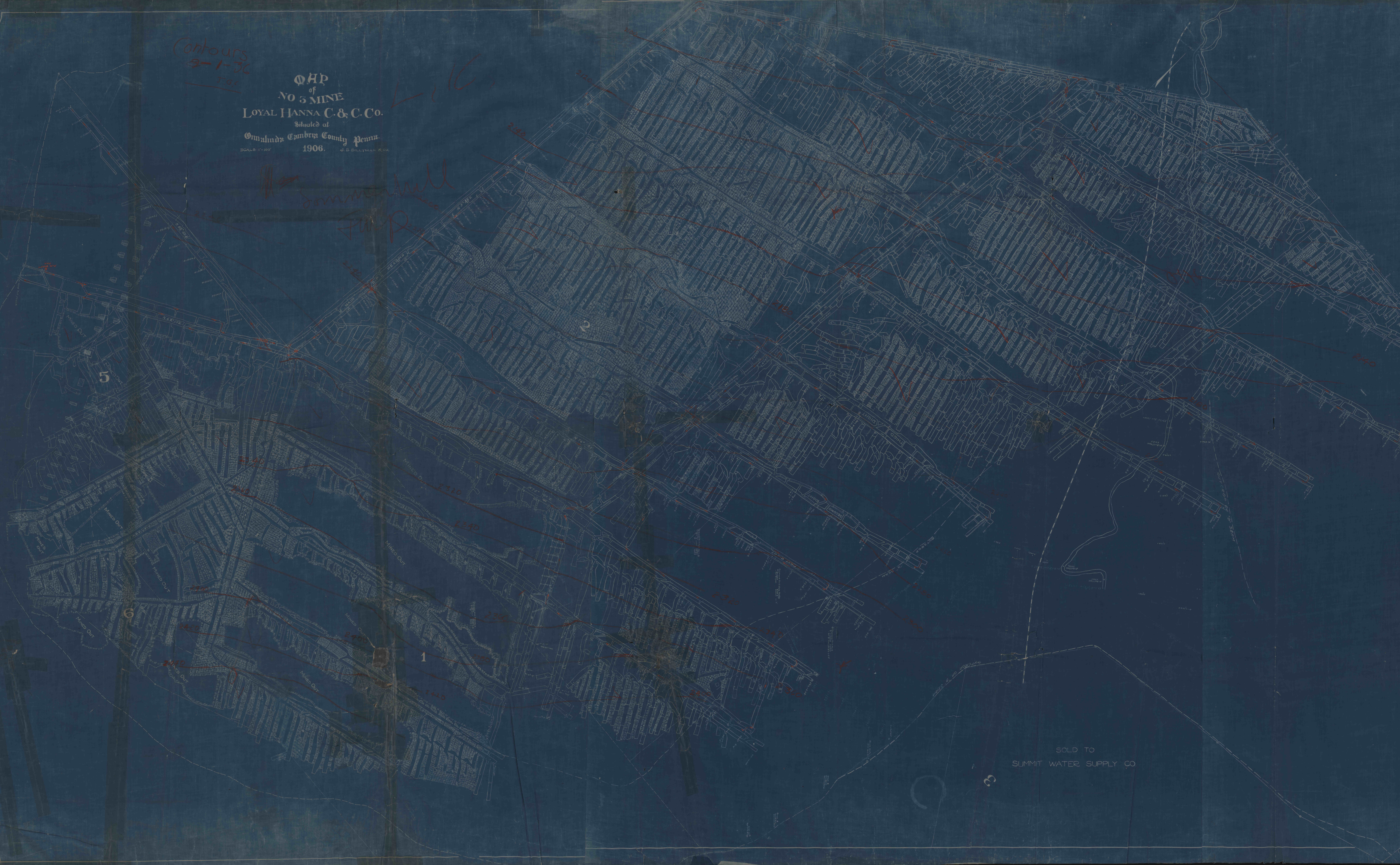

SOLD TO  
SUMMIT WATER SUPPLY CO

3