

I HEREBY CERTIFY THAT THE PRINTED MATERIAL ON THIS MAP CORRECTLY SHOWS THE MINE AND PROPERTY OF INLAND STEEL COAL COMPANY LANCASTIRE NO. 25 MINE AS OF AUGUST 1, 1985. THIS MAP SHOWS THE FINAL WORKINGS OF THE MINE PRIOR TO SEALING.

I FURTHER CERTIFY THAT THIS MAP WAS REPRODUCED UNDER MY JURISDICTION, FROM THE FIELD SURVEYS, AND THAT THE SURVEYS ON THE SURFACE AND UNDERGROUND ARE CORRECTLY COORDINATED, AND THE MAP IS CORRECT TO THE BEST OF MY KNOWLEDGE AND BELIEF.

David N. Heddes
DAVID N. HEDDES, P.E.
PROJECT ENGINEER
REGISTERED PROFESSIONAL ENGINEER OF
THE COMMONWEALTH OF PENNSYLVANIA
NO. PE-034335-E

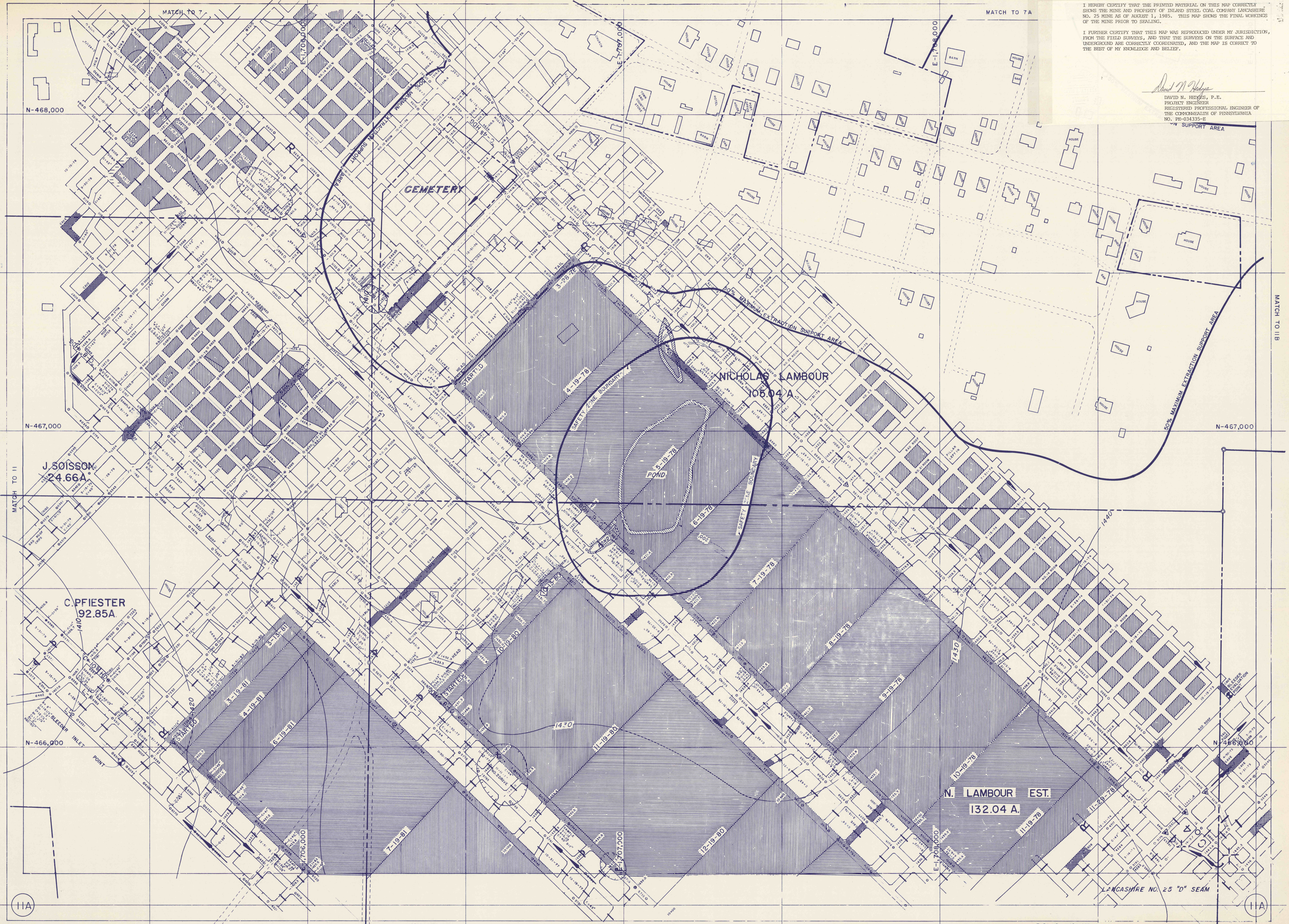

N-468,000

MATCH TO 7A

N-467,000

N-467,000

MATCH TO 11

MATCH TO 11B

N-466,000

N-466,000

11A

11A

MATCH TO 15A

MATCH TO 15 B