

MATCH TO 7C

I HEREBY CERTIFY THAT THE PRINTED MATERIAL ON THIS MAP CORRECTLY SHOWS THE MINE AND PROPERTY OF INLAND STEEL COAL COMPANY LANCASTHIRE NO. 25 MINE AS OF AUGUST 1, 1985. THIS MAP SHOWS THE FINAL WORKINGS OF THE MINE PRIOR TO SEALING.

I FURTHER CERTIFY THAT THIS MAP WAS REPRODUCED UNDER MY JURISDICTION, FROM THE FIELD SURVEYS, AND THAT THE SURVEYS ON THE SURFACE AND UNDERGROUND ARE CORRECTLY COORDINATED, AND THE MAP IS CORRECT TO THE BEST OF MY KNOWLEDGE AND BELIEF.

David N. Hedges

DAVID N. HEDGES, P.E.
PROJECT ENGINEER
REGISTERED PROFESSIONAL ENGINEER OF
THE COMMONWEALTH OF PENNSYLVANIA
NO. PE-034335-E

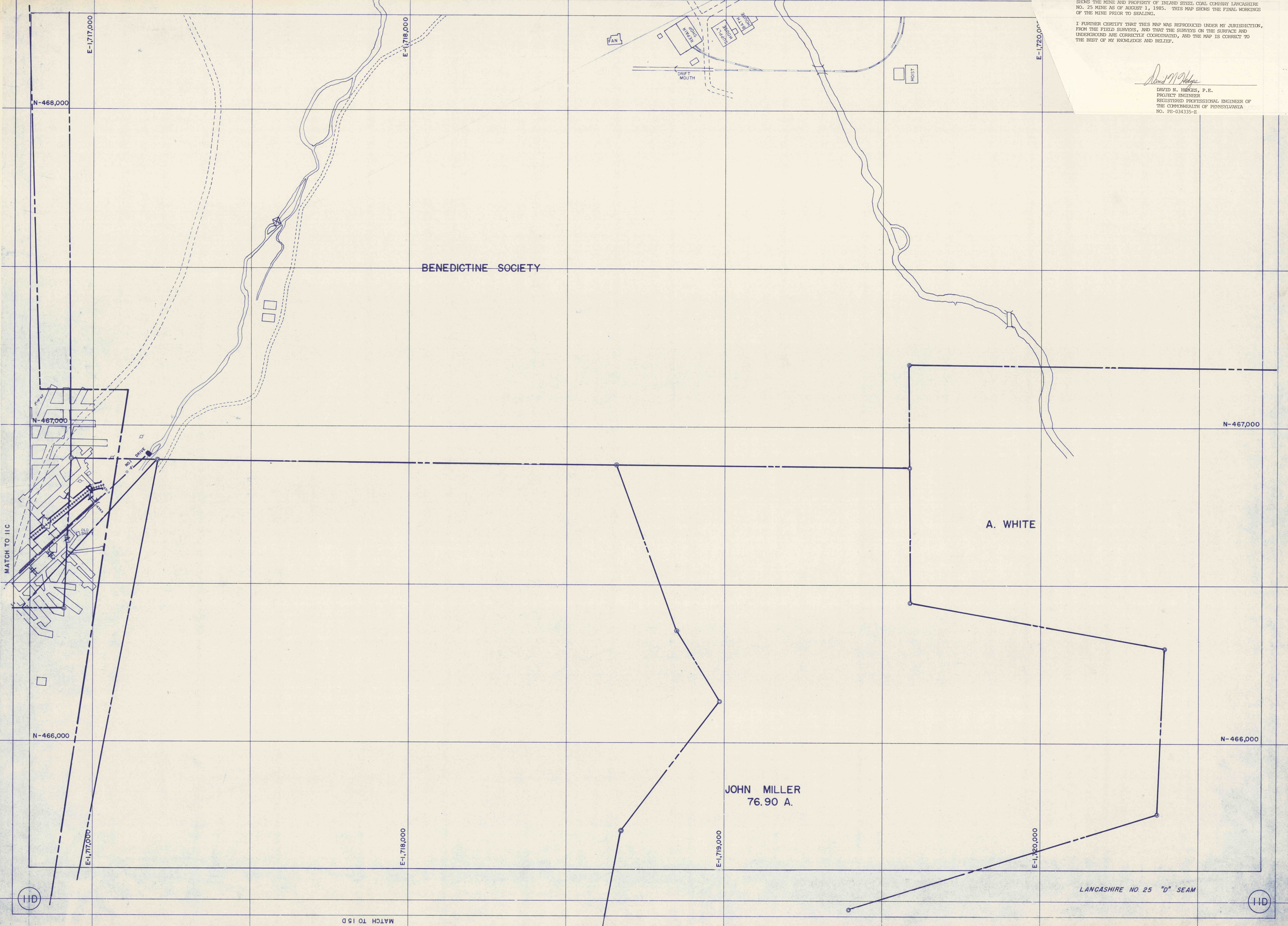

MATCH TO 11C

MATCH TO 15D

LANCASTHIRE NO. 25 "D" SEAM

11D

11D