

I HEREBY CERTIFY THAT THE PRINTED MATERIAL ON THIS MAP CORRECTLY SHOWS THE MINE AND PROPERTY OF INLAND STEEL COAL COMPANY LANCASTIRE NO. 25 MINE AS OF AUGUST 1, 1985. THIS MAP SHOWS THE FINAL WORKINGS OF THE MINE PRIOR TO SEALING.

I FURTHER CERTIFY THAT THIS MAP WAS REPRODUCED UNDER MY JURISDICTION, FROM THE FIELD SURVEYS, AND THAT THE SURVEYS ON THE SURFACE AND UNDERGROUND ARE CORRECTLY COORDINATED, AND THE MAP IS CORRECT TO THE BEST OF MY KNOWLEDGE AND BELIEF.

David N. Hedges  
DAVID N. HEDGES, P.E.  
PROJECT ENGINEER  
REGISTERED PROFESSIONAL ENGINEER OF  
THE COMMONWEALTH OF PENNSYLVANIA  
NO. PE-034335-E

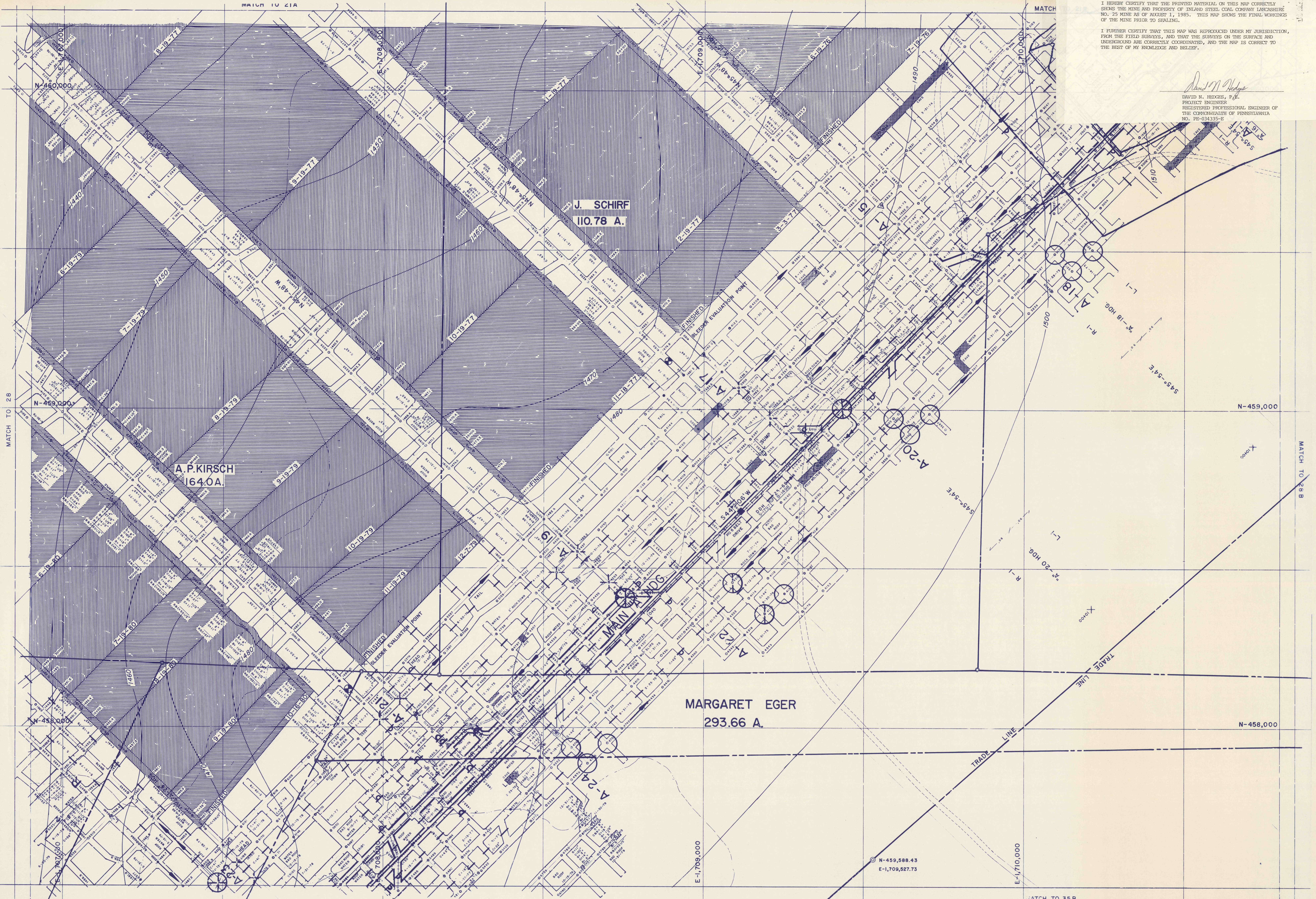

MATCH TO 28

MATCH TO 26 B

28A

28A

MATCH TO 35 A

MATCH TO 35 B

LANCASTIRE NO. 25 "D" SEAM

MARGARET EGER  
293.66 A.

A.P. KIRSCH  
164.0A

J. SCHIRF  
110.78 A.

N-459,588.43  
E-1,709,527.73

N-459,000

N-458,000

E-1,709,000

E-1,710,000