

KYLER COAL CO. #5
SHAWVILLE, PA.
MAP OF MINE
GOSHEN TWP., CLFD., CO., PA. #7
SCALE 1" = 100'
CLEARFIELD, PA. ROY C. KINDIG
OCT. 4, 1957 REG. ENGR.

A. B. SHAW EST.

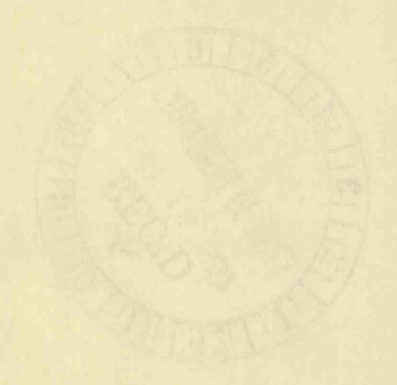

HARBISON-WALKER REF. CO.

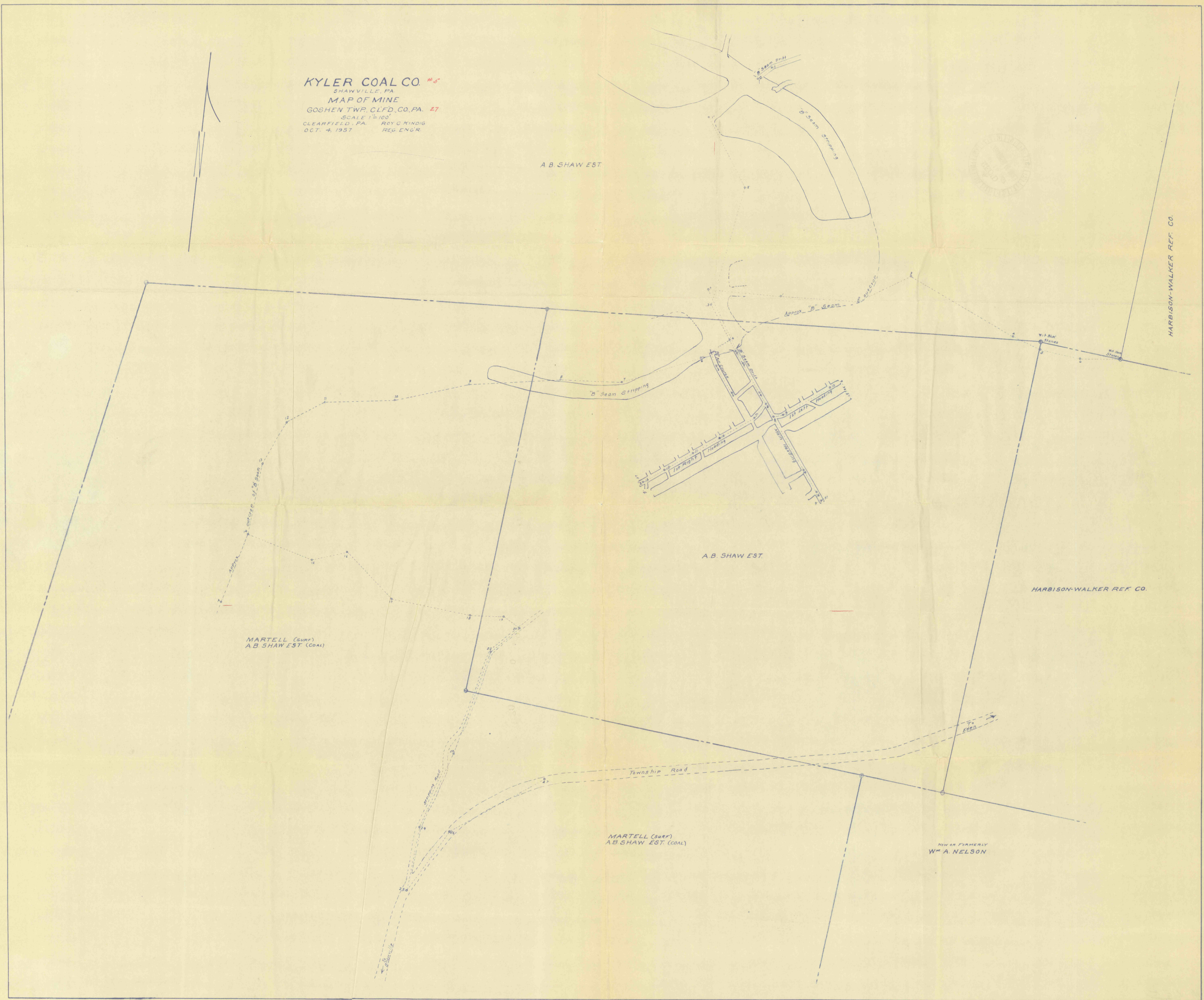

MARTELL (SURF)
A. B. SHAW EST. (COAL)

A. B. SHAW EST.

HARBISON-WALKER REF. CO.

MARTELL (SURF)
A. B. SHAW EST. (COAL)

NEW OR FORMERLY
W. A. NELSON