

54418

DIAMOND COAL CO - NOW - CHAMOUNI COAL CO

W E

ACQUIRED BY THE
CHAMOUNI COAL CO.
WASHINGTON COUNTY PA. 5-12-1927.
*Brownsville Engineering Co.
Aug. 1932.*

*I, W. C. Bowers, of the Brownsville Engineering Co., Engineers
for the Chamouni Coal Co. do hereby certify that this is
a true and correct map of the coal mined from the Knob Mine,
to the best of my knowledge and belief. (Note however that
I have made this map by tracing an old print of the M.R.C.C. & C.Co.
and by adding information secured by myself, March 1932.)*

*W. C. Bowers
Registered Engineer # 225*

State of Pennsylvania } ss.
County of Fayette }
Before me, a Notary Public, in and for the said State and County,
personally appeared W. C. Bowers, of the Brownsville Engineering Co., Engineers
for the Chamouni Coal Co. who being duly sworn, according to law, deposes
and says that the foregoing statement is true and correct to the best of
his knowledge and belief.
Sworn and subscribed to before me a Notary Public this 4th day of
August 1932.

*Martin G. Hess
Notary Public*

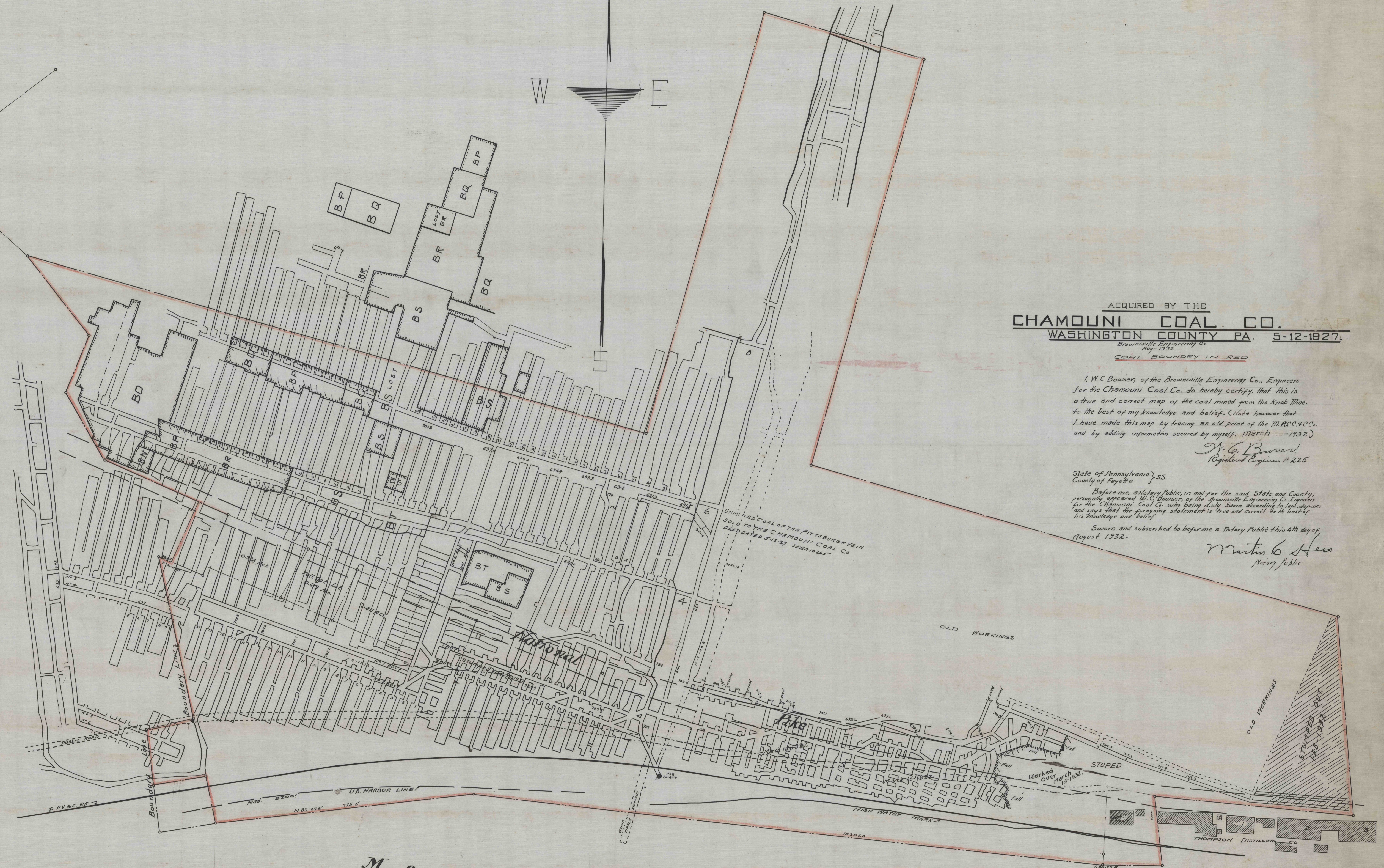

Monongahela River

NOB MINE
RIVER SECTION
Scale 1"=100' Jan 1911.

M.R.C.C. & C.Co.
Abandoned April 14 1932.
Last survey March 15 1932
W. C. Bowers