

#1456
8-12-99
cc

DEEP MINE PROPERTY MAP
KELLY MINE OF KENNETH B. SHAW COAL CO.
CAMBRIA COUNTY
JACKSON TOWNSHIP
SCALE 1" = 100'
JULY 10, 1967
MAP PREPARED BY JOHN C. WAGNER

NOTE: HATCHED BLOCKS DENOTE SOME
SECOND MINING NOT NECESSARILY
COMPLETE EXTRACTION.
SUBSIDENCE BOUNDARY

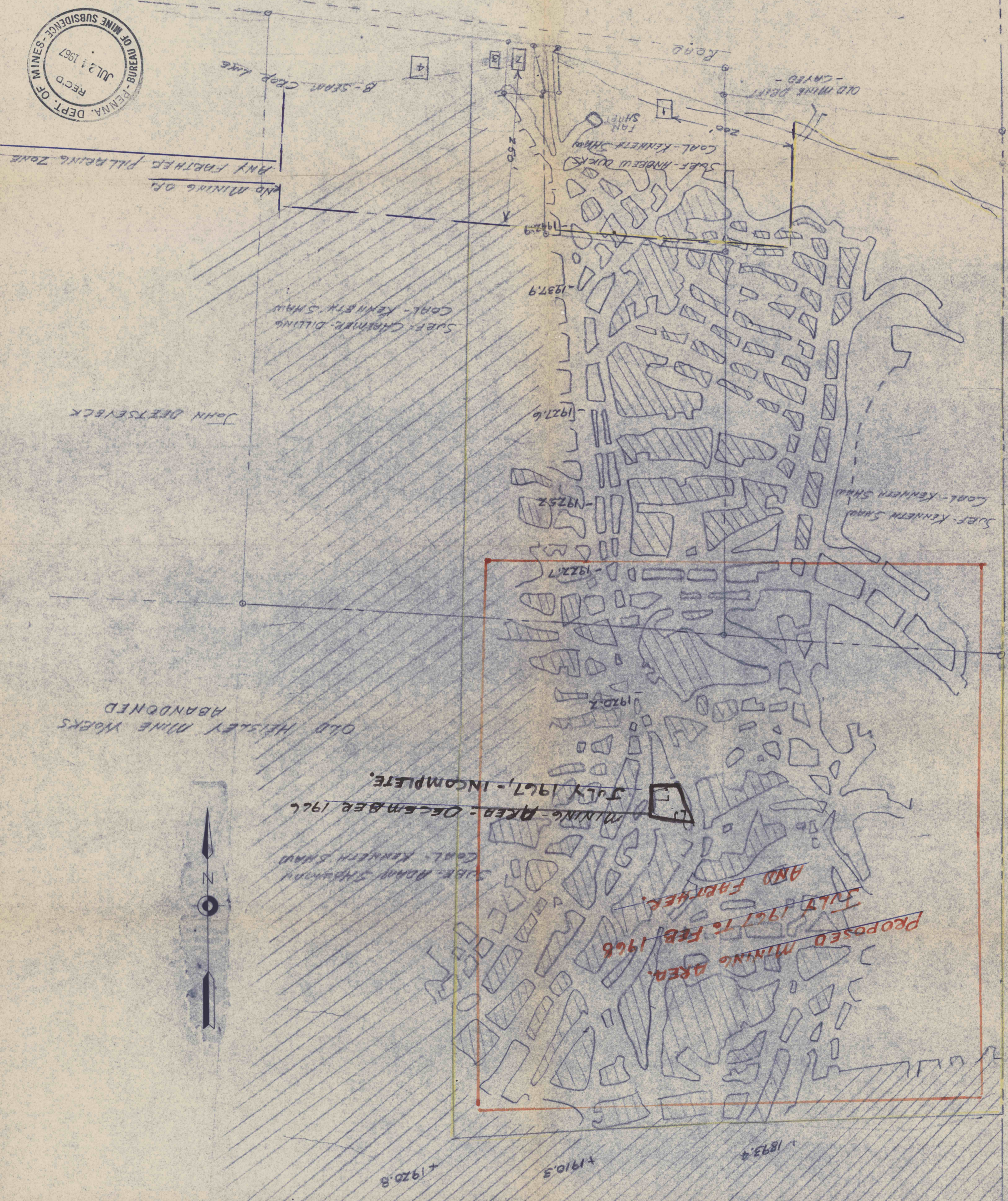
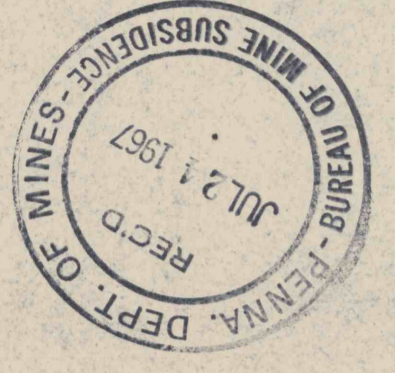

THOMAS DAVIS

Solomon WAGNER

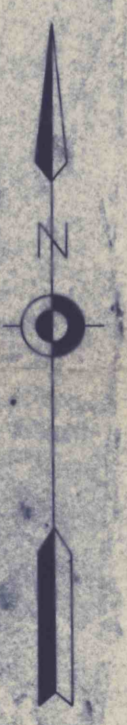

OLD HEISLEY MINE WORKS
ABANDONED

JOHN DEITSEBECK

NO MINING OF
ANY FURTHER PILLARING ZONE

B-SEAM CRIP LANE

SURF. CHAMBER-DILLING
COAL-KENNETH SHAW

SURF. HARBELW DUCKS
COAL-KENNETH SHAW

FAN
SHAFT

COAL-KENNETH SHAW

OLD MINE DEPT
-CAYE-

Range

MINING - FEB - DECEMBER 1966
JULY 1967, - INCOMPLETE.

Proposed Mining Area,
JULY 1961 TO FEB. 1966
AND FURTHER.