

Note - Natural Drainage Thru Cymbria old workings To Walnut Run

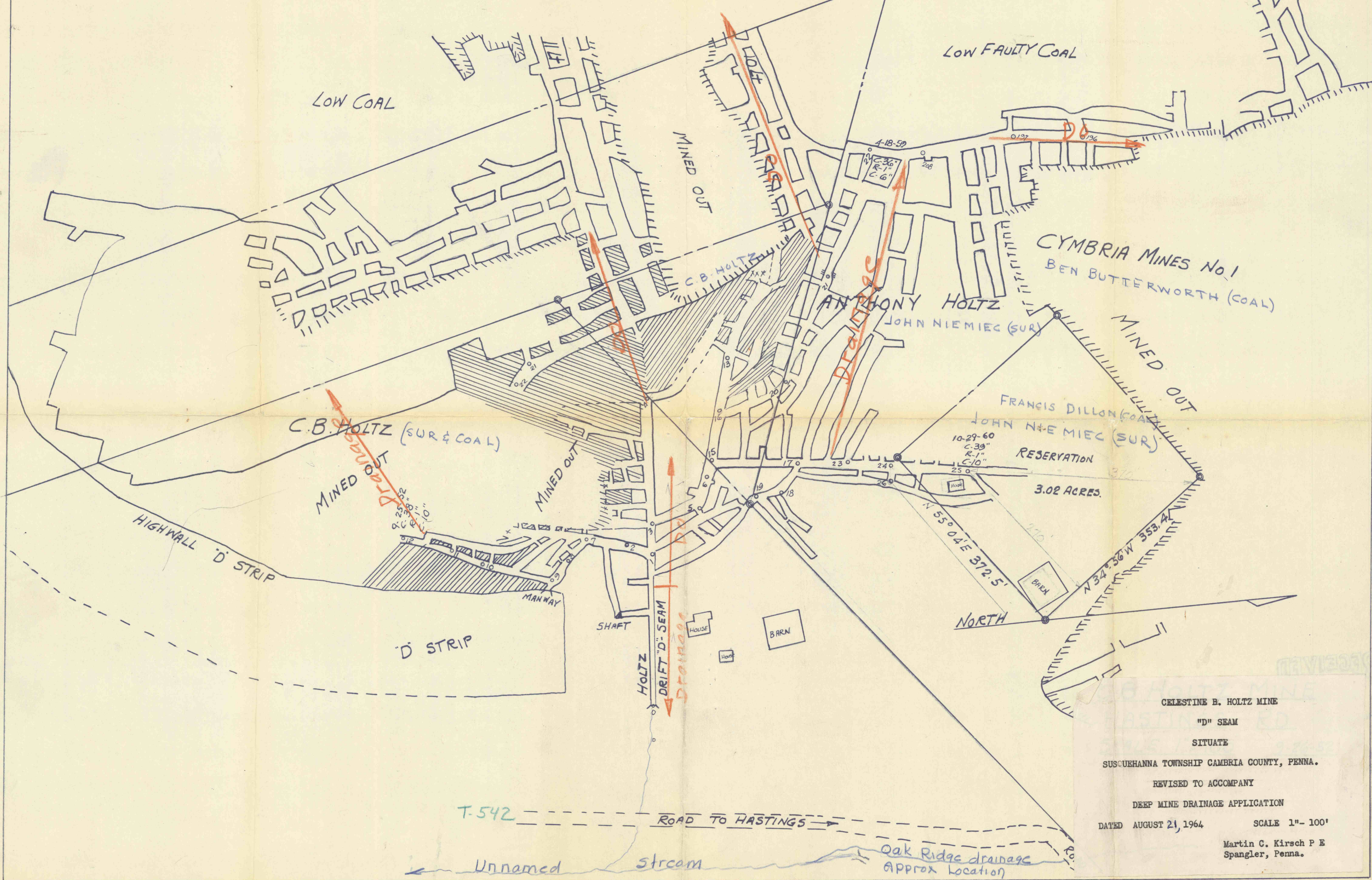

CELESTINE B. HOLTZ MINE
 "D" SEAM
 SITUATE
 SUSQUEHANNA TOWNSHIP CAMBRIA COUNTY, PENNA.
 REVISED TO ACCOMPANY
 DEEP MINE DRAINAGE APPLICATION
 DATED AUGUST 21, 1964 SCALE 1" = 100'
 Martin C. Kirsch P E
 Spangler, Penna.