

FREEBROOK CORPORATION

WILLIAM GEIST

RAY KUNSELMAN

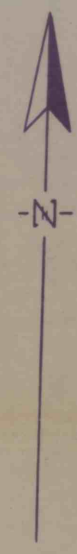
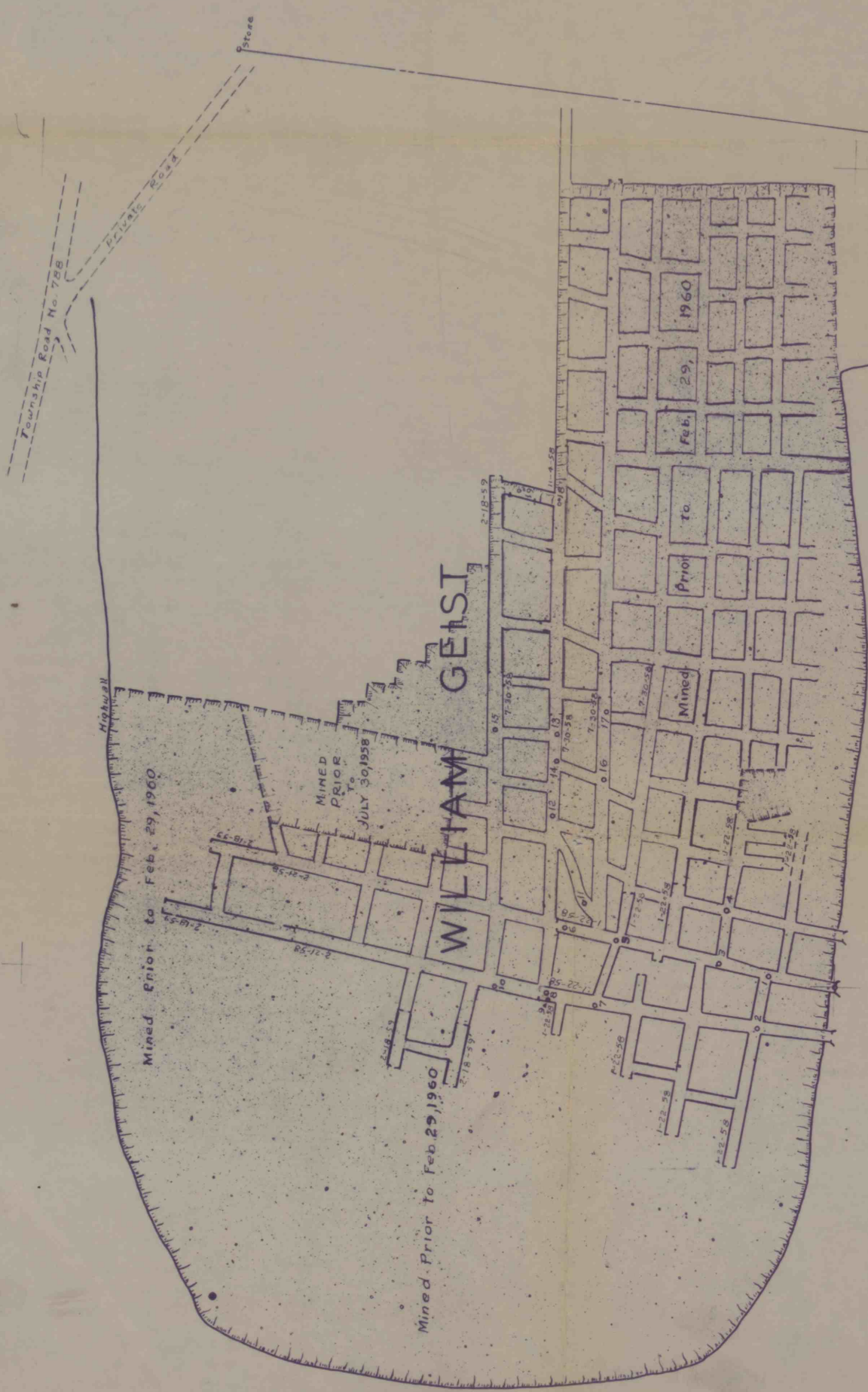

MINE MAP
HARMON COAL CO.
 COAL MINE

REDBANK TOWNSHIP, ARMSTRONG COUNTY, PENNA.
 SCALE 1" = 100'
 WALTER J. ZIMMERMAN SURVEYOR ENGINEER PUNXSUTAWNEY, PA.

DATE OF SURVEY

JAN.	22,	1958
FEB.	21,	1958
JULY	30,	1958
NOV.	4,	1958
FEB.	18,	1959
FEB.	29,	1960

Handwritten note: 7/30/58
 1960