

- LEGEND**
- REVISED MINE SUBSIDENCE PERMIT
 - PROTECTED STRUCTURES
 - UNPROTECTED STRUCTURES
 - REMAINING COAL PILLARS
 - STRUCTURE WITH AGREEMENT
 - SURVEY STATION
 - LOWER FREEPORT COAL OUTCROP
 - CONTEMPLATED MINING THRU
 - ACTIVE GAS WELL

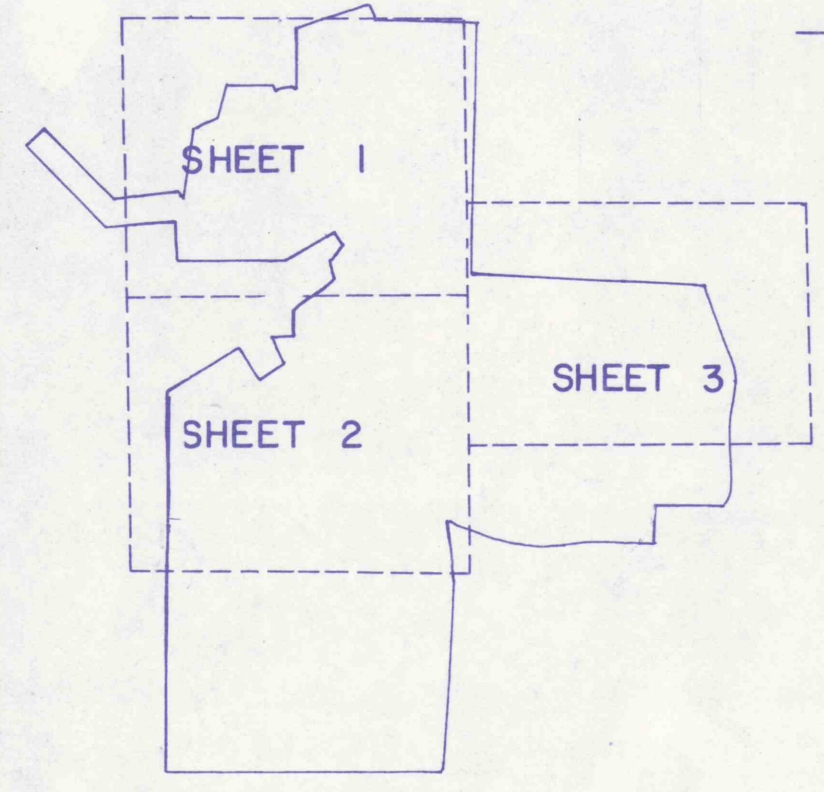

RICHARD E. & EVELYN McDIVITT - S
FRANK STOCKDALE - M

E 498407

E 498307

E 497407

E 497907

E 498407

E 498907

MATCH LINE A-A

VAPCO ENGINEERING
PUNXSUTAWNEY, PENNSYLVANIA

BY: BL
DRAWN BY: RH
CHECKED BY: SH
DATE: APRIL 1984
REVISIONS: 3 - 21 - 86
12-22-86

1. I hereby certify that the data and content of this report were prepared or checked by me or under my direct supervision by a duly qualified and licensed Professional Engineer in the State of Pennsylvania.

DATE: 12-22-86
FILE NO.

APPROVED: [Signature]
DATE: 12-22-86
REG. NO. 25746-C

NOTE: Mine site locations & elevations provided by survey of Plateau Corporation & GR Mining Company.

EXISTING DEEP MINE LOWER FREEPORT COAL SEAM
GR MINING COMPANY
FAIRVIEW NO. 5 DEEP MINE
Porter & Perry Twp. Jefferson Co.

SHEET 1 OF 3

FINAL CLOSURE EXTENT

500' BY 600' RESERVATION FORMERLY LOCATED HERE RELEASED FOR MINING BY ARTICLE OF AGREEMENT AND COAL LEASE SUBMITTED FEB. 8, 1984. SURFACE OWNED BY P.M. KENNEDY COAL RIGHTS - DEBORAH TODD HUNTER