

#2106
7-16-99
CC

EXHIBIT -A-
Owned by Bowman Brothers Company.

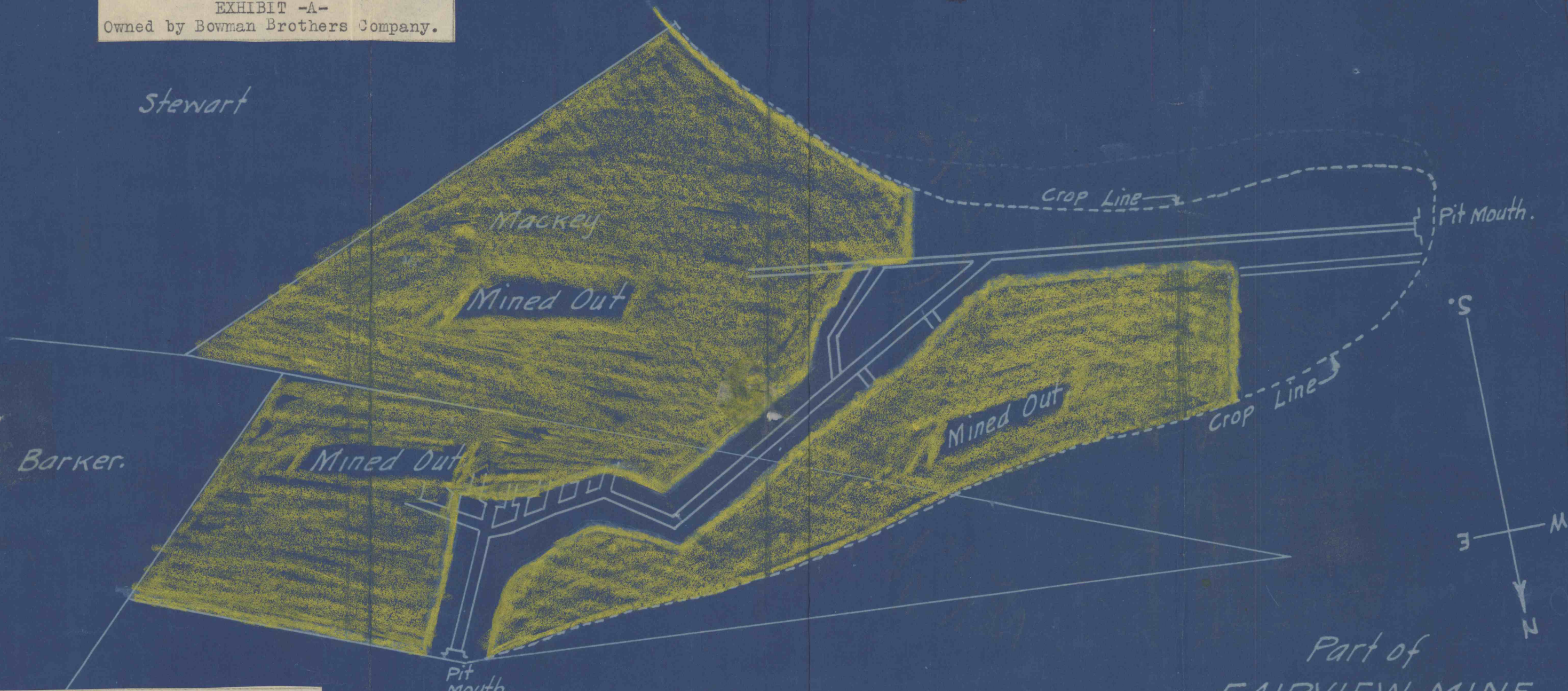

EQUIPMENT	
12 Ton T Rail -----	\$ 360.00
12 Mule Wagons -----	360.00
1 Mule Stable -----	100.00
2 Mules -----	200.00
1 Blacksmith shop -----	100.00
1 Tipple -----	1000.00
Office & Wagon scales --	500.00
Tool & etc. -----	300.00
	\$2920.00

Coal area not assessed.

Naysmith. Pittsburg Coal 5'-9" Thick

Part of
FAIRVIEW MINE.
Owned by Bowman Bros. Co.
Situate in North Versailles Twp.
Allegheny Co. Pa.
Scale 1" = 100' July 1920 R.C. Bayne Eng.